



FAIRDEAL HARDWARE TRADING LLC

We are a trusted wholesaler and supplier of premium Fasteners & Hardware in Dubai, UAE. Our wide range of high-quality fasteners is designed to meet the demands of construction, automotive, and industrial applications, ensuring strength, durability, and reliability in every project.

ABOUT US



Our Mission

At Fairdeal Hardware Trading L.L.C, our mission is to deliver high-quality, reliable, and cost-effective fastening solutions that empower construction, automotive, marine, and industrial sectors across the UAE. We are committed to excellence, timely service, and building long-term trust with our clients by ensuring every product meets the highest standards of durability and performance.

Our Vision

Our vision is to be recognized as the leading and most trusted supplier of fasteners and industrial hardware in the region, known for innovation, reliability, and customer-first service. We aim to expand our product range, embrace global standards, and continue fastening the future with quality and trust.

Why Choose FAIRDEAL TRADING LLC?

- 25 years of experience in fasteners and hardware
- Comprehensive product range to meet diverse industry needs
- Commitment to quality and reliability in every product supplied
- Trusted by contractors, engineers, and industries across the UAE



We believe in building long-term partnerships by delivering not just products, but also trust, reliability, and value with every order.

FAIRDEAL HARDWARE TRADING LLC

Table of Contents

»»» About Us	—————>	Page 03
»»» Bolts	—————>	Page 04
»»» Nuts	—————>	Page 11
»»» High tensile fasteners	—————>	Page 15
»»» Washers	—————>	Page 16
»»» Anchors	—————>	Page 20
»»» Bent Bolts & Foundation Anchors	—————>	Page 26
»»» Screws	—————>	Page 27
»»» Riggings	—————>	Page 29
»»» Pipe Clamps	—————>	Page 32
»»» Strut Channel & Accessories	—————>	Page 35
»»» Rivets & Pins	—————>	Page 37
»»» Scaffoldings	—————>	Page 39
»»» PVC Caps & Nylon Anchors	—————>	Page 43
»»» Fencing Accessories	—————>	Page 45
»»» Contact Us	—————>	Page 48

BOLTS



***Fasten
with
Precision***



BOLTS

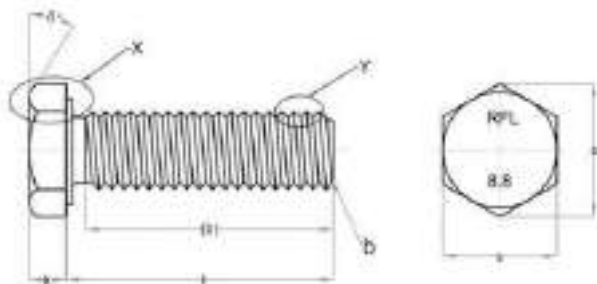

ITEM NAME	HEX BOLT FULL THREAD
STANDARD	DIN 933
FINISH	WZP/BLACK/YZP/HDG
GRADE	Gr4.8/Gr8.8/Gr10.9/SS 304 /SS 316
SIZE RANGE	M4 TO M36

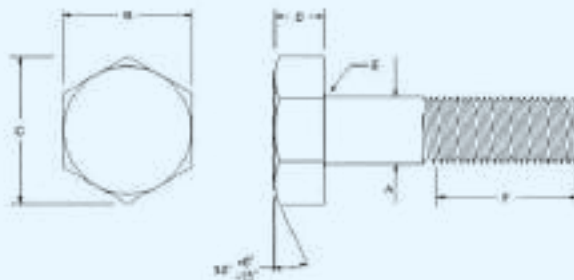

ITEM NAME	HEX BOLT HALF THREAD
STANDARD	DIN 931
FINISH	WZP/BLACK/YZP/HDG
GRADE	A490/A325/UNC Gr5/Gr8.8/Gr10.9
SIZE RANGE	M8 TO M42, 3/8" - 1"

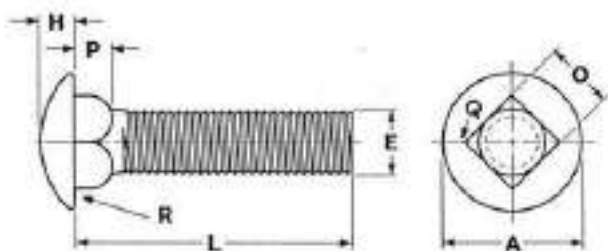

ITEM NAME	CARRIAGE BOLT FULL THREAD
STANDARD	DIN 603
FINISH	WZP / SS
GRADE	Gr4.8/SS 304 (A2)/SS 316 (A4)/8.8
SIZE RANGE	M6 TO M20

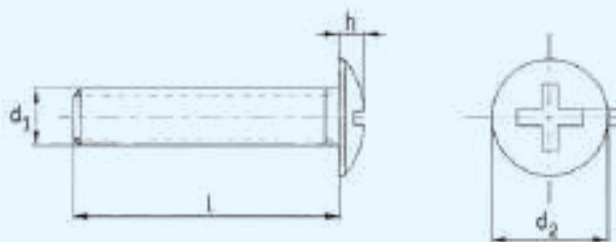

ITEM NAME	ROOFING BOLT
STANDARD	—
FINISH	WZP/SS
GRADE	Gr4.8/SS 304/SS 316
SIZE RANGE	M6 TO M12

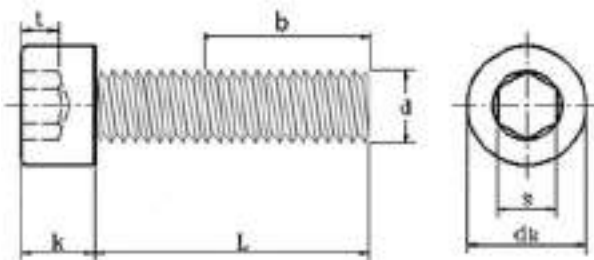

ITEM NAME	CAP ALLEN BOLT
STANDARD	DIN 912
FINISH	BLACK / SS
GRADE	10.9/12.9/SS 304/SS 316
SIZE RANGE	M4 TO M24

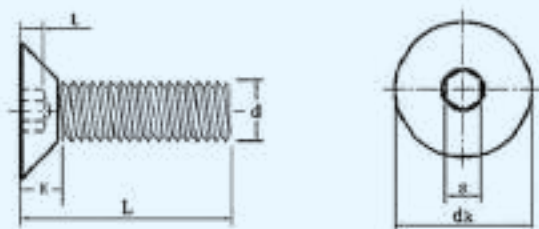

ITEM NAME	CSK ALLEN BOLT
STANDARD	DIN 7991
FINISH	BLACK/SS
GRADE	8.8/10.9/SS 304/SS 316
SIZE RANGE	M3 to M24

BOLTS

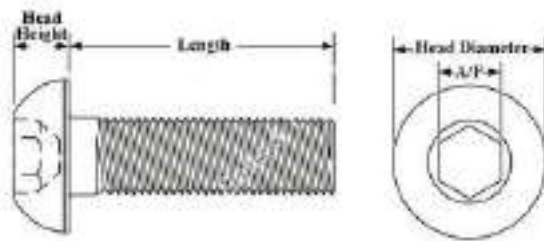

ITEM NAME	BUTTON ALLEN BOLT
STANDARD	DIN 7380 BLACK
FINISH	BLACK or SS
GRADE	8.8/10.9/SS 304/SS 316
SIZE RANGE	M4 TO M12

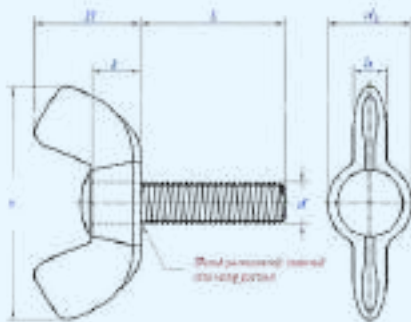

ITEM NAME	WING BOLT
STANDARD	DIN 316
FINISH	WZP/SS
GRADE	Gr4.8/SS-304
SIZE RANGE	M6 TO M12

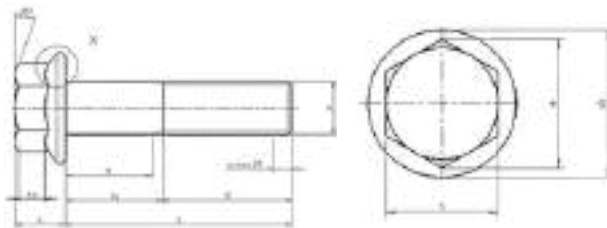

ITEM NAME	FLANGE WASHER BOLT
STANDARD	DIN 6921
FINISH	WZP / SS
GRADE	Gr4.8/88/SS A2-A4
SIZE RANGE	M6 TO M12

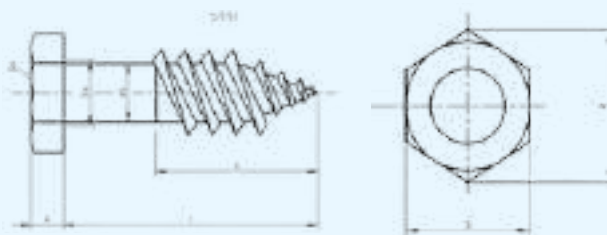

ITEM NAME	HEX HD COACH SCREW
STANDARD	DIN 571
FINISH	WZP/SS
GRADE	Gr4.8/SS 304/SS 316
SIZE RANGE	M6 TO M16

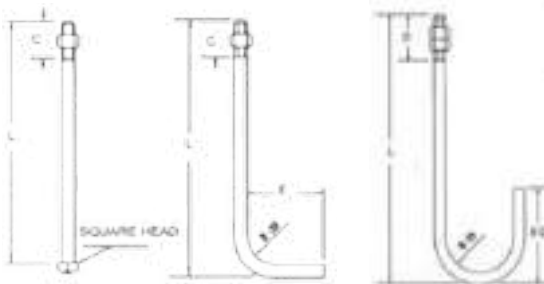

ITEM NAME	FOUNDATION ANCHORS J-TYPE/L TYPE/STRAIGHT TYPE
STANDARD	ASTM F1554
FINISH	WZP/BLACK/HDG/SS
GRADE	Gr4.8/8.8/10.9/SS 304/316 F1544 Gr105/ASTM A572 Gr50 S355 JR
SIZE RANGE	M6 TO M52

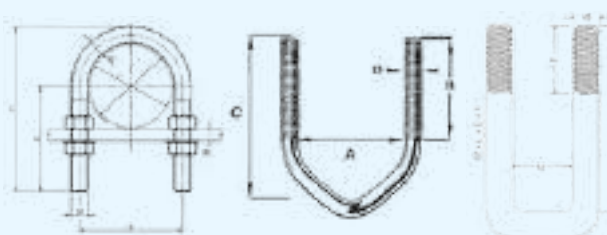

ITEM NAME	U TYPE/SQUARE TYPE/ V TYPE BOLTS
STANDARD	DIN 3570/3057
FINISH	WZP/BLACK/HDG/SS
GRADE	Gr4.8/Gr8.8/SS 304 /SS 316
SIZE RANGE	M6 TO M36

BOLTS

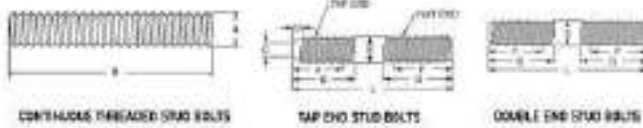

ITEM NAME	STUD BOLTS
STANDARD	DIN 938/DIN 939/DIN 976/ DIN 925/DIN 935/ISO 7412
FINISH	WZP/BLACK/HDG/SS
GRADE	Gr4.8/Gr8.8/Gr10.9/SS 304/SS 316/B7
SIZE RANGE	M6 TO M52, 1/2" to 2"

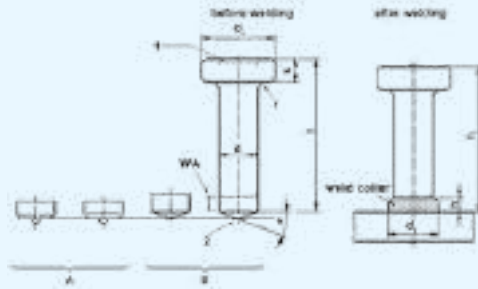

ITEM NAME	SHEAR STUD WITH CERAMIC FERRULE
STANDARD	ISO 13918
FINISH	BLACK
GRADE	—
SIZE RANGE	13-25MM UPTO 250MM LONG

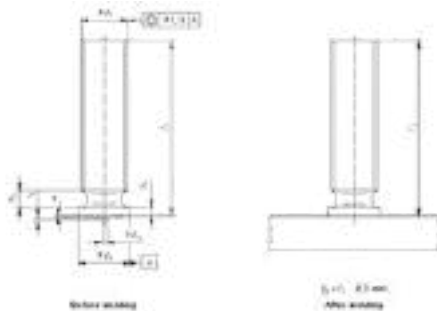

ITEM NAME	COPER/ALUMINIUM WELDING STUD
STANDARD	—
FINISH	COPPER
GRADE	—
SIZE RANGE	M6x16, M6x20

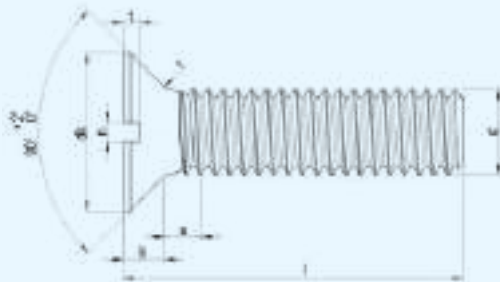

ITEM NAME	CSK SLOT MACHINE SCREW
STANDARD	DIN 963/965
FINISH	WZP/NICKLE PLATED/SS
GRADE	Gr4.8/SS 304/SS 316
SIZE RANGE	M3.5 TO M16

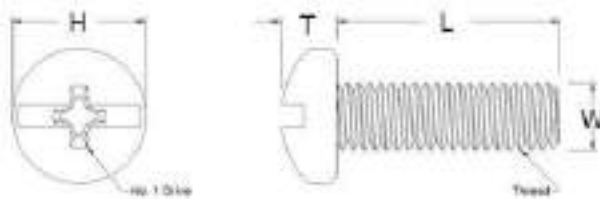

ITEM NAME	PAN HEAD STAR MACHINE SCREW
STANDARD	DIN 7985
FINISH	WZP/SS
GRADE	Gr4.8/SS 304/SS 316
SIZE RANGE	M4 TO M8

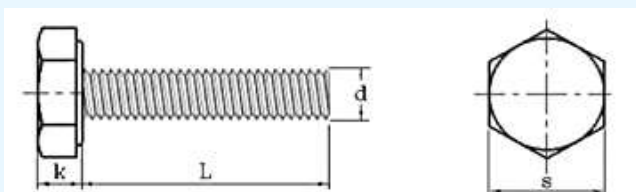

ITEM NAME	BRASS BOLT
STANDARD	DIN 933
FINISH	BRASS
GRADE	—
SIZE RANGE	M6 TO M16

BOLTS

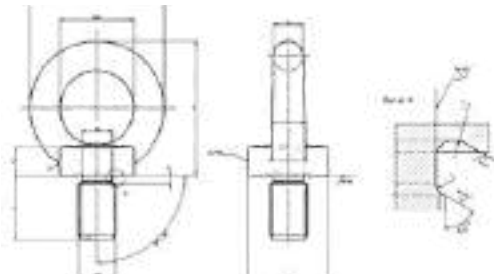

ITEM NAME	LIFTING EYE BOLT
STANDARD	DIN 580, LONG THREAD
FINISH	WZP/HDG
GRADE	—
SIZE RANGE	M6-M30

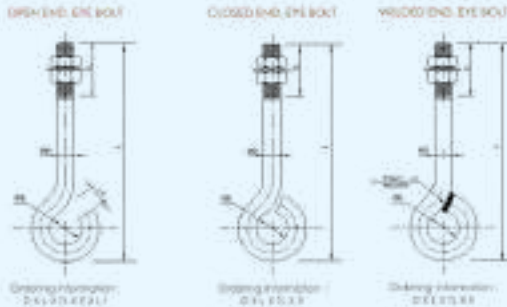

ITEM NAME	EYE BOLT/OPEN HOOK BOLT/CLOSE EYE BOLT
STANDARD	—
FINISH	WZP/HDG/SS
GRADE	Gr4.8/8.8/10.9/SS 304/SS 316
SIZE RANGE	M6-M24

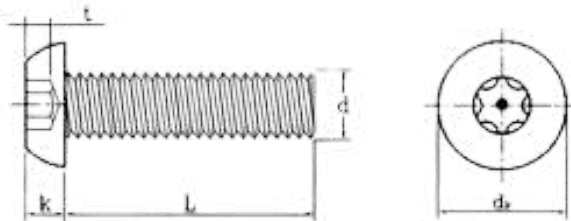

ITEM NAME	ANTI THEFT BOLT
STANDARD	DIN 603
FINISH	WZP
GRADE	SS 304/SS 316
SIZE RANGE	M6-M8

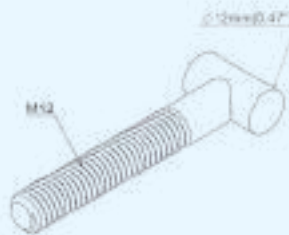

ITEM NAME	T BOLT FOR SCAFFOLDING
STANDARD	—
FINISH	WZP
GRADE	—
SIZE RANGE	M12 x 85

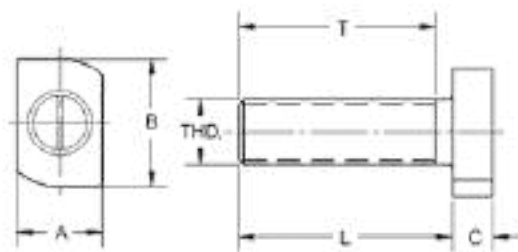

ITEM NAME	T BOLT FOR CHANNEL
STANDARD	DIN261 / DIN787
FINISH	GI / SS
GRADE	—
SIZE RANGE	M6 - M12

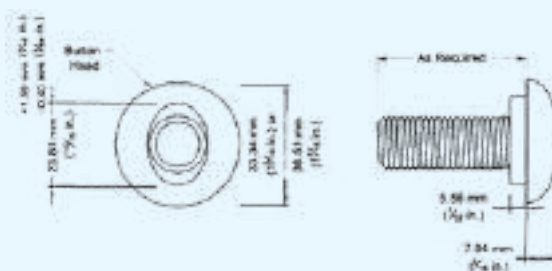

ITEM NAME	GUARD RAIL BOLT
STANDARD	BUTTON HEAD
FINISH	WZP/HDG
GRADE	Gr 8.8 / CL 10 / R436
SIZE RANGE	M 16 x35 / 16 x 50

BOLTS

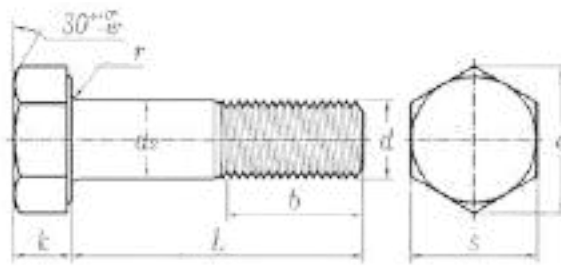

ITEM NAME	HEAVY STRUCTURAL BOLTS
STANDARD	DIN 931/933
FINISH	WZP/BLACK/HDG
GRADE	A325/A490
SIZE RANGE	M12 - M36

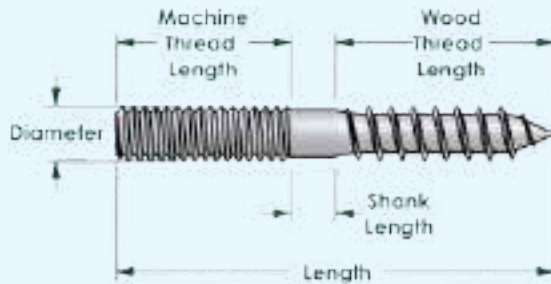

ITEM NAME	HANGER BOLTS
STANDARD	EN ISO 10664 Star Drive
FINISH	WZP
GRADE	Gr4.8
SIZE RANGE	M6 - M10

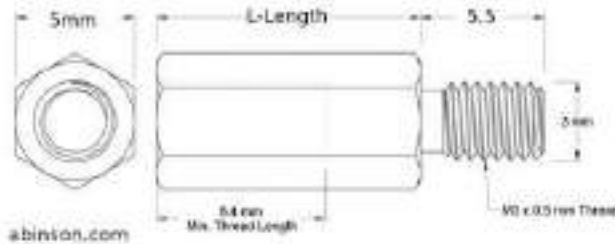
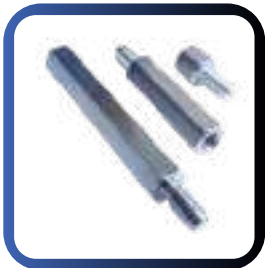

ITEM NAME	SPACER BOLT
STANDARD	DIN 17660
FINISH	WZP/YZP
GRADE	—
SIZE RANGE	M6 x 8 x 10 - 100mm

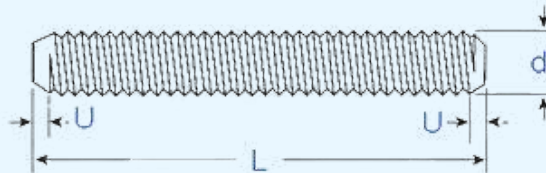
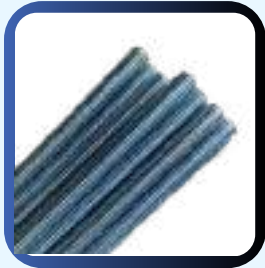

ITEM NAME	THREADED RODS
STANDARD	DIN 975
FINISH	WZP/BLACK/YZP/HDG/SS
GRADE	Gr4.8/8.8/10.9/SS 304/316 B7
SIZE RANGE	M6 - M45 1/2" - 2"



ITEM NAME	SAG RODS
STANDARD	DIN 975
FINISH	WZP/BLACK/YZP/HDG
GRADE	Gr4.8/8.8/10.9/SS 304/316
SIZE RANGE	M10 - M24

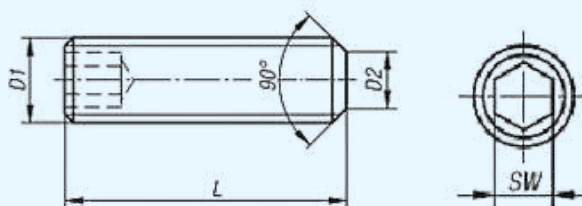

ITEM NAME	GRUB SCREW
STANDARD	DIN 916
FINISH	WZP/SS
GRADE	Gr4.8/10.9/SS 304/316
SIZE RANGE	M6 - M10

BOLTS

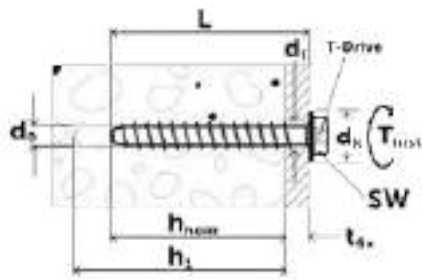

ITEM NAME	CONCRETE BOLTS
STANDARD	—
FINISH	WZP/DACROMET
GRADE	—
SIZE RANGE	M6 - M16

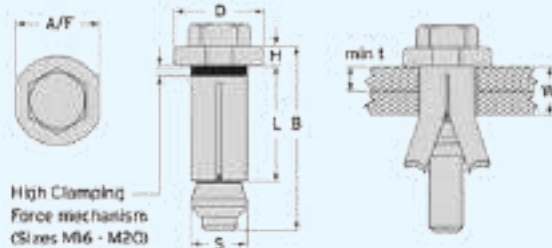

ITEM NAME	HOLLOW BOLT
STANDARD	DIN 18800
FINISH	WZP/HDG
GRADE	Gr 8.8
SIZE RANGE	M8 - M20

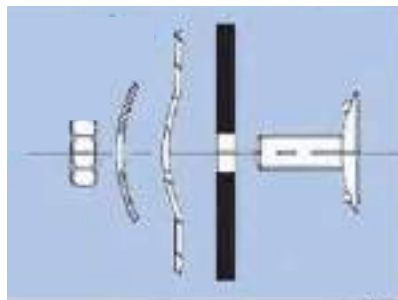

ITEM NAME	BELT FASTENER
STANDARD	DIN 15237
FINISH	Black
GRADE	Gr 4.6
SIZE RANGE	M6 - M10

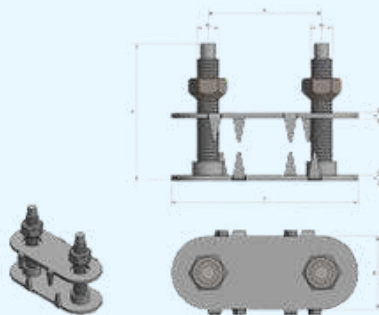

ITEM NAME	CONVEYOR BELT FASTNER
STANDARD	—
FINISH	WZP
GRADE	Gr 4.6/8.8
SIZE RANGE	M6 - M10 1" - 2.5"

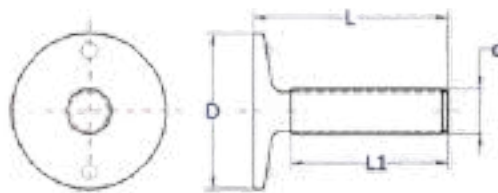

ITEM NAME	EURO/ELEVATOR BOLT
STANDARD	DIN 15237
FINISH	WZP
GRADE	Gr 4.6/8.8
SIZE RANGE	M6 - M12

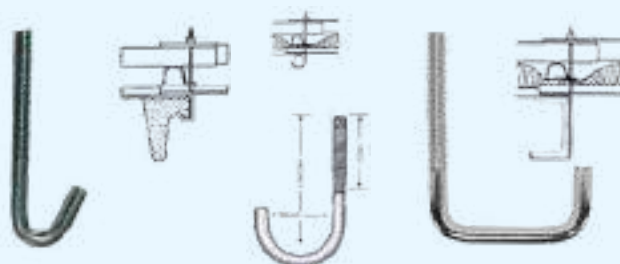

ITEM NAME	Roofing Pipe/Channel/ Angle Hook
STANDARD	-
FINISH	WZP/SS
GRADE	Gr4.8
SIZE RANGE	M6 - M10 x 1.5" to 4"

NUTS



***Fasten
with
Precision***



NUTS

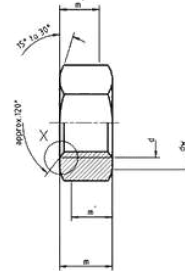
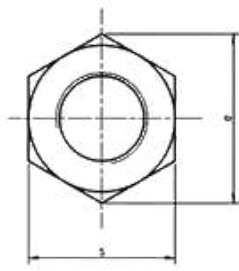

ITEM NAME	HEX NUT
STANDARD	DIN 934
FINISH	Black/WZP/HDG/SS
GRADE	Gr 4.8/8.8/10.9/A2/A4
SIZE RANGE	M4 - M64

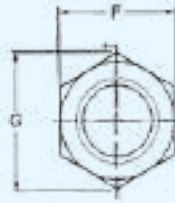
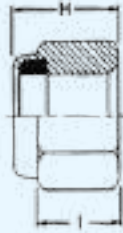
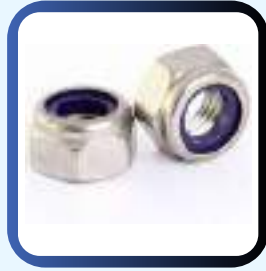

ITEM NAME	NYLOCK NUT
STANDARD	DIN 985
FINISH	WZP/SS
GRADE	Gr 4.8/A2/A4
SIZE RANGE	M4 - M36

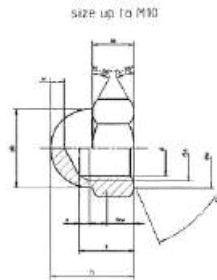
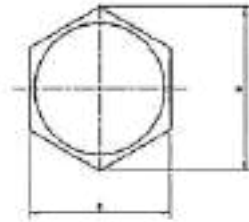

ITEM NAME	DOME/CAP NUT
STANDARD	DIN 1587
FINISH	WZP/SS
GRADE	Gr 4.8/A2/A4
SIZE RANGE	M4 - M30

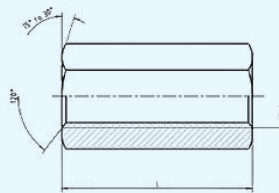
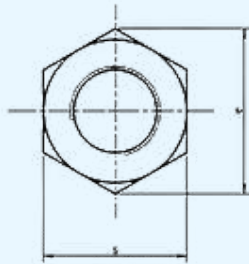

ITEM NAME	COUPLING/LONG NUT
STANDARD	DIN 6334
FINISH	WZP/SS
GRADE	Gr 4.8/A2/A4
SIZE RANGE	M6 - M30

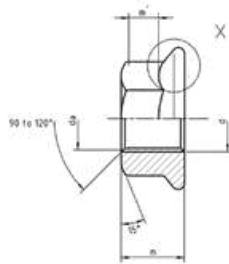
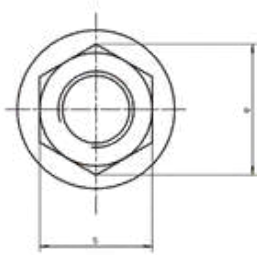

ITEM NAME	FLANGE NUT
STANDARD	DIN 6923
FINISH	WZP/SS
GRADE	Gr 4.8/A2/A4
SIZE RANGE	M6 - M16

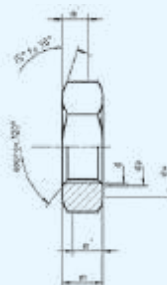
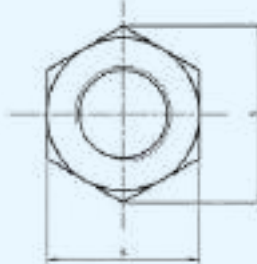

ITEM NAME	THIN/CHECK NUT
STANDARD	DIN 936
FINISH	WZP/SS
GRADE	Gr 4.8/A2/A4
SIZE RANGE	M8 - M24

NUTS

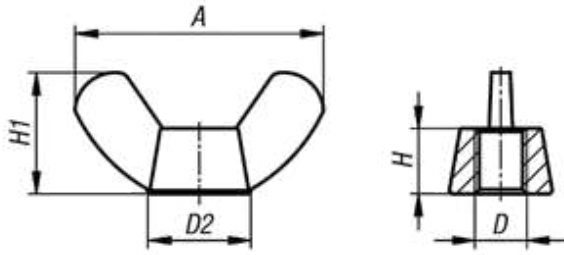

ITEM NAME	WING NUT
STANDARD	DIN 315
FINISH	WZP/SS
GRADE	Gr 4.8/A2/A4
SIZE RANGE	M6 - M16

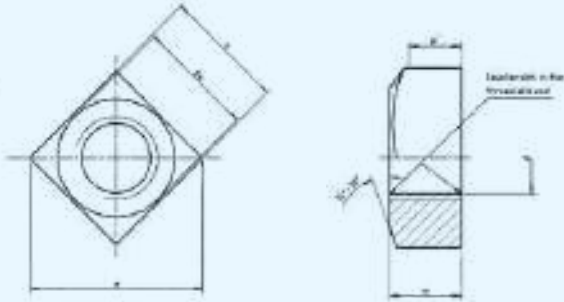

ITEM NAME	SQUARE NUT
STANDARD	DIN 557
FINISH	WZP/SS
GRADE	Gr 4.8/A2/A4
SIZE RANGE	M6 - M12

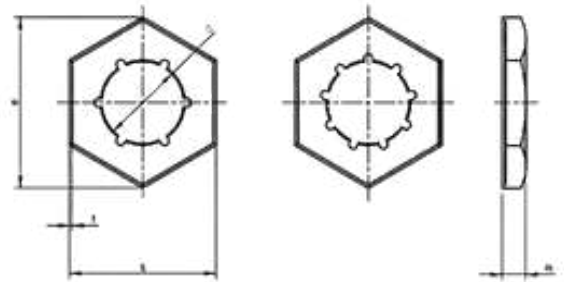

ITEM NAME	PAL NUT
STANDARD	DIN 7967
FINISH	WZP
GRADE	Gr 4.8
SIZE RANGE	M8 - M24

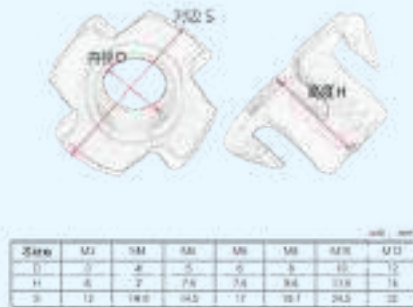

ITEM NAME	TEETH NUT
STANDARD	DIN 1624
FINISH	WZP
GRADE	Gr 4.8
SIZE RANGE	M6 - M12

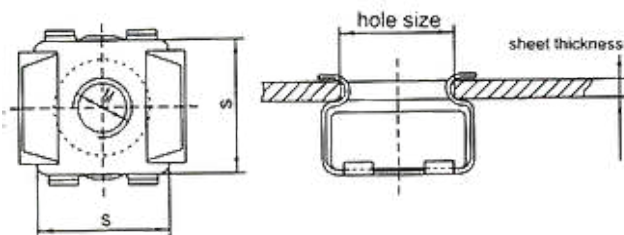

ITEM NAME	CAGE NUT
STANDARD	EB88109
FINISH	WZP/YZP
GRADE	-
SIZE RANGE	M6 - M10

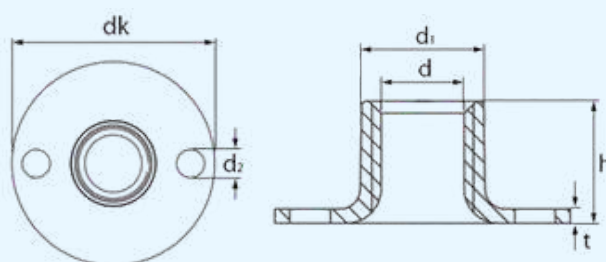

ITEM NAME	ROUND BASE TEE NUT
STANDARD	-
FINISH	YZP
GRADE	-
SIZE RANGE	M6 - M8

NUTS

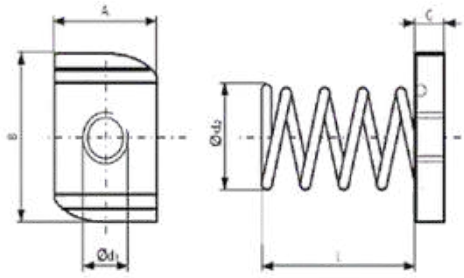

ITEM NAME	SPRING NUT- SHORT/ LONG SPRING
STANDARD	-
FINISH	WZP/SS
GRADE	Gr4.8/A2/A4
SIZE RANGE	M6 - M12

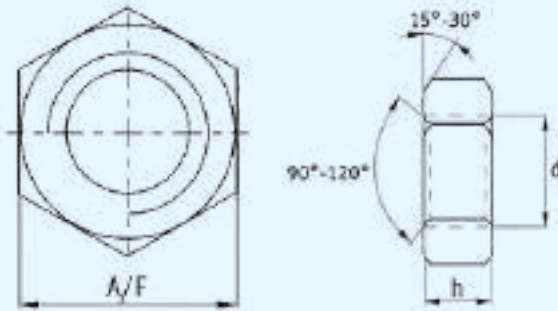

ITEM NAME	BRASS HEX NUT
STANDARD	DIN 934
FINISH	Brass
GRADE	-
SIZE RANGE	M6 - M16

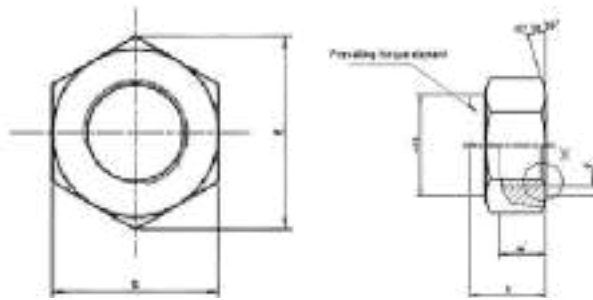

ITEM NAME	NYLON NUT
STANDARD	DIN 934
FINISH	Nylon / Teflon
GRADE	A536/2H
SIZE RANGE	M6 - M16

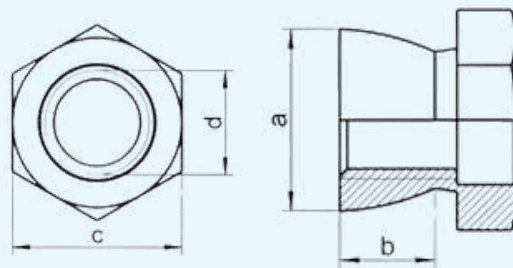

ITEM NAME	ANTI THEFT NUT
STANDARD	DIN 9150
FINISH	WZP/SS
GRADE	Gr4.8/A2/A4
SIZE RANGE	M6 - M8

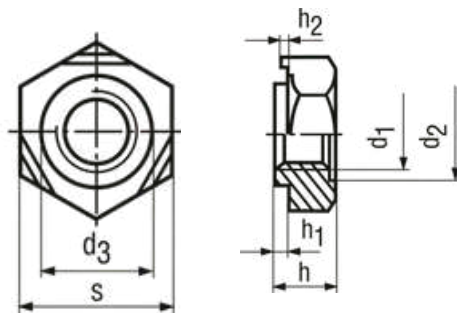

ITEM NAME	WELD NUT DIN 928
STANDARD	DIN 928
FINISH	WZP
GRADE	8.8
SIZE RANGE	M6 - M12

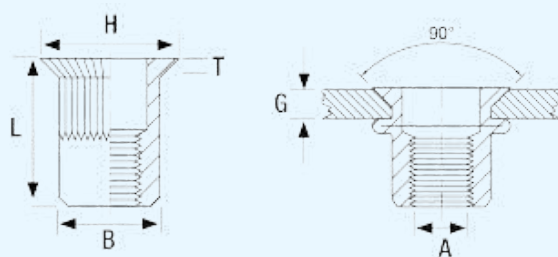

ITEM NAME	RIVET NUT WITH & W/O COLLAR
STANDARD	UNI 9201/9202
FINISH	WZP/SS
GRADE	Gr4.8/A2/A4
SIZE RANGE	M4 - M12

HIGH TENSILE FASTENERS

STUD BOLTS

ASTM A193 STUD BOLTS (HIGH-TEMP.)

The ASTM A193 specification covers alloy-steel and stainless steel stud bolts materials for high temperature or high-pressure service. The most common stud bolts materials covered by ASTM A193 are:

- **ASTM A193 B7/ B7M: Alloy steel, AISI 4140/4142 quenched and tempered.**
- **ASTM A193 B8: Class 1 Stainless steel, AISI 304, carbide solution treated.**
- **ASTM A193 B8M: Class 1 Stainless steel, AISI 316, carbide solution treated.**



STUD BOLT AND NUTS

A stud bolt consists of one threaded steel rod and two (matching) hexagonal heavy steel nuts. Stud bolts and nuts are essential components of flanged joints, as they are key to seal flanged joints properly. Stud bolts are available in multiple diameters and lengths combinations, metric and imperial, and in a variety of materials from carbon steel to alloy, stainless and nickel alloys (common grades are: ASTM A193 B7, L7, B8, B8M, B16, The material of the hex steel nuts shall match the material of the threaded rod (generally, stud materials ASTM A193 match with nuts materials ASTM A194).

The most common materials for stud bolts (for flanges) are ASTM A193 (grade B7, B8, B8M, B8T), ASTM A453 (grade 660), ASTM A320 (grade L7, L7M), and ASTM A182 (duplex and super duplex bolting). For aggressive fluids and environments, stud bolts can be coated with Xylan, Xylar and other materials.

HIGH TENSILE HEX NUTS

Standard Specification : ISO 4032
Also Conforms to BS 3692, DIN 934
Material : Medium Carbon Steel
Mechanical Properties : Cl 8, 10
Threads : Conforms to Class 6H of ISO 965 / 2
Surface Finish : Black Oxide, Zinc Plated
 Hot Dipped Galvanized



DIMENSIONS

Unit : mm

Nominal Size	Thread Pitch	W		C	H	
		Max	Min	Min	Max	Min
M8	1.25	13	12.73	14.38	6.8	6.44
M10	1.5	16	15.73	17.77	8.4	8.04
M12	1.75	18	17.73	20.03	10.8	10.37
M14	2	21	20.67	23.35	12.8	12.1
M16	2	24	23.67	26.75	14.8	14.1
M20	2.5	30	29.16	32.05	18	16.9
M24	3	36	35	39.55	21.5	20.2
M30	3.5	46	45	50.85	25.6	24.3
M36	4	55	53.8	60.79	31	29.4

HIGH TENSILE BOLTS

Standard Specification : BS 3692
 Also conforms to ISO 4014, DIN 931 / 933

Material : High Tensile Steel

Mechanical Properties : BS 3692 / ISO 898 - 1

Strength Grade : 8.8, 10.9

Screw thread : 6g of ISO 965 / 2

Surface Finish : Black Oxide, Zinc Plated
 Hot Dipped Galvanized



DIMENSIONS

Unit : mm

NOM SIZE d X p	d1		H		B		C		S		
	Max	Min	Max	Min	Max	Min	Max	Min	<= 125	> 125 <= 200	> 200
M6 X 1	6.0	5.82	4.150	3.850	10.0	9.78	11.5	11.05	18		
M8 X 1.25	8.0	5.82	5.650	5.350	13.0	12.73	15	14.38	22		
M10 X 1.5	10.0	9.78	7.180	6.820	17.0	16.73	19.6	18.90	26	32	
M12 X 1.75	12.0	11.73	8.180	7.820	19.0	18.67	21.9	21.10	30	36	48
M14 X 2	14.0	13.73	9.180	8.820	22.0	21.67	25.4	24.49	34	40	53
M16 X 2	16.0	15.73	10.180	9.820	24.0	23.67	27.7	26.75	38	44	57
M18 X 2.5	18.0	17.73	12.215	11.785	27.0	26.67	31.2	30.14	42	48	61
M20 X 2.5	20.0	19.67	13.215	12.785	30.0	29.67	34.6	33.53	46	52	65
M22 X 2.5	22.0	21.67	14.215	13.785	32.0	31.61	36.9	35.72	50	56	69
M24 X 3	24.0	23.67	15.215	14.785	36.0	35.38	41.6	39.98	54	60	73
M27 X 3	27.0	26.67	17.215	16.785	41.0	40.38	47.3	45.63	60	66	79
M30 X 3.5	30.0	29.67	19.260	18.740	46.0	45.38	53.1	51.28	66	72	85
M33 X 3.5	33.0	32.61	21.260	20.740	50.0	49.38	57.7	55.80	72	78	91
M36 X 4	36.0	35.61	23.260	22.740	55.0	54.26	63.5	61.31	78	84	97
M39 X 4	39.0	38.61	25.260	24.740	60.0	59.26	69.3	66.96	84	90	103
M42 X 4	42.0	41.61	26.260	25.740	65.0	64.26	75.1	72.61	90	96	109
M45 X 4.5	45.0	44.61	28.260	27.740	70.0	69.26	80.8	78.26	96	102	115
M48 X 5	48.0	47.61	30.260	29.740	75.0	74.26	86.6	83.91	102	108	121
M52 X 5	52.0	51.54	33.210	32.690	80.0	79.26	92.4	89.56	110	116	129

HARDENED WASHERS

Standard Specification : ASTM F 436M

Material : Medium Carbon Steel

Hardness : Black Washer 38 ~45
 HRC, HDG Washer 26 ~45
 HRC

Surface Finish : Black, Zinc Plated Hot
 Dipped Galvanized

Bolt Size	Inner Diameter (d)		Outer Diameter (D)		Thickness (t)	
	Max	Min	Max	Min	Max	Min
M12	14.40	14.00	27.00	25.70	4.60	3.10
M14	16.40	16.00	30.00	28.07	4.60	3.10
M16	18.40	18.00	34.00	32.40	4.60	3.10
M20	22.50	22.00	42.00	40.40	4.60	3.10
M22	24.50	24.00	44.00	42.40	4.60	3.40
M24	26.50	26.00	50.00	48.40	4.60	3.40
M27	30.50	30.00	56.00	54.10	4.60	3.40
M30	33.80	33.00	60.00	58.10	4.60	3.40
M36	39.80	39.00	72.00	70.10	4.60	3.40
M42	45.80	45.00	84.00	81.10	7.20	4.60



Structural Washers for use with A325 & A490 Structural Bolts

- HARDENED WASHERS ARE AVAILABLE TO ACCOMMODATE BOLT SIZES M10 - M30 DIA.
- SUPPLIED IN PLAIN FINISH TO ASTM SPEC F436 TYPE 1.

WASHERS



***Fasten
with
Precision***



WASHERS

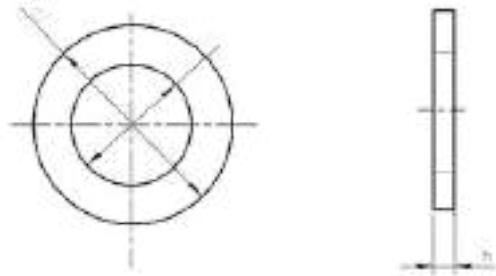

ITEM NAME	FLAT WASHER
STANDARD	DIN 125
FINISH	WZP/HDG
GRADE	Gr4.8/SS 304/316/F436
SIZE RANGE	M4 - M48

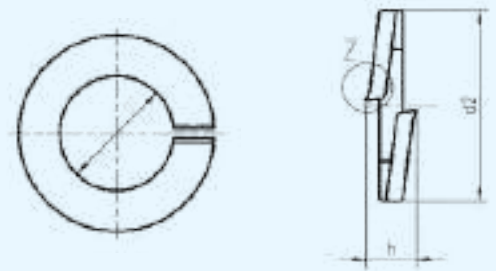

ITEM NAME	SPRING WASHER
STANDARD	DIN 127
FINISH	WZP/HDG/SS
GRADE	Gr4.8/SS304/316
SIZE RANGE	M46- M30

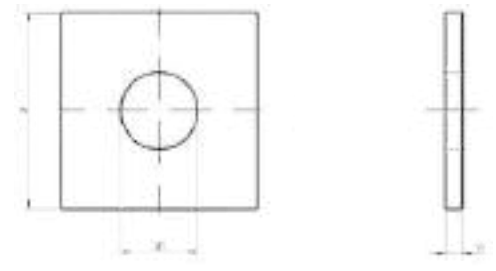

ITEM NAME	SQUARE WASHER
STANDARD	DIN 436
FINISH	WZP/HDG
GRADE	Gr4.8
SIZE RANGE	M8 - M24

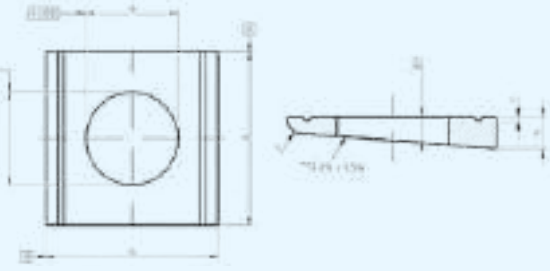
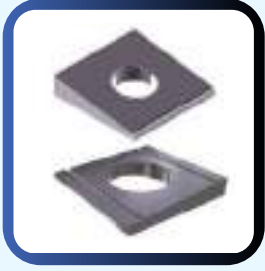

ITEM NAME	TAPER WASHER
STANDARD	DIN 434/DIN 435
FINISH	WZP/HDG
GRADE	Gr4.8
SIZE RANGE	M4 - M24

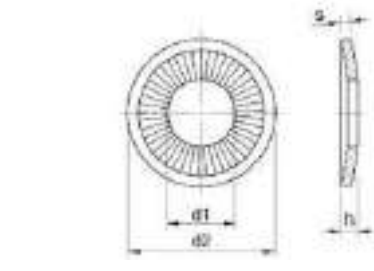

ITEM NAME	CONTACT/CONICAL WASHER
STANDARD	DIN 6796
FINISH	WZP/HDG
GRADE	Gr4.8/SS 304/316
SIZE RANGE	M6 - M16

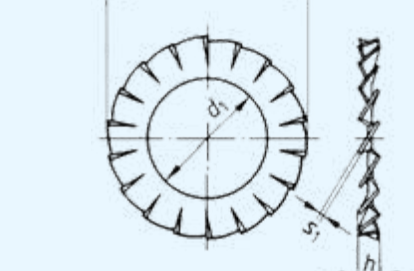

ITEM NAME	SERRATED TEETH WASHER
STANDARD	DIN 6798
FINISH	WZP/HDG/SS
GRADE	Gr4.8/SS 304/316
SIZE RANGE	M6 - M24

WASHERS

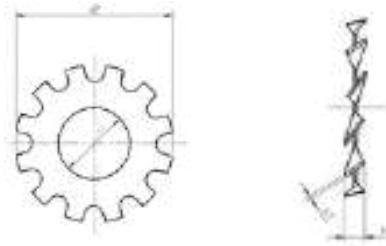

ITEM NAME	STAR WASHER
STANDARD	DIN 6797
FINISH	WZP/HDG
GRADE	Gr4.8
SIZE RANGE	M6 - M20

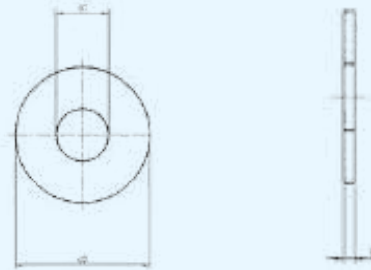

ITEM NAME	HEAVY LOAD WASHER
STANDARD	DIN 7349
FINISH	WZP/HDG
GRADE	Gr4.8
SIZE RANGE	M16 - M30

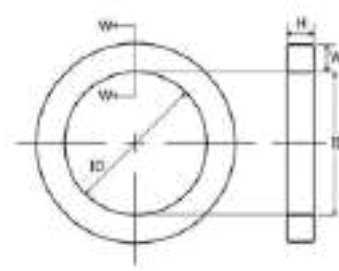

ITEM NAME	RUBBER WASHER
STANDARD	DIN 125/9021
FINISH	SELF
GRADE	-
SIZE RANGE	M16 - M24

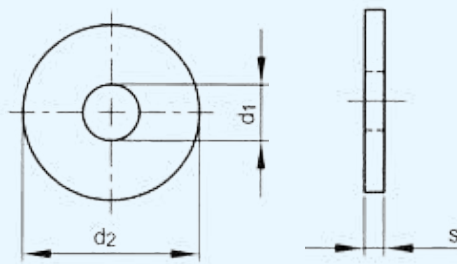

ITEM NAME	NYLON/TEFLON WASHER
STANDARD	DIN 125/9021
FINISH	SELF
GRADE	-
SIZE RANGE	M16 - M20

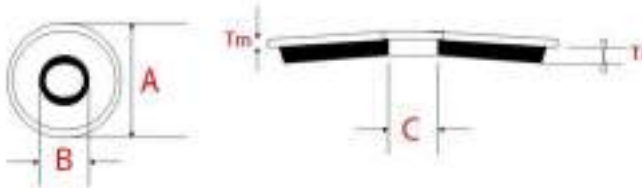

ITEM NAME	EPDM BINDED WASHER
STANDARD	-
FINISH	WZP with Bonded EPDM
GRADE	-
SIZE RANGE	M16- M10

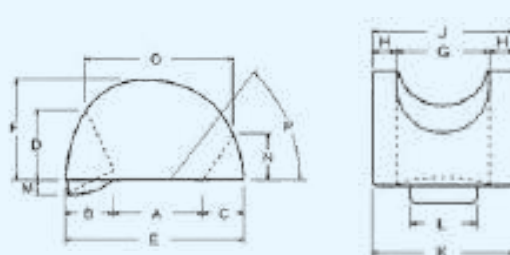

ITEM NAME	HILLSIDE WASHER
STANDARD	DIN 6798
FINISH	WZP/HDG
GRADE	Casting
SIZE RANGE	M12 - M30

WASHERS

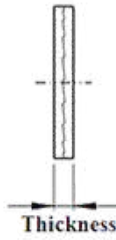
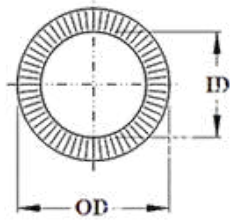

ITEM NAME	NORD LOCK WASHER
STANDARD	DIN 25201
FINISH	WZP/HDG
GRADE	-
SIZE RANGE	M6 - M30

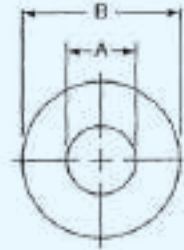

ITEM NAME	BRASS WASHER
STANDARD	DIN 125
FINISH	BRASS
GRADE	-
SIZE RANGE	M6 - M16

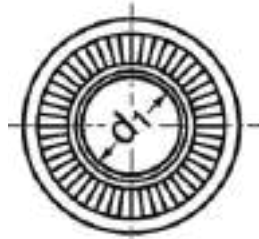

ITEM NAME	PICOT WASHER
STANDARD	DIN 6795
FINISH	WZP/HDG
GRADE	Gr4.8
SIZE RANGE	M6 - M16



ITEM NAME	NAIL WASHER
STANDARD	DIN 1440
FINISH	WZP/HDG
GRADE	Gr4.8/SS 304/316
SIZE RANGE	3 x 20, 4 x 20 & 5 x 20

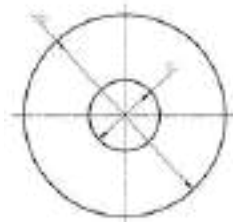

ITEM NAME	PENNY WASHER
STANDARD	DIN 9021
FINISH	WZP/HDG
GRADE	Gr4.8/SS 304/SS 316
SIZE RANGE	M6 - M24

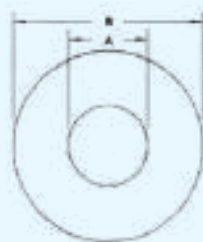

ITEM NAME	HARDENED WASHER
STANDARD	DIN 125
FINISH	BLACK/HDG
GRADE	F436
SIZE RANGE	M10 to M30 1/2" to 2"

ANCHORS



***Fasten
with
Precision***



ANCHORS

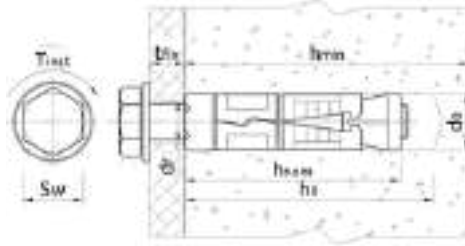

ITEM NAME	ESSAR RAWL BOLT
FINISH	YZP/WZP
SIZE RANGE	M6-M24

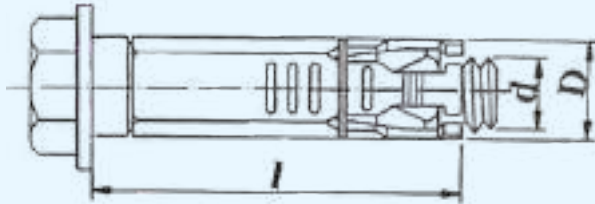

ITEM NAME	FIXBOLT SET
FINISH	YZP / WZP / SS
SIZE RANGE	M5 - M24

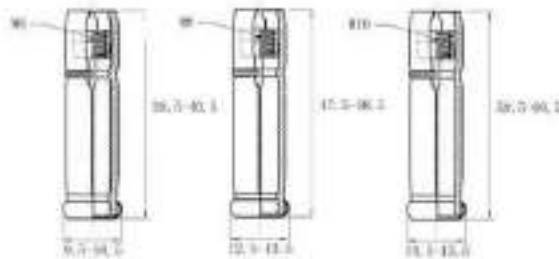

ITEM NAME	FIXBOLT SHIELD ANCHOR
FINISH	YZP / WZP / SS
SIZE RANGE	M6 - M20



ITEM NAME	THRU BOLT PG
FINISH	YZP / WZP / SS
SIZE RANGE	M6 - M24

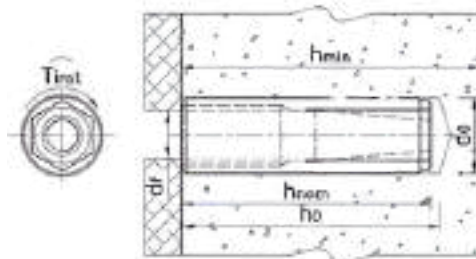

ITEM NAME	DROP IN ANCHOR/ UNIFIX
FINISH	YZP / WZP / SS
SIZE RANGE	M6 - M20

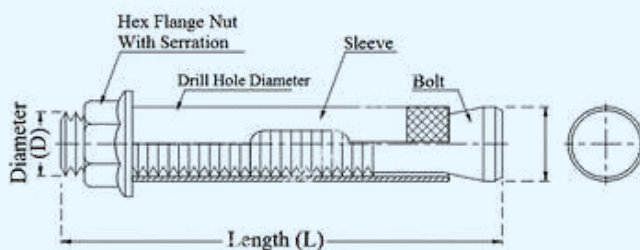

ITEM NAME	SLEEVE ANCHOR WITH FLNAGE NUT/ HEX HEAD
FINISH	YZP
SIZE RANGE	M8 - M20

ANCHORS

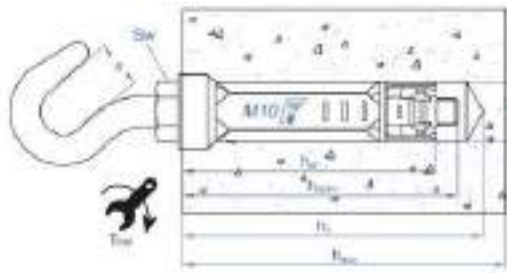

ITEM NAME	HOOK/ EYE WITH SHIELD
FINISH	YZP / WZP
SIZE RANGE	M6 - M24

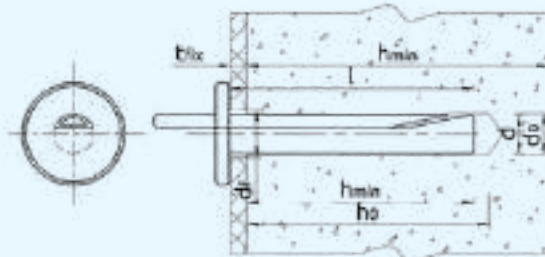

ITEM NAME	CEILING ANCHOR
FINISH	YZP / WZP
SIZE RANGE	M6 x 40/45

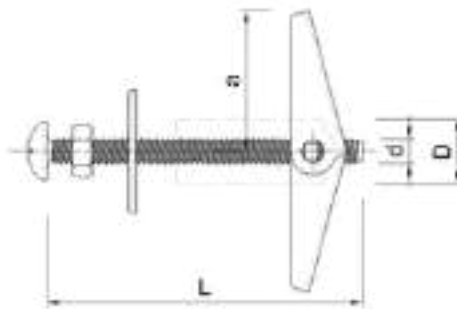

ITEM NAME	SPRING TOGGLE
FINISH	WZP
SIZE RANGE	M4 - M10

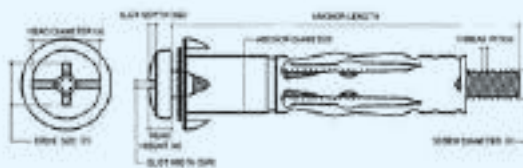

ITEM NAME	HOLLOW WALL / CAVITY ANCHOR
FINISH	WZP
SIZE RANGE	M4 - M8

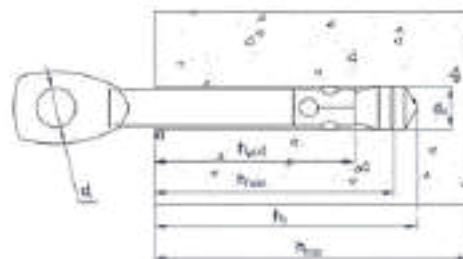

ITEM NAME	TIE WIRE ANCHOR
FINISH	YZP / WZP
SIZE RANGE	M6 x 50

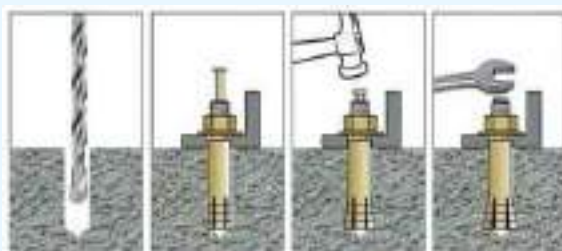

ITEM NAME	HIT NAIL ANCHOR
FINISH	YZP
SIZE RANGE	M6 - M20

ANCHORS

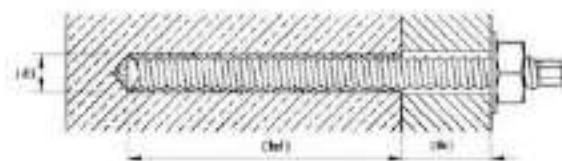

ITEM NAME	CHEMICAL ANCHOR
FINISH	YZP / WZP
SIZE RANGE	M8 - M30

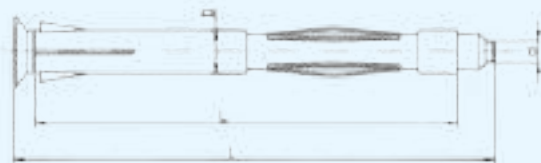

ITEM NAME	METAL FRAME ANCHOR
FINISH	WZP
SIZE RANGE	M10 x 72 - 202

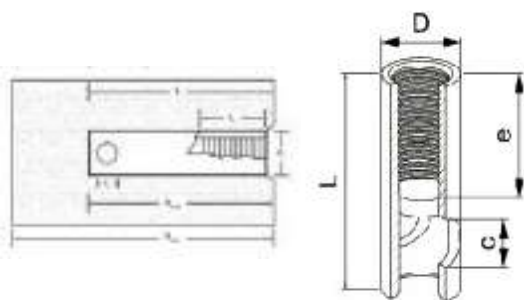

ITEM NAME	ROUND LIFTING SOCKET
FINISH	YZP
SIZE RANGE	M6 - M20

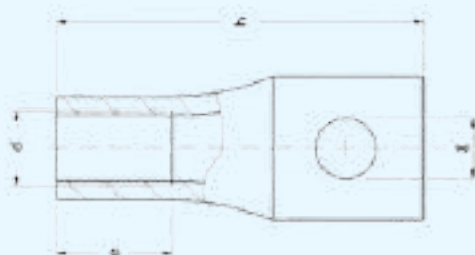

ITEM NAME	CASTING SOCKET
FINISH	YZP
SIZE RANGE	M8 - M20

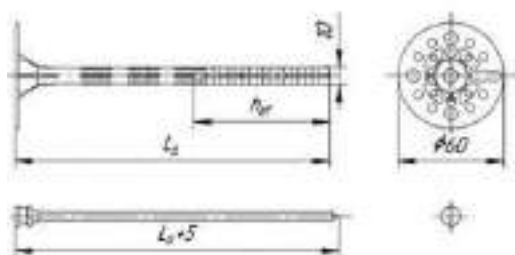

ITEM NAME	METAL INSULATION ANCHOR
FINISH	WZP
SIZE RANGE	M8 x 90, 110, 140mm

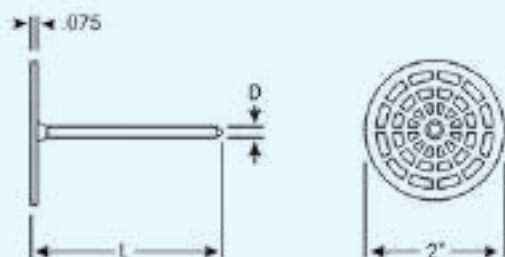

ITEM NAME	NYLON INSULATION ANCHOR
FINISH	PVC / Nylon
SIZE RANGE	M10 x 70, 90, 110, 130 & 150mm

ANCHORS

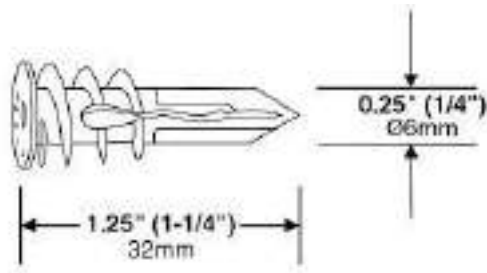

ITEM NAME	PLASTERBOARD SELF DRILL ANCHOR
FINISH	Nylon / Zinc Alloy
SIZE RANGE	-

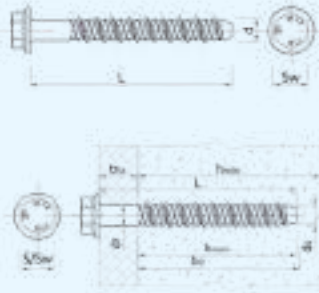

ITEM NAME	CONCRETE SCREW ANCHOR
FINISH	WZP / Dacromet
SIZE RANGE	M6 - M16, 50-200mm Long



ITEM NAME	GYPSUM TOGGLE
FINISH	Nylon
SIZE RANGE	A13/19/25

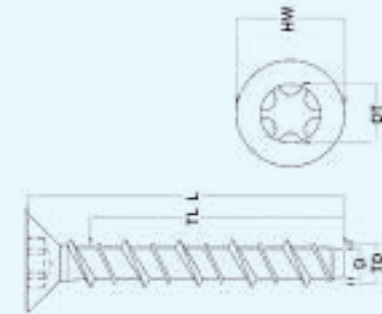

ITEM NAME	CONCRETE SCREW ANCHOR CSK TORX HEAD
FINISH	WZP / Dacromet
SIZE RANGE	M6, 8, 10

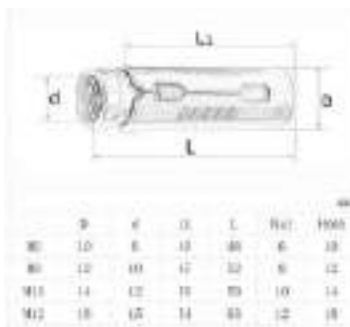

ITEM NAME	TAM SHIELD ANCHOR
FINISH	SS - A2 / A4
SIZE RANGE	M6 - M12



ITEM NAME	HEAVY DUTY SHIELD ANCHOR
FINISH	WZP
SIZE RANGE	M6- M12

ANCHORS

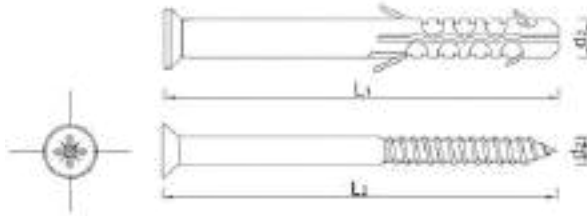

ITEM NAME	NYLON FRAME FIXING
FINISH	PVC / Nylon
SIZE RANGE	M8 - M10 60-200mm

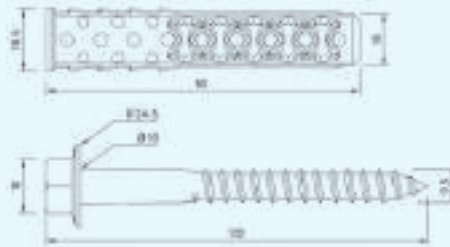

ITEM NAME	HUMP ANCHOR
FINISH	PVC with WZP Screw
SIZE RANGE	14 x 100



ITEM NAME	HAMMERING NAIL ANCHOR
FINISH	Zinc Alloy
SIZE RANGE	M6



ITEM NAME	SISSY ANCHOR PLUG
FINISH	Dacromet
SIZE RANGE	M8 / 10 / 12 / 16

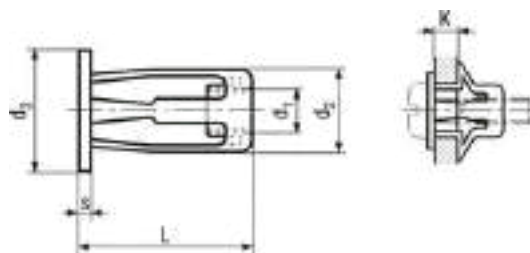

ITEM NAME	JACK NUT / PETAL NUT
FINISH	WZP
SIZE RANGE	M4 / M5

BENT BOLTS & FOUNDATION ANCHORS

ANCHOR FOUNDATION BOLTS

We supply L / J / Straight anchor foundation bolts sizes from M12 To M36, coating finish - WZP/HDG fitted with 2 nuts / 2 washers. Special sizes can be made as per requirements.

Materials:- Gr. 4.6 / 8.8 / 10.9 / Gr. 50 / Gr. 105 / F1554 / ASTM A572.

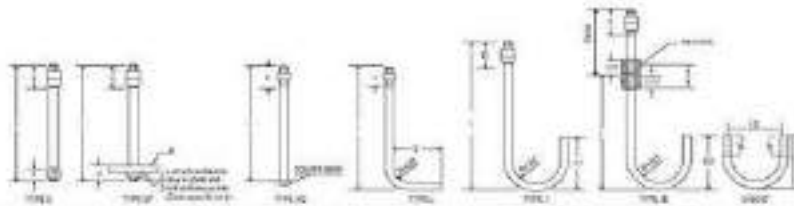

ANCHOR THREAD DIAMETER	DIMENSIONS mm										CUTTING LENGTH mm										
	A	B	C	D	E	F	G	H	P		S		SQ		L		F		JE		
	SQUARE PLATE		L		L		L		L		L		L		L		L		L		
M12	40	18	40	45	100	-	50	29	10	75	330	330	330	381	355	405	410	542	-	-	
M16	50	19	40	35	100	-	65	35	12	90	400	400	355	384	355	405	420	595	-	-	
M20	60	22	50	28	150	90	75	30	12	90	480	460	405	442	485	555	495	705	355	575	
M22	70	25	50	25	150	55	80	48	16	100	570	570	460	498	460	610	545	797	415	657	
M24	80	28	55	30	200	65	80	55	20	100	700	700	510	553	510	710	610	874	475	730	
M27	-	-	75	100	200	75	-	-	-	-	-	-	-	500	610	580	700	673	970	525	813
M30	100	36	75	115	200	85	110	64	20	125	820	820	610	667	610	810	735	1045	586	926	
M33	-	-	90	125	200	90	-	-	-	-	-	-	-	640	800	800	1163	655	1010	-	-
M36	115	42	90	125	200	95	115	70	25	150	1010	1010	-	-	710	910	805	1261	715	1111	
M39	-	-	100	145	200	110	-	-	-	-	-	-	-	760	960	925	1354	770	1199	-	-
M42	130	49	115	150	255	120	130	85	25	175	1120	1120	-	-	815	1070	990	1452	810	1290	
M48	150	56	125	180	255	125	-	-	-	-	-	-	-	-	815	1170	1120	1648	956	1484	
M56	170	63	140	200	255	145	-	-	-	-	-	-	-	-	1015	1270	1245	1861	1070	1690	
M64	190	70	160	220	255	160	-	-	-	-	-	-	-	-	1120	1375	1320	2074	1190	1894	



BENT BOLTS

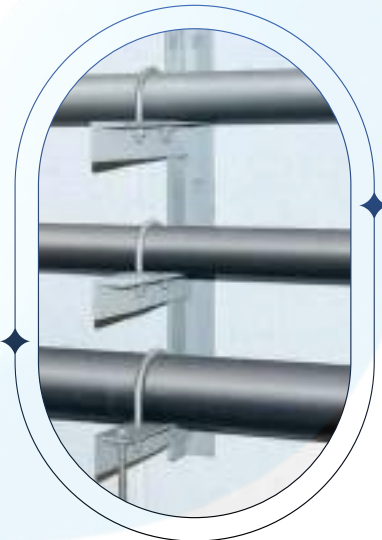
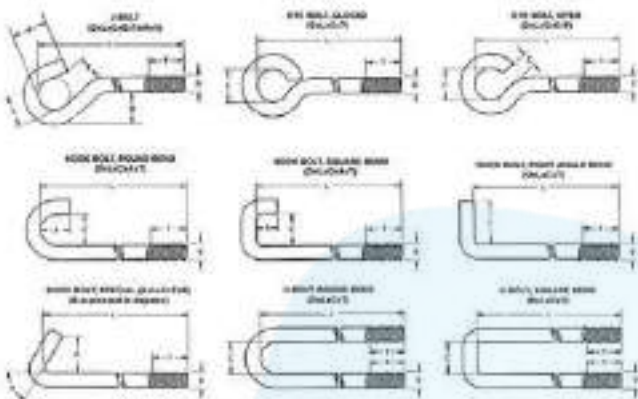

J BOLTS



J-shaped fasteners, threaded for secure attachment to structural components. As a trusted J Bolt supplier, we provide high-quality J Bolts in various sizes and specifications.

U BOLTS



U Bolts are U-shaped fasteners designed to provide secure support for pipes, tubes, and structural components. As a reliable U Bolt supplier, we offer a wide range of U Bolts in different sizes and specifications.

SCREWS



***Fasten
with
Precision***



SCREWS

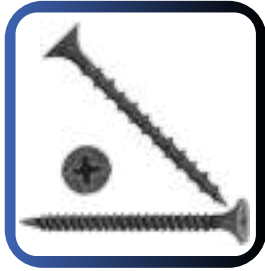

ITEM NAME	DRYWALL SCREWS- FINE / COARSE
FINISH	Black Phosphate
SIZE	6 to 10 1/2" to 4"



ITEM NAME	CSK SELF TAPPING SCREWS
FINISH	Nickle plated / WZP / SS
SIZE	6 to 14 1/2" to 4"



ITEM NAME	PAN SELF TAPPING SCREWS
FINISH	WZP / SS
SIZE	6 to 12 1/2" to 2"



ITEM NAME	HEX HEAD SELF DRILLING SCREWS
FINISH	WZP / SS - A2 / A4
SIZE	6 to 14 1/2" to 6"



ITEM NAME	CSK PH WZP WOOD SCREW
FINISH	WZP / SS - A2 / A4
SIZE	8 to 14 3/2" to 4"



ITEM NAME	CSK SELF DRILLING SCREWS
FINISH	WZP / SS - A2 / A4
SIZE	6 to 14 1/2" to 4"



ITEM NAME	PAN PH SELF DRILLING SCREWS
FINISH	WZP / SS - A2 / A4
SIZE	6 to 12 1/2" to 2"



ITEM NAME	WAFER HD SELF DRILLING / TAPPING
FINISH	Black / WZP / SS
SIZE	#6 to #10 6x7/16" to 3"



ITEM NAME	WINDOW CONCRETE SCREW
FINISH	WZP
SIZE	7.5 x 72 to 202mm



ITEM NAME	CSK / PAN MACHINE SCREWS
FINISH	Nickle / WZP / SS
SIZE	M 3.5 to M 12



ITEM NAME	COACH SCREW
FINISH	WZP / SS
SIZE	M6 to M16 40 to 200mm

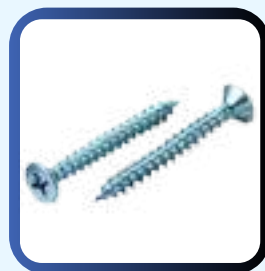

ITEM NAME	CHIPBOARD SCREW
FINISH	WZP
SIZE	3.5 to 6mm

RIGGING



***Fasten
with
Precision***



RIGGING



ITEM NAME	WIRE ROPE CLIPS
FINISH	GI/SS-304/316
SIZE	M3 to M50



ITEM NAME	TURNBUCKLE PIPE - JAW/JAW
FINISH	GI
SIZE	-



ITEM NAME	TURN BUCKLE - H/E, E/E, J/J
FINISH	GI/SS-304/316
SIZE	M6 to M20



ITEM NAME	LIFTING EYE NUT
FINISH	GI/SS-304/316
SIZE	M6 to M36



ITEM NAME	LIFTING EYE BOLT / LONG THREAD
FINISH	-
SIZE	M10 to M24



ITEM NAME	DE SHACKLE
FINISH	GI/SS-304/316
SIZE	M5 to M24



ITEM NAME	DIN 1480 HVY FORGED TURNBUCKLE BODY ONLY
FINISH	GI
SIZE	M8 to M20

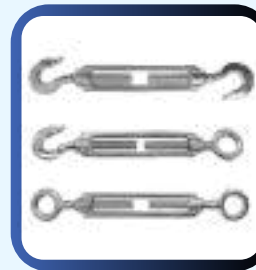

ITEM NAME	DIN 1480 HVY DUTY FORGED TURNBUCKLE
FINISH	GI
SIZE	M10 to M20

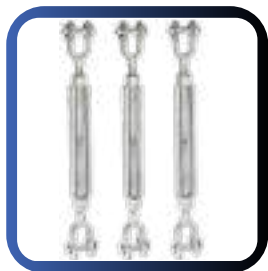

ITEM NAME	DIN 1480 HVY DUTY TURNBUCKLE FORGED-JAW TO JAW
FINISH	GI
SIZE	M10 to M20



ITEM NAME	R PIN
FINISH	GI
SIZE	2mm - 10mm



ITEM NAME	WIRE ROPE Galvanised
FINISH	GI/SS-304/316
SIZE	1.5mm - 16mm



ITEM NAME	Aluminium ferrule
FINISH	Aluminium One hole / Two hole M2 to M12
SIZE	M2 to M16

RIGGING



ITEM NAME	THIMBLE
FINISH	GI/SS-304/316
SIZE	M3 to M16



ITEM NAME	G277 SHOULDER EYE BOLT
FINISH	GI
SIZE	M10 to M16



ITEM NAME	S HOOK
FINISH	GI/SS-304/316
SIZE	2mm - 8mm



ITEM NAME	US TYPE FORGED BOW SHACKLE
FINISH	GI
SIZE	M6 to M24



ITEM NAME	S HOOK LONG TYPE
FINISH	GI
SIZE	5 x 80, 120 6x160



ITEM NAME	CP & BP CHAIN
FINISH	-
SIZE	1.5, 2, 2.5 & 3 mm



ITEM NAME	GI CHAIN
FINISH	GI/SS-304/316
SIZE	3mm to 12mm



ITEM NAME	PIPE HOOK, L HOOK & ANGLE HOOK WITHN/ WSET
FINISH	GI
SIZE	M6 x 4" to 7 L x 1" - 3" W



ITEM NAME	BOW SHACKLE
FINISH	GI
SIZE	1 Ton - 12 Ton



ITEM NAME	SNAP HOOK
FINISH	GI/SS-304/316
SIZE	3mm - 12mm

PIPE CLAMP



***Fasten
with
Precision***

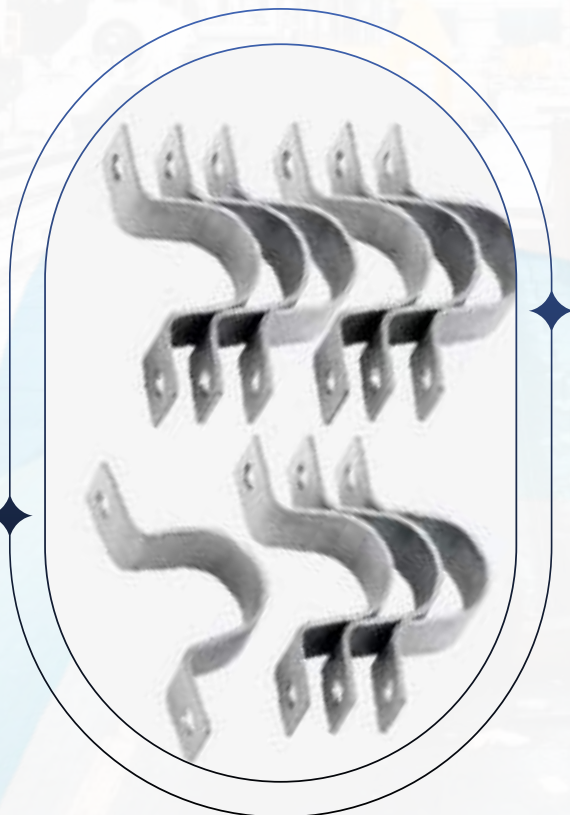

PIPE CLAMP



ITEM NAME	PIPE HANGING CLAMPS
FINISH	GI/SS-304/316
SIZE	3/8" to 12"



ITEM NAME	NAIL CLAMPS
FINISH	GI
SIZE	1/2" to 4"



ITEM NAME	U SADDLE HEAVY & LIGHT DUTY CLAMP
FINISH	GI/SS-304/316
SIZE	1/2" to 4"



ITEM NAME	CLEVIS CLAMP
FINISH	GI
SIZE	3/4" to 16"



ITEM NAME	SPRINKLER CLAMPS
FINISH	GI
SIZE	1/2" to 6"



ITEM NAME	STRUT CHANNEL CLAMPS
FINISH	GI
SIZE	1/2" to 4"



ITEM NAME	RISER CLAMP
FINISH	GI/HDG
SIZE	1" to 12"



ITEM NAME	GRATING CLAMP
FINISH	GI/SS/HDG
SIZE	-



ITEM NAME	W CLAMP
FINISH	HDG
SIZE	-



ITEM NAME	SINGLE CABLE CLAMP
FINISH	GI
SIZE	20-22mm to 58-63mm



ITEM NAME	Q BRACE CROSEE PIPE CLAMP
FINISH	GI/HDG
SIZE	48 x 48mm



ITEM NAME	T BOLT HOSE CLAMP
FINISH	YZP
SIZE	23-25mm to 162-174mm

PIPE CLAMP



ITEM NAME	MUFFLER/ EXHAUST CLAMP
FINISH	GI
SIZE	M8 x 35 - 105mm M10 x 130 - 163mm



ITEM NAME	SIGN BOARD POLE CLAMP
FINISH	GI/SS-304/316
SIZE	42mm - 114mm



ITEM NAME	G STRUT CLAMP
FINISH	GI
SIZE	28mm



ITEM NAME	CONDUIT HANGER
FINISH	GI
SIZE	0.5" to 1.5"



ITEM NAME	P CLIP WITH RUBBER
FINISH	GI/SS-304/316
SIZE	8mm to 50mm



ITEM NAME	BEAM CLAMP BIG JAW
FINISH	GI/SS-304/316
SIZE	M10/12/16



ITEM NAME	TUBE CLIP
FINISH	GI/SS-304/316
SIZE	6mm - 20mm



ITEM NAME	BEAM CLAMP MALLEABLE CASTING
FINISH	GI/HDG/SS
SIZE	M6 - M16



ITEM NAME	FAT BEAM CLAMP
FINISH	GI
SIZE	M10



ITEM NAME	SHEET METAL BEAM CLAMP
FINISH	GI
SIZE	25mm JAW



ITEM NAME	HALD SADDLE CLAMP
FINISH	GI
SIZE	0.5" to 1.5"



ITEM NAME	TWO EAR CLAMP- GI
FINISH	GI
SIZE	9-11mm to 34-38mm

STRUT CHANNEL & ACCESSORIES

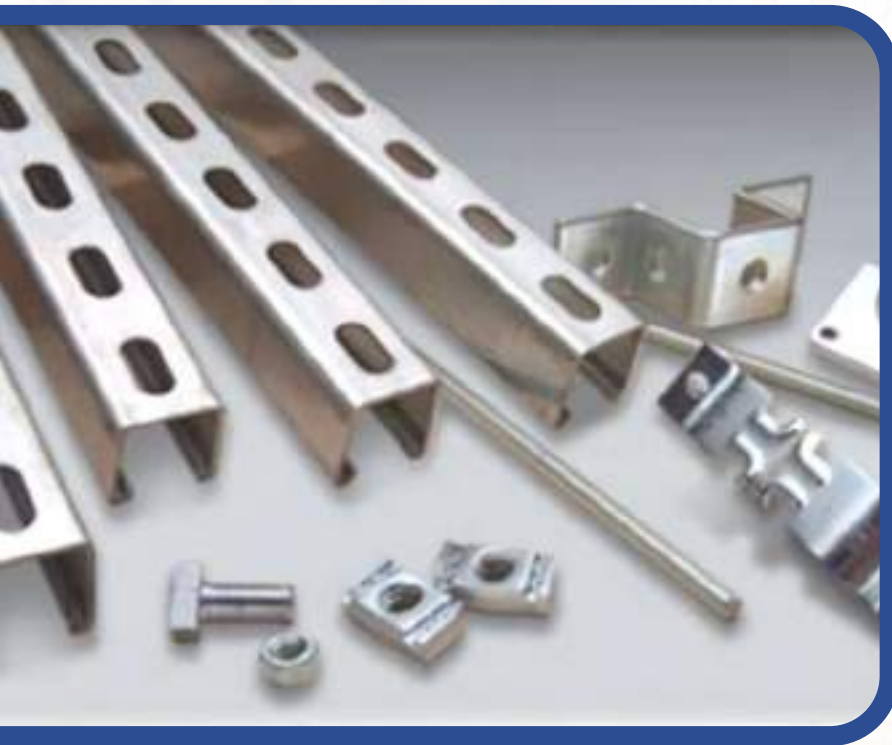

***Fasten
with
Precision***

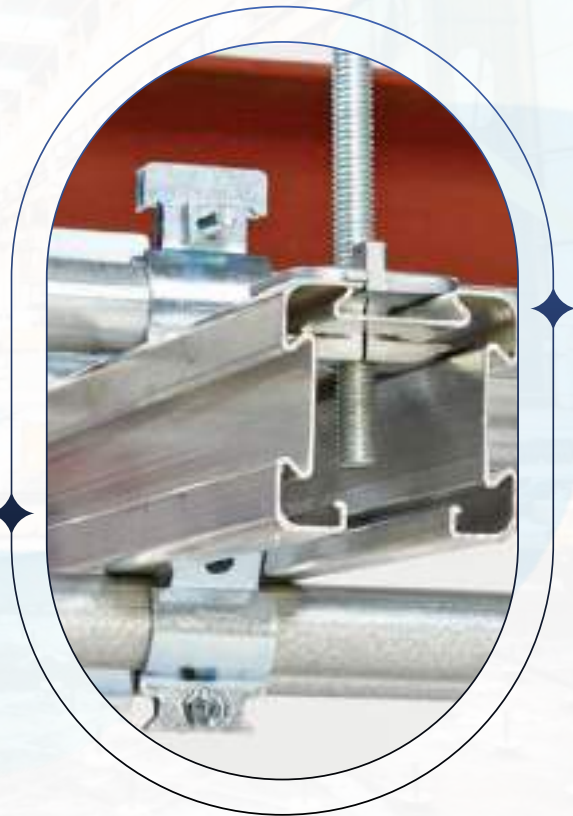
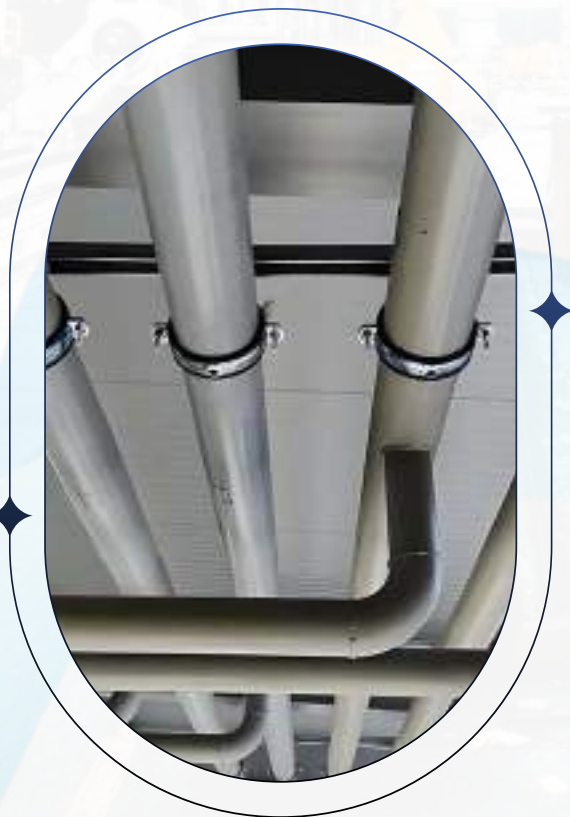

SLOTTED STRUT CHANNEL



ITEM NAME	STRUT CHANNEL
FINISH	GI/HDG
SIZE	41x21x0.80-2.5mm 41x41x1.00-2.5mm



ITEM NAME	HOLD DOWN CLAMP
FINISH	GI/HDG
SIZE	25 - 63mm



ITEM NAME	STRUT POST BASE
FINISH	GI/HDG
SIZE	Square/Rectangular Plate 41x41 - 41x82



ITEM NAME	STRUT CHANNEL U BOLT CLAMP
FINISH	GI/HDG
SIZE	41x41, 41x82



ITEM NAME	1-4 HOLE CHANNEL PLATES
FINISH	GI/HDG
SIZE	1 - 5 Hole 40x40 - 40x150mm



ITEM NAME	3 HOLE L ANGLE BRACKET
FINISH	GI/HDG
SIZE	-



ITEM NAME	C TYPE CHANNEL BRACKET
FINISH	GI/HDG
SIZE	-



ITEM NAME	3 HOLE Z FITTING
FINISH	GI/HDG
SIZE	-



ITEM NAME	STRUT BEAM CLAMP
FINISH	GI/HDG
SIZE	-



ITEM NAME	CHANNEL CLAMP
FINISH	GI
SIZE	0.5" to 4"



ITEM NAME	THREADED RODS
FINISH	GI/HDG/SS
SIZE	M6 - M45



ITEM NAME	SPRING NUT & PLATE
FINISH	GI/HDG/SS
SIZE	M6 - M12



RIVETS & PINS



***Fasten
with
Precision***



RIVETS & PINS



ITEM NAME	POP BLIND RIVETS
FINISH	ALUM/SS/GI
SIZE	32x8 to 63x50



ITEM NAME	WATERPROOF RIVETS
FINISH	GI
SIZE	4.5x12



ITEM NAME	BLACK & WHITE COLOR RIVETS
FINISH	BLACK/WHITE/ALUM
SIZE	25 - 63mm



ITEM NAME	GUN NAIL WITH STEEL/ PVC WASHER
FINISH	GI
SIZE	NK27 / 32mm LENTGH



ITEM NAME	MS STRUCTURAL RIVETS
FINISH	MS
SIZE	8mm - 16mm 30mm - 90mm

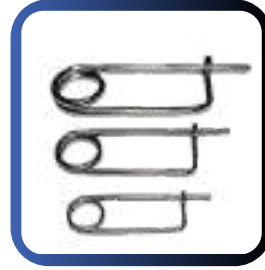

ITEM NAME	INDUSTRIAL SAFETY LOCK PIN
FINISH	GI
SIZE	2x40 to 8x170mm



ITEM NAME	COTTER / SPLIT PIN
FINISH	GI/SS
SIZE	2mm - 10mm 20mm - 150mm LONG



ITEM NAME	INDUSTRIAL LYNCH PIN
FINISH	YZP
SIZE	4.5x40, 6x45, 7.5x45



ITEM NAME	CLEVIS PIN
FINISH	GI
SIZE	-



ITEM NAME	ANTI LUCE PIN
FINISH	GI
SIZE	-



ITEM NAME	R PIN
FINISH	GI
SIZE	2mm - 10mm 40mm - 150mm LONG



ITEM NAME	LONG TYPE S HOOK
FINISH	GI
SIZE	LONG & SHORT TYPE 2mm - 8mm

SCAFFOLDING



***Fasten
with
Precision***



SCAFFOLDING



ITEM NAME	TIE ROD
FINISH	-
WEIGHT	7.0 - 8.0 kg



ITEM NAME	BRC COUPLER
FINISH	-
WEIGHT	560 - 650 gm



ITEM NAME	TIE ROD NUT
FINISH	-
WEIGHT	0.170 - 0.300 gm



ITEM NAME	SLEEVE COUPLER
FINISH	-
WEIGHT	1.0 kg



ITEM NAME	WALLER BASE PLATE FOR TIE ROD
FINISH	4.0 To 7.0mm Thick
WEIGHT	-



ITEM NAME	FORGED SWIVEL COUPLER
FINISH	-
WEIGHT	980 - 1050 gm



ITEM NAME	ANCHOR NUT- 2LEG
FINISH	90mm OD
WEIGHT	400 To 500 gm



ITEM NAME	FORGED FIXED COUPLER
FINISH	-
WEIGHT	900 To 1000 gm



ITEM NAME	ANCHOR NUT - 3 LEG
FINISH	100mm OD
WEIGHT	500 To 600 gm



ITEM NAME	LADDER CLAMP
FINISH	-
WEIGHT	600 gm



ITEM NAME	PUTLOG COUPLER
FINISH	-
WEIGHT	550 - 630 gm



ITEM NAME	JOINT PIN
FINISH	-
WEIGHT	630 gm

SCAFFOLDING



ITEM NAME	GIRDER COUPLER
FINISH	-
WEIGHT	1.25 - 1.35 kg



ITEM NAME	T BOLT FOR COUPLER
FINISH	M12 x 85
WEIGHT	-



ITEM NAME	FENCING COUPLER
FINISH	1.50 To 2.0mm Thick
WEIGHT	250 To 300 gm



ITEM NAME	SCAFFOLDING TOGGLE PIN
FINISH	11 x 40, 16 x 50
WEIGHT	-



ITEM NAME	COUPLING NUT FOR TIE ROD
FINISH	50mm, 100mm Long
WEIGHT	-



ITEM NAME	ANTI LUCE PIN
FINISH	-
WEIGHT	-



ITEM NAME	UNIVERSAL CLAMP
FINISH	-
WEIGHT	450 gm



ITEM NAME	SHEET METAL YELLOW COUPLER
FINISH	-
WEIGHT	500 gm



ITEM NAME	WATER STOPPER WITH PVC CONE
FINISH	-
WEIGHT	0.270 - 0.470 kg



ITEM NAME	SCAFFOLDING TAG
FINISH	-
WEIGHT	-



ITEM NAME	YELLOW COUPLER SINGLE
FINISH	-
WEIGHT	-



ITEM NAME	RAPID CLAMP
FINISH	-
WEIGHT	280 gm

SCAFFOLDING



ITEM NAME	TOP & BOTTOM CUP
FINISH	-
WEIGHT	Top- 300 To 400 gm Bottom- 160 To 200 gm



ITEM NAME	LEDGER BLADE
FINISH	-
WEIGHT	160 To 200 gm



ITEM NAME	SCAFFOLDING PIPE & BOLT END CAPS
FINISH	-
WEIGHT	-



ITEM NAME	WEDGE ONLY
FINISH	-
WEIGHT	-



ITEM NAME	PROP SLEEVE, SLEEVE NUT WITH HANDLE, G PIN, FLOWER PLATE
WEIGHT	300 To 550 gm



ITEM NAME	LIMPET COUPLER
FINISH	-
WEIGHT	-



ITEM NAME	FORMWORK WEDGE CLAMP FORGED
FINISH	-
WEIGHT	2.400 kg



ITEM NAME	FALL ARREST BRICK GUARD
FINISH	-
WEIGHT	-



ITEM NAME	SPRING BOARD CLAMP
FINISH	-
WEIGHT	-



ITEM NAME	WEDGE/ STUB PIN SET
FINISH	M16 x 52
WEIGHT	-



ITEM NAME	Q BRACE U BOLT CLAMP
FINISH	M8, M10 x 32-65mm
WEIGHT	-



ITEM NAME	SCAFFOLDING WHEEL WITH BRAKE
FINISH	8"
WEIGHT	-

PVC CAPS & NYLON ANCHORS.



***Fasten
with
Precision***



PVC CAPS



ITEM NAME	PVC BOLT CAPS- WHITE/ GREY/ BLACK
FINISH	PVC
SIZE	M6 to M36



ITEM NAME	PVC THRD BAR END CAPS- RED / BLACK
FINISH	PVC
SIZE	M4 to M20



ITEM NAME	PVC HEX SDS SCREW CAPS- WHITE/ OFF- WHITE/ BEIGE/ GREY
FINISH	PVC
SIZE	#14 SCREW



ITEM NAME	NYLON NUT
FINISH	PVC
SIZE	M6 to M16



ITEM NAME	NYLON WASHER
FINISH	PVC
SIZE	M6 to M24



ITEM NAME	RUBBER WASHER
FINISH	PVC
SIZE	M6 to M24



ITEM NAME	WALL PLUGS - LIP / W.O LIP
FINISH	PVC
SIZE	S6 to S16



ITEM NAME	NYLON FRAME FIXING - WING TYPE
FINISH	PVC
SIZE	M8x60 to M10x160



ITEM NAME	NYLON HAMMER FIXINGS- NAIL ANCHOR
FINISH	PVC
SIZE	M6x40 to M6x80



ITEM NAME	HUMP ANCHOR
FINISH	PVC
SIZE	M14x100



ITEM NAME	PVC ROUND & SQUARE CAPS
FINISH	PVC
SIZE	Round- 20mm to 114mm Rectangle- 40x60 to 60x120 Square- 20x20 to 80x89



ITEM NAME	2 NUT / WASHER ANCHOR BOLT CAP
FINISH	PVC
SIZE	M12 to M34

FENCING ACCESSORIES



***Fasten
with
Precision***



FENCING ACCESSORIES



ITEM NAME	DOUBLE CLAMP
FINISH	GI/HDG/ Green Powder Coated
SIZE	42 to 114 mm



ITEM NAME	BRACE BAND
FINISH	GI/HDG/ Green Powder Coated
SIZE	42 to 114 mm



ITEM NAME	TENSION CLAMP
FINISH	GI/HDG/ Green Powder Coated
SIZE	42 to 114mm



ITEM NAME	RAIL END
FINISH	HDG/ Green Powder Coated
SIZE	42 to 114mm



ITEM NAME	POST CAP
FINISH	Green PVC/HDG/P.C
SIZE	42 to 114mm



ITEM NAME	PVC ECO FENCE
FINISH	WZP/YZP
SIZE	-



ITEM NAME	JOIN PIN WITH BOLT
FINISH	YZP
SIZE	-



ITEM NAME	PUTLOG COUPLER
FINISH	WZP
SIZE	-



ITEM NAME	FENCING COUPLER
FINISH	WZP
SIZE	-



ITEM NAME	SCAFFOLDING COUPLER
FINISH	YZP
SIZE	-



ITEM NAME	SHORT WINDER
FINISH	HDG/Green P.C
SIZE	-



ITEM NAME	EYE BOLT WITH LOOP NUT
FINISH	WZP/HDG
SIZE	M10x100-220mm LONG

U-BOLT (TO GRIP PIPE)

DIMENSION HOW TO MEASURE DESCRIPTION:-

Thread Length:- The length of the threaded portion from the bottom of the leg upward.

Rod Dia:- The thickness of rod using a caliper or ruler.

Inside Width:- Distance between side legs between threads.

Height of the U-bolt:- The Height from centre of U bolt to end of the rod.

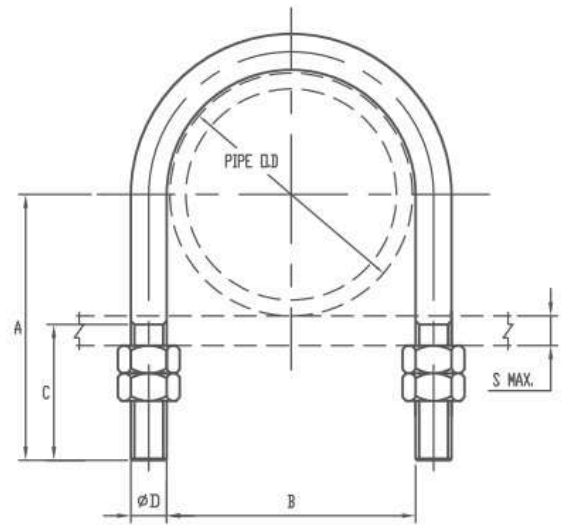

GRIP TYPE U-BOLT

S.No	Pipe Size (Inches)	Pipe OD	Dia D	A	B	C	S Max
1	1/2"	21.3	8	35	22	25	7
2	3/4"	26.9	8	42.5	27	25	10
3	1"	33.7	8	42.5	37	25	10
4	1-1/4"	42.4	8	47.5	47	25	10
5	1-1/2"	48.3	10	60	50	35	16
6	2"	60.3	10	62.5	65	35	16
7	2-1/2"	76.1	12	85	78	45	19
8	3-1/4"	88.9	16	97.5	89	50	19
9	4"	114.3	16	107.5	119	50	19
10	5"	139.7	16	120	144	50	19
11	6"	168.3	20	140	170	55	19
12	7"	193.7	20	152.5	195	55	19
13	8"	219.1	20	172.5	225	55	19
14	9"	244.5	20	175	250	55	22
15	10"	273	20	200	280	60	22
16	12"	323.9	20	225	330	60	22
17	14"	355.6	24	247.5	361	65	22
18	16"	406.4	24	282.5	411	65	22
19	18"	457	24	297.5	461	70	22
20	20"	508	24	330	516	70	22
21	22"	559	24	355	566	70	22
22	24"	610	24	380	616	70	22

COMPREHENSIVE LIST OF COMMON FASTENERS, SCREWS, ANCHORS, BOLTS, NUTS, AND WASHERS (DIN STANDARDS)

DIN No.	Description / Details	DIN No.	Description / Details
DIN 84	Slotted cheese head screw	DIN 6330	High hexagon nut
DIN 85	Slotted pan head screw	DIN 6331	High hexagon nut with collar
DIN 912	Hexagon socket head cap screw	DIN 125	Flat washer, form A
DIN 931	Hexagon head bolt, partial thread	DIN 126	Flat washer, form B
DIN 933	Hexagon head screw, full thread	DIN 127	Spring lock washer, split
DIN 7991	Hexagon socket countersunk head screw	DIN 128	Spring washer, curved or wave form
DIN 963	Slotted countersunk flat head screw	DIN 9021	Large series flat washer
DIN 964	Slotted raised countersunk head screw	DIN 6916	High-strength structural washer
DIN 965	Cross recessed countersunk flat head screw	DIN 433	Small flat washer for screws
DIN 966	Cross recessed raised countersunk head screw	DIN 7349	Heavy-duty washer for bolts
DIN 7985	Cross recessed pan head screw	DIN 6796	Serrated lock washer
DIN 7981	Self-tapping screw, pan head	DIN 6797	Locking washer with external teeth
DIN 7982	Self-tapping screw, countersunk head	DIN 7	Cylindrical dowel pin
DIN 571	Hexagon head wood screw	DIN 6325	Hardened ground dowel pin
DIN 603	Carriage bolt, round head, square neck	DIN 660	Round head solid rivet
DIN 604	Round head bolt with square neck	DIN 7337	Blind rivet
DIN 605	Round head bolt with short square neck	DIN 529	Anchor bolt (foundation bolt)
DIN 607	Flat countersunk head bolt with square neck	DIN 529 A	Eye bolt
DIN 609	Hexagon head bolt with reduced shank	DIN 529 C	L-anchor bolt
DIN 934	Hexagon nut, standard	DIN 529 D	U-anchor bolt
DIN 936	Hexagon thin nut (jam nut)	DIN 444	Lifting eye bolt
DIN 439	Hexagon thin nut, type B	DIN 560	Lifting eye bolt with collar
DIN 985	Hexagon nut with nylon insert (nyloc nut)	DIN 562	Lifting eye nut
DIN 980	All-metal lock nut	DIN 975	Threaded rod, continuous thread
DIN 6923	Hexagon nut with flange	DIN 976	Threaded rod, special lengths
DIN 1687	Domed cap nut	DIN 6914	High-strength hexagon bolt for structural steel joints
DIN 315	Wing nut	DIN 6915	High-strength hexagon nut for structural steel joints

THREADING PITCH

Metric Diameter	Pitch mm		Metric Diameter	Pitch mm	
	Coarse Standard	Fine Standard		Coarse Standard	Fine Standard
3mm	0.50	0.35	20mm	2.50	1.50
4mm	0.70	0.50	22mm	2.50	1.50
5mm	0.80	0.50	24mm	3.00	2.00
6mm	1.00	0.75	27mm	3.00	2.00
8mm	1.25	1.00	30mm	3.50	2.00
10mm	1.50	1.25	33mm	3.50	2.00
12mm	1.75	1.25	36mm	4.00	3.00
14mm	2.00	1.50	39mm	4.00	3.00
16mm	2.00	1.50	42mm	4.50	3.00
18mm	2.50	1.50	48mm	5.00	3.00

STANDARD CONVERSION FACTORS

INCH = 25.4 MILLIMETRE
FOOT = 0.3048 METRE
YARD = 0.9144 METRE
MILE = 1.6093 KILOMETER
ACRE = 0.4047 HECTARE

POUND = 0.4536 KILOGRAM
DEGREE FARENHEIT X 5/9 - 32 = DEGREE CELSIUS
MILLIMETRE = 0.0394 INCH
METRE = 3.2808 FOOT
METRE = 1.0936 YARD

WEIGHT CALCULATOR

MILD STEEL (MS)

SHEET

WEIGHT (KGS) = LENGTH (MM) x WIDTH (MM) x 0.00000785 x THICKNESS example. The weight of MS Sheet of 1mm thickness and size 1250 MM x 2500 MM shall be $2500\text{MM} \times 1250\text{MM} \times 0.00000785 \times 1 = 24.53\text{ KGS} / \text{SHEET}$.

MS SQUARE

WEIGHT (KGS) = WIDTH x WIDTH x 0.00000785 x LENGTH.

Example : A Square of size 25mm and length 1 metre then the weight shall be.

$25 \times 25 \times 0.00000785 \times 1000\text{mm} = 4.90\text{ kgs/metre}$

MS ROUND

WEIGHT (KGS) = $3.14 \times 0.00000785 \times ((\text{diameter} / 2) \times (\text{diameter} / 2)) \times \text{LENGTH}$.

Example : A Round of 20mm diameter and length 1 metre then the weight shall be.

$3.14 \times 0.00000785 \times ((20/2) \times (20/2)) \times 1000\text{ mm} = 2.46\text{ kgs / metre}$

MS/GI PIPE

WEIGHT/ MTR (Kgs)

$[\text{OD}(\text{mm}) - \text{Wall Thickness}(\text{mm})] \times \text{Wall Thickness}(\text{mm}) \times 0.0246615 = \text{KG/ MTR}$

SS ROUND

$\text{DIA}(\text{mm}) \times \text{DIA}(\text{mm}) \times 0.00623 = \text{WEIGHT PER METRE}$

SS / MS Pipe

$\text{OD}(\text{mm}) - \text{W.Thick}(\text{mm}) \times \text{W.Thick}(\text{mm}) \times 0.0248 = \text{Weight Per Metre}$

$\text{OD}(\text{mm}) - \text{W.Thick}(\text{mm}) \times \text{W.Thick}(\text{mm}) \times 0.00756 = \text{Weight Per Foot}$

SS / MS CIRCLE

$\text{DIA}(\text{mm}) \times \text{DIA}(\text{mm}) \times \text{THICK}(\text{mm}) \times 0.0000063 = \text{Kg Per Piece}$

SS sheet

$\text{Length}(\text{Mtr}) \times \text{Width}(\text{Mtr}) \times \text{Thick}(\text{mm}) \times 8 = \text{Weight Per Piece}$

$\text{Length}(\text{ft}) \times \text{Width}(\text{ft}) \times \text{Thick}(\text{inch}) \times 3/4 = \text{Weight Per Piece}$

S.S HEXAGONAL BAR

$\text{Dia}(\text{mm}) \times \text{DIA}(\text{mm}) \times 0.00680 = \text{Wt. Per Mtr}$

$\text{Dia}(\text{mm}) \times \text{Dia}(\text{mm}) \times 0.002072 = \text{Wt. Per foot.}$



**FAIRDEAL
HARDWARE TRADING LLC**

TOTAL FIXING SOLUTIONS

Contact Details:

 +971 4 2287267 / 2211468

 +971 55 7520381

 www.fairdealhardware.com

 info@fairdealhardware.com

 accounts@fairdealhardware.com

 Sh. Hamad - 3, Shop - 7 Baniyas Rd - adjoining to Sun And Sands Plaza Hotel, Backside of Phoenicia hotel - Deira - Riggat Al Buteen - Dubai