



ParkerStore

Your Success is our future



شركة الطاقة والتكنولوجيا التجارية ذ.م.م.
POWER & TECHNOLOGY TR.CO.L.L.C.
 HYDRAULIC | PNEUMATIC | ELECTRIC

(SHARJAH)



موشن كنترول للمعدات والالات ذ.م.م.
MOTION CONTROL
 MACHINERY AND EQUIPMENT L.L.C.

(ABU DHABI)



POWER & TECHNOLOGY TR. CO. LLC.

Established in March 2009 in Sharjah - UAE, Powertech's aim is to make procurement easier in areas of Hydraulic, Pneumatic & Electrical equipments in the automation industry.

Our mission is to acquire growth, strengthen aftermarket and proceed with innovation and continuous improvements. We are fully engaged in offering the best solution and committed to our customers as well as to our targets and goals. Innovative spirit is also a vital part of our identity; creating new ideas by setting high standards and exceeding expectations.

MOTION CONTROL MACHINERY & EQUIPMENT LLC

Established in 2018, Motion Control Machinery & Equipment LLC was formed with the vision of expanding the supply & reach of industrial products in Abu Dhabi to help customers reform their automation process using advanced technologies. Experienced in the field of Industrial automation, Motion Control strives to provide the best products and services to meet your day-to-day industrial needs.

We guarantee 24 hour response for offering the best possible services for all range of products. Our company's strength rest in our reputable service by trained specialists and technicians.

OUR PROFILE

"YOUR PARTNER IN INDUSTRIAL AUTOMATION..."





PARKER IS A LEADER IN INNOVATIVE PRODUCT DESIGN TO MEET THE MOST DEMANDING PERFORMANCE SPECIFICATIONS

7231B/7322B SERIES WATER VALVES



- High-performance valves with solid design
- 2-way pilot operated solenoid valves for water, light oils and steam
- Tested service life of over 20 million cycles
- Wide range of electrical parts can be used including ATEX, IP67, H class, reduced power, UL or VDE approved

MODUFLEX VALVES - P2M



- High flow, compact size
- Multiple value sizes
- Standalone valves, modular islands with individual, multi connector or bus connections
- Integrated selectable internal or external pilot supply and exhaust

LIMIT SWITCHES PXC

- 3/2 Nc spring return as standard
- Ø4mm, M5 & G1/8 ported versions
- Miniature and compact designs
- Wide choice of actuators include levers, rollers & ultra light whisker types



INTERFACE VALVES PS1

- High speed poppet type valves
- 3/2 & 4/2 Electro-pneumatic modules
- Push-in connections Ø4 & Ø6mm
- High performance 15mm solenoids
- Building block type modules with DIN rail mounting



METAL SPOOL VALVES - VIKING XTREME



- 4 sizes: G1/8, G1/4, G3/8 and G1/2
- Good corrosion resistance
- Wide range of 5/2 & 5/3 versions
- High and low temperature versions available for transport applications

VIKING LITE SERIES



- 3 sizes: G1/8, G1/4 and G3/8
- Robust, versatile and combines large flow capacity
- Fitted with dynamic bi-directional spool seals
- For pressures up to 10 bar



شركة الطاقة والتكنولوجيا التجارية ذ.م.م.
POWER & TECHNOLOGY TRD.CO.L.L.C.
HYDRAULIC | PNEUMATIC | ELECTRIC

PARKER

PARKER HAS BEEN DOING
IT FOR 100 YEARS



- Mini vacuum generators
- Compact "air saver" vacuum generators
- Multi-functional vacuum generators with holding
- Value & rapid release options
- Wide range of suction cups
- Wide range of materials

VACUUM

DX ISO VALVES

- ISO sizes 02, 01, 1, 2 & 3 sub base & manifold mounted valves
- ISO 5599-1 & ISO 15470-1
- Excellent reliability in excess of 100 million cycles
- High flow performance & quick response times
- Ceramic slide technology operates on Lubricated or non-lube air



FRL COMBO - P32/P33 SERIES

- Compact and versatile
- 3 piece modular mounted particulate filter, regulator and mist style lubricator
- Accurate pressure regulation
- High moisture removal efficiency
- Proportional oil delivery
- OSHA Compliant shut-off valves
- Soft-Start & Quick Dump valves



WE PRODUCE THOUSANDS OF
FLUIDPOWER COMPONENTS
AND SYSTEMS TO HANDLE
A WIDE RANGE OF
APPLICATIONS AND MOTION
CONTROL REQUIREMENTS

MODUFLEX LITE P3X SERIES

- Integral 1/2 or 3/4 ports
- High efficiency 5 micron elements as standard
- Excellent water removal efficiency
- Secondary pressure ranges 8 & 16 Bar
- Rolling diaphragm for extended life
- Membrane dryers



PUSH BUTTONS - PXB



- Facia mounted operators
- 3/2 NO and NC versions
- Pneumatic valve combinations with electrical switches
- Modular construction
- Wide choice of actuators

MODUFLEX PROPORTIONAL TECHNOLOGY

- Fast response times
- Accurate output pressure
- Micro parameter settings
- Selectable I/O parameters
- Quick, full flow exhaust
- LED display indicates output pressure
- No air consumption in steady state
- Multiple mounting options
- IP65 protection



PARKER



MOTION CONTROL
MACHINERY AND EQUIPMENT L.L.C.
PNEUMATIC | HYDRAULIC | ELECTRIC



- Parker Polyethylene (PE) Tubing is produced from resins that provide increased dimensional stability, uniformity and long-term strength
- Polyurethane tubing (PU) is flexible, kink and abrasion resistant. They are available in multiple colours for system colour coding
- Parker Nylon tubing delivers safe and flexible fluid conveying in tight spaces.

LEGRIS TUBINGS

LEGRIS FITTINGS



- Legris, a division of Parker Hannifin Group, designs, manufactures & markets innovative solutions for connecting, conveying & controlling industrial fluids
- Legris has based its development and success on essential strategic customer-focused values



OIL-X EVOLUTION

- High efficiency oil vapour removal
- Compressed air purification equipment to deliver uncompromising performance and reliability whilst providing the right balance of air quality with lowest cost of operation

AIR BELLOWS

- 10 sizes, diameters 70-660 mm
- Strokes: 45 - 375 mm
- Single, double or triple convolutions
- High thrust and frictionless movement
- Maintenance-free



- High repeatability
- High relief capacity on R220 model
- High flow capacity on R230 model

PRECISION PRESSURE REGULATORS

- Available in 32 to 125 mm bore sizes
- Smooth profile or tie-rod design
- Corrosion resistant design with end plates and barrel in sandblast and anodized aluminum
- Magnetic piston standard
- Polyurethane seal technology inside
- Cushioning stainless steel screws on same side



P1F SERIES - ISO 15552 CYLINDERS

MINI ISO CYLINDERS 6432 - P1A



- Mini cylinder according to ISO 6432
- Available in 10 to 25 mm bores
- Corrosion resistant design and low weight construction
- Magnetic piston as standard
- End stroke buffers for long service life



شركة الطاقة والتكنولوجيا التجارية ذ.م.م.
POWER & TECHNOLOGY TRD.CO.L.L.C.
HYDRAULIC | PNEUMATIC | ELECTRIC

PARKER

SERVO MOTORS AND LINEAR POSITIONERS



- Lower inertia and higher power
- Increased torque at the motor shaft
- For high speeds and accelerations
- Faster precision
- Smooth motion applications

ELECTROMECHANICAL



- Compax3 Intelligent Servo Drive - includes single & multi-axis drives as well as hydraulic controllers. It features power range from 1 to 109 kVA.
- HMI (Human Machine Interfaces) software & hardware solutions for use with motors, drives, and controllers

SERVO DRIVES AND CONTROLLERS

AC DRIVES

DRIVE ACCESSORIES

STEPPER DRIVES AND CONTROLLERS

DC DRIVES

MOBILE INVERTER DRIVES



AC/DC DRIVES

Meeting the demands of the most complex motor control applications.

- AC 690+ Series
- AC 650 Series
- AC 30 Series
- DC 590+ Series

QUICK ACTING COUPLER

- Twistlok action
- Wide choice of adaptors
- Non-whip adaptors
- Rugged design



RODLESS CYLINDERS - P1T



- Single or dual-end porting in standard endcaps
- Magnetic piston as standard
- Single or double adjustable slide bearings
- Precision, fine thread needle adjustment cushioning
- Up to 6m stroke lengths

UNIVERSAL GRIPPERS P5GC

- Compact design
- Double acting, square jaws
- Automatic grip retention by mechanical system
- Total jaw opening (180°)
- High reliability



PARKER



MOTION CONTROL
MACHINERY AND EQUIPMENT L.L.C.
PNEUMATIC | HYDRAULIC | ELECTRIC



WELCOME TO PARKER'S INVOLVEMENT TRAINING PROGRAM

Power & Technology Knowledge Center introduces the first Parker certified educational classes in the Middle East.

The Industrial Training Course involves lectures, text reference materials & class participation. The classes will help you become better designers, specifiers and maintenance technicians for motion and control equipment. Students will improve their knowledge and skill set which will be critical to perform effectively as a professional in the field.

Basic Course

Topics Covered:

- Advantages and Disadvantages of compressed air
- Comparison of Pneumatic/Hydraulic/Electrical energy
- Physics of compressed air
- Air preparation & distribution
- Pneumatic symbols and schematics
- Pneumatic valves & their construction
- Pneumatic Actuators & sensors
- Pneumatic control chain, design & operation

Advanced Course

Topics Covered:

- Time-dependent control
- Logical elements & circuits
- Sequential Control
- Motion & Command diagrams
- Performance analysis
- Circuit design & operation
- Signal interferences & cascading
- Pneumatic circuit troubleshooting



Photoelectric/Fiber Sensors
Level switches/Limit switches
Timers/Temperature Controllers
Safety/Terminal Relays
Power Supplies/UPS



MULTI-PURPOSE RELAYS

- AC/DC Voltage specifications
- Easily distinguished
- Latching levers & operation indicators
- Selection based on contact reliability
- Corrosion resistant



HUMAN MACHINE INTERFACES (HMI)

- More than 65,000 display colors TFT touch screen
- Available in sizes ranging from 3.5 to 10 inches
- Long-life LED backlight



ROTARY ENCODERS



These are electromechanical feedback device used to provide information on position, speed, count or direction.



POWER SUPPLIES

Save on space & work and achieve resistance to environments with Omron Power supplies. Its extended product line-up provides greater flexibility and support.

CDC Pneumatics is the leader in manufacture, sales and distribution with 20 years of combined knowledge & experience in the fluid power industry. CDC is in compliance with ISO 9001:2000 quality system standard. CDC Fittings & Tubings are designed to work together to allow easy insertion and removal of tubing.

CDC fittings incorporate a positive tube seal while the fitting is under pressure which allow polyurethane tubing to be used.

ONE - TWO TOUCH
FITTINGS



SPEED CONTROLLERS



PILOT CHECK
VALVES



EXHAUST VALVES
STOP FITTINGS



BRASS FITTINGS
COUPLERS/SILENCERS



STEEL FITTINGS
AND COUPLERS



PU - NYLON TUBES
HOSES & AIR GUNS



PLASTIC BELLOWS
AND FITTINGS

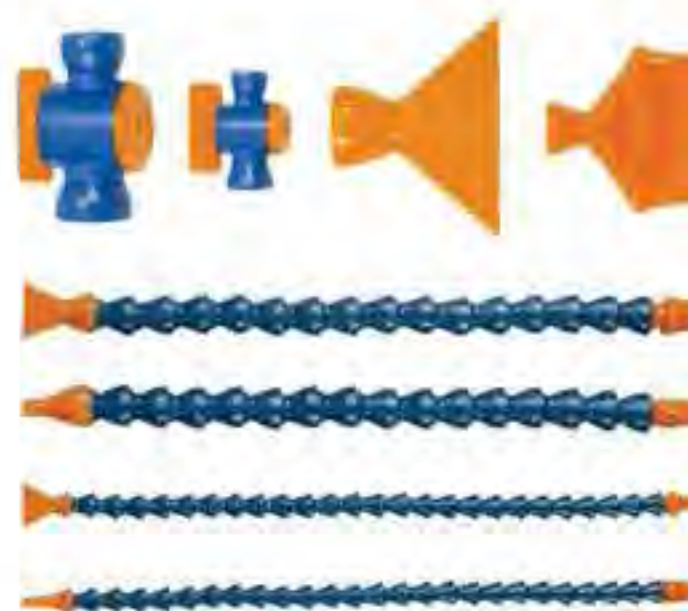



ISO-9001
QUALITY CERTIFIED

SHAKO CO. LTD. was founded in 1980 and is now one of the leading manufacturers of pneumatic components worldwide. Their product range includes Filter Regulator Lubricator Combinations, Pneumatic Solenoid Valves, Pneumatic Air Cylinders, Mechanical valves, Pneumatic press and other related valves and accessories.

All product series have been widely applied to the industrial fields of automation equipment, automotive assembly, medication and electronic machinery.



FRL Combinations



Control Valves



**Pneumatic
Air Cylinders**



**2-way
Solenoid
Valves**



Accessories



PU, NY Tubings



MOTION CONTROL
MACHINERY AND EQUIPMENT L.L.C.
PNEUMATIC | HYDRAULIC | ELECTRIC



EMPOWERED



PERFORMANCE



OMAL®
AUTOMATION

Omal was founded on December 15, 1981, in Italy with a goal to provide support in choosing the valves and actuators that best fits your needs through high technical expertise & full support during your choice.

PRODUCTS CATEGORY

BALL VALVES

BUTTERFLY VALVES

PNEUMATIC & ANGLE SEAT VALVES

PNEUMATIC ACTUATORS

ELECTRICAL ACTUATORS

LIMIT SWITCHES & POSITIONERS

PNEUMATIC
ACTUATORS



شركة الطاقة والتكنولوجيا التجارية ذ.م.م.
POWER & TECHNOLOGY TRD.CO.L.L.C.
HYDRAULIC | PNEUMATIC | ELECTRIC



OMAL

BUTTERFLY VALVES



FULL RANGE OF BALL VALVES :

- Brass Ball Valves
- Stainless Steel Ball Valves
- Cast Iron Ball Valves
- Carbon Steel Ball Valves
- PVC Ball Valves



PNEUMATIC & ANGLE SEAT VALVES



ELECTRICAL ACTUATORS



ORAL



MOTION CONTROL
MACHINERY AND EQUIPMENT L.L.C.
PNEUMATIC | HYDRAULIC | ELECTRIC

Leading in Pressure and Temperature Measurement



Electronic pressure measurement
Mechanical pressure measurement
Mechatronic temperature measurement
Mechatronic pressure measurement
Electrical temperature measurement



PNEUMATIC BALL, TURBINE AND HAMMER VIBRATORS

Industrial pneumatic vibrators feature a wide range of force ranges & construction types for handling material flow challenges. Pneumatic vibrators are most commonly used as discharge & material flow aids on small to medium-size bins, hoppers and chutes. They are used in a variety of applications within the chemical, foundry and concrete industries. The bodies are designed to quickly and easily mount to equipment.

DURABLE - Designed and constructed for continuous duty vibration.

SAFE - Options provided to reduce noise levels while pneumatic power allows for operation in hazardous areas

VERSATILE - Wide range of vibration intensities and design types allow for flexibility in mounting angles, force outputs, material loads & applications

EASY - All Pneumatic vibrators come with mounting fasteners for quick set-up



Contact us now to find out how our Pneumatic vibrators can best suit your needs.



The JORC organization creates and develops innovative products within the scope of compressed air condensate management and air leak prevention. We are determined to become & remain your innovative and reliable partner offering true value to the compressed air industry. Exceeding your expectations is what we like to do best and we achieve this by offering you:

- Creative designs and innovative features
- Products that offer both reliability and durability
- Quick deliveries

We specialize in a specific group of products which are divided into the following categories:

- Condensate cleaners (Oil/Water separators)
- Intelligent (Zero air loss) condensate drains
- Timer controlled condensate drains
- Motorized ball valve condensate drains
- Multi-point timer controlled condensate drains
- Air saving products



MOTION CONTROL
MACHINERY AND EQUIPMENT L.L.C.
PNEUMATIC | HYDRAULIC | ELECTRIC

JFLO®

Lifeline for Modern Machines...

TESTED SERVICE LIFE OF UPTO 20 MILLION TIMES!

- Customized Buckle color
- Snap-in connection
- Tight structure
- New clamping slot type
- Strong load ability

JFLO was founded in 2006 with an aim to specialize in developing, manufacturing and selling products for industrial automation equipment electric protection system, mechanical orbit protection and machine coolant systems.

With a large R&D & moulding center, JFLO has established branches and distributors all across the globe for its wide reach and supply.

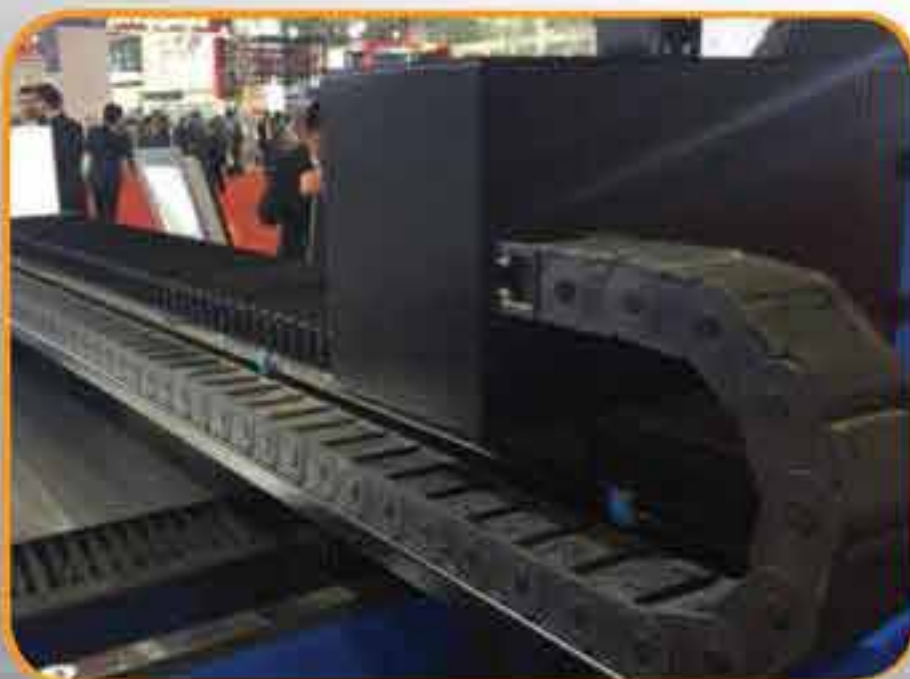

ADJUSTABLE COOLANT HOSES



Coolant Hoses are made of high quality engineering plastics. Its various sections are made of precision injection molding process and contact surface of all connective nodes are made using high injection molding technology after precise calculation.

These adjustable flexible pipes are specially designed to allow coolant flow right on the tool. These pipes help clients in the chemical industry to make huge savings by its efficient application.

BELLOW COVER



Bellows are widely used in industrial and mechanical applications such as rod boots, machinery way covers, lift and rail covers to protect rods, bearings and seals from dirt and abrasion.

Designed to protect guide-ways and machine components, these products are constructed using lightweight material that are ideal for fast travel applications.



JFLO®



MOTION CONTROL
MACHINERY AND EQUIPMENT L.L.C.
PNEUMATIC | HYDRAULIC | ELECTRIC

Welcome to the world of Phoenix Contact...

A world of electrical connection between conductors and printed circuits boards, a world of automation technology and signal level matching and a world of surge protection.

Over 12,800 Phoenix employees work in partnership with clients to create innovative products for markets across the world.

Modular Terminal Blocks

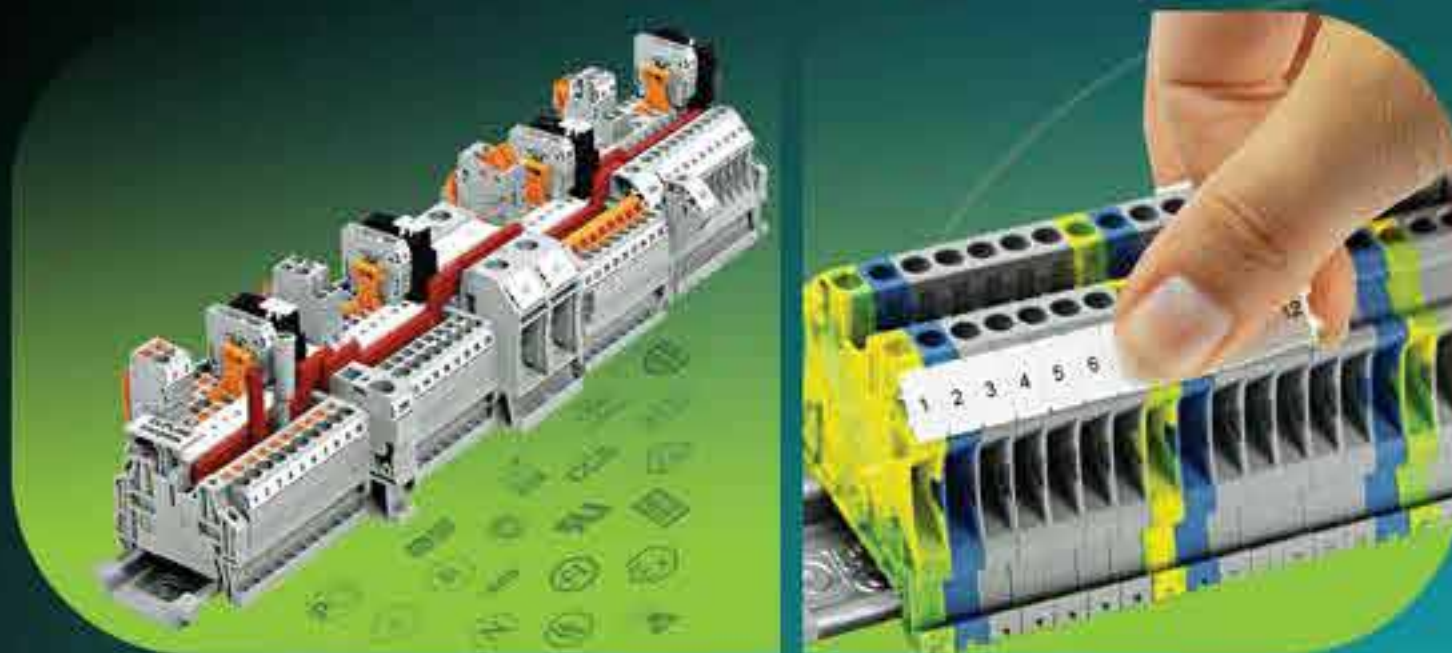

From modular terminal blocks to mounting materials and tools and through to the complete PC-aided project planning and marking system, everything that you need for perfect control cabinet wiring can be found under CLIPLINE.

From high-quality standard modular terminal blocks to sector-specific connecting terminal blocks, Phoenix Contact has the ideal solution for all of your requirements.

Choose from the following range:

- Screw connection, Spring-cage Technology
- Push in Technology, Bolt Connection Technology
- Quick Connection Technology

Systematic Marking & Labelling



Professional labeling of individual components in the control cabinet is a major pre-requisite for specific and reliable work.

Phoenix Contact offers a wide range of marking and printing materials for:

- Terminal block marking
- Marking of cables and conductors
- Marking of systems and control cabinets

The complete range can be labeled using only one computer-controlled system.

Industrial Communication Technology



- Industrial communication via copper, fiber optics, and wireless
- Superior system availability
- Enhanced range & speed with high-performance communication interfaces

Measurement & Control Technology



- Interference-free transmission of analog signals as well as temperature measurement in the field
- Monitor and control analog & temperature signals
- Keep an eye on energy data & process parameters at all times with products for monitoring

Uninterruptible Power supplies



Wide range of power supplies, AC/DC, DC/DC, DC-UPS, Redundancy modules for output currents from 0.5 A upto 40 A. Maximum system availability and space saving modules. High operating life time of 500,000 hours.

PLC and I/O Systems



- The latest technologies form the foundation of the IIoT for the digitalization of your systems
- Optimally coordinated PLCs, I/O systems and PLC software from a single source

Professional Tools



Good tools make work easier. For systematic work, you need tools that meet professional standards. Whether you need devices for conductor processing, screwdrivers, cutting options for mounting rails/cable channels or automatic tools & marking devices, we provide you with multiple options for successful control installation of cabinets & systems.

Industrial Plug Connectors for Control Cabinets & Devices



It is a challenge to save time and money during system installations. To achieve this, Phoenix Contact offers you a comprehensive range of industrial connectors.

Safety Relays / Timer Relays



Timer/Safety relays enable you to easily & inexpensively implement time control applications ranging from a few milliseconds to several days.

More Cost

Effective sensing solutions?

Autonics

is the answer

It's wide variety of proximity sensors are designed to provide more reliable and cost-effective sensing solutions in the industrial automation field.



30 year history in the process of developing new and advanced technology of its own to satisfy their customers around the world. Autonics is now a total solution provider in sensors & controllers offering more than 5,000 items in various fields of industrial automation!



OUR PRODUCTS

Counter Timer

Timer

Temperature Controller

Power Controller

Panel Meter

Pulse Meter

Display Unit

Sensor Controller

Switching Power Supply

Proximity Sensors

Photo Electric Sensors

Door Sensors

Area Sensors

Fiber Optic Sensor

Pressure Sensor

Rotary Encoders

Stepping Motor

Vision Sensors

Motion Controller

Graphic Panel

Field Network



Autonics



MOTION CONTROL
MACHINERY AND EQUIPMENT L.L.C.
PNEUMATIC | HYDRAULIC | ELECTRIC

INDUSTRIAL GAS SPRINGS BY

Automotive Industry

Furniture Industry

Marine Industry

*Food Industry & many other
industrial applications*



VAPSINT
Extend your ideas

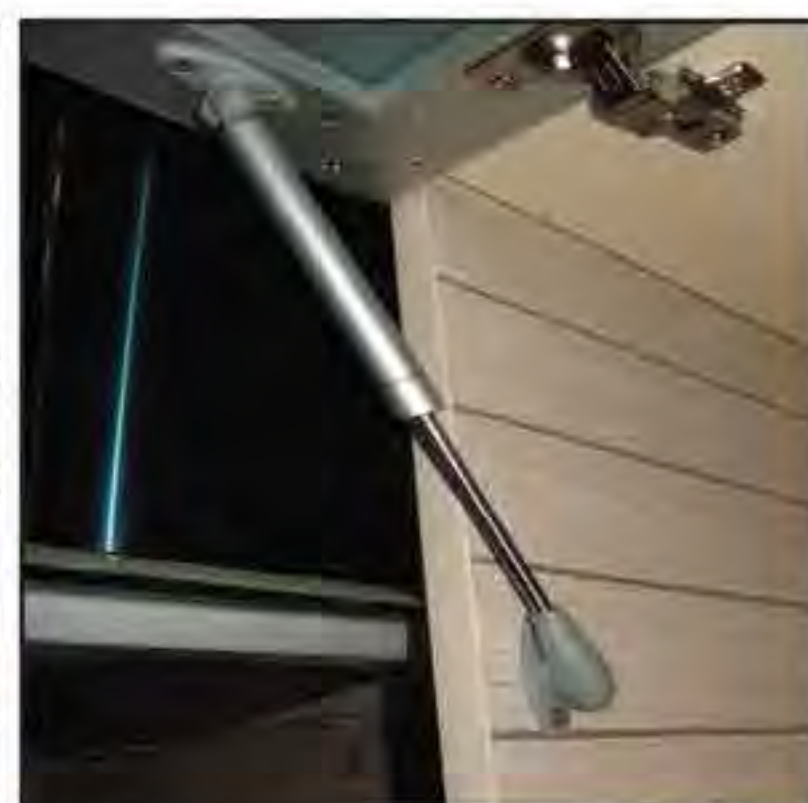

What Else We Do?

Powertech Automation Services is a fast growing system integrator focusing on innovative solutions that combine powerful software design with latest Automation technology.

The way we work

Forming successful CLIENT relationship is our single biggest objective, one which opens channels of communication for successful engineering implementation. Our Team leaders stay with the project from concept to commissioning and beyond, providing essential continuity for every aspect of the application.



Scope of Activities

We undertake small and large engineering projects of:

- ✍ Control Panels (PLC & HMI, etc.)
- ✍ Annual Maintenance Contract (AMC)
- ✍ Power Distribution Panels (DB, SMDB, MDB, etc.)
- ✍ Batch Control Systems
- ✍ Motor Control Panel (VFD, Soft Starters, Star Delta, etc.)
- ✍ Complete assembly of pneumatic control panels
- ✍ Designing, modification & troubleshooting for Hydraulic, Pneumatic and Electrical based industrial automated machineries
- ✍ Crimping & Hose assembly for Hydraulic Mobile applications
- ✍ Designing and installation of Hydraulic Power pack units
- ✍ Air Leak detection service for complete line of process industry
- ✍ Air Purification solutions (Dryers, Water separators & High precision filters)
- ✍ Piping Project (Legris Transair Technology)

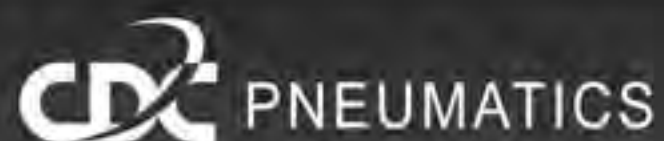

LOCATION MAP

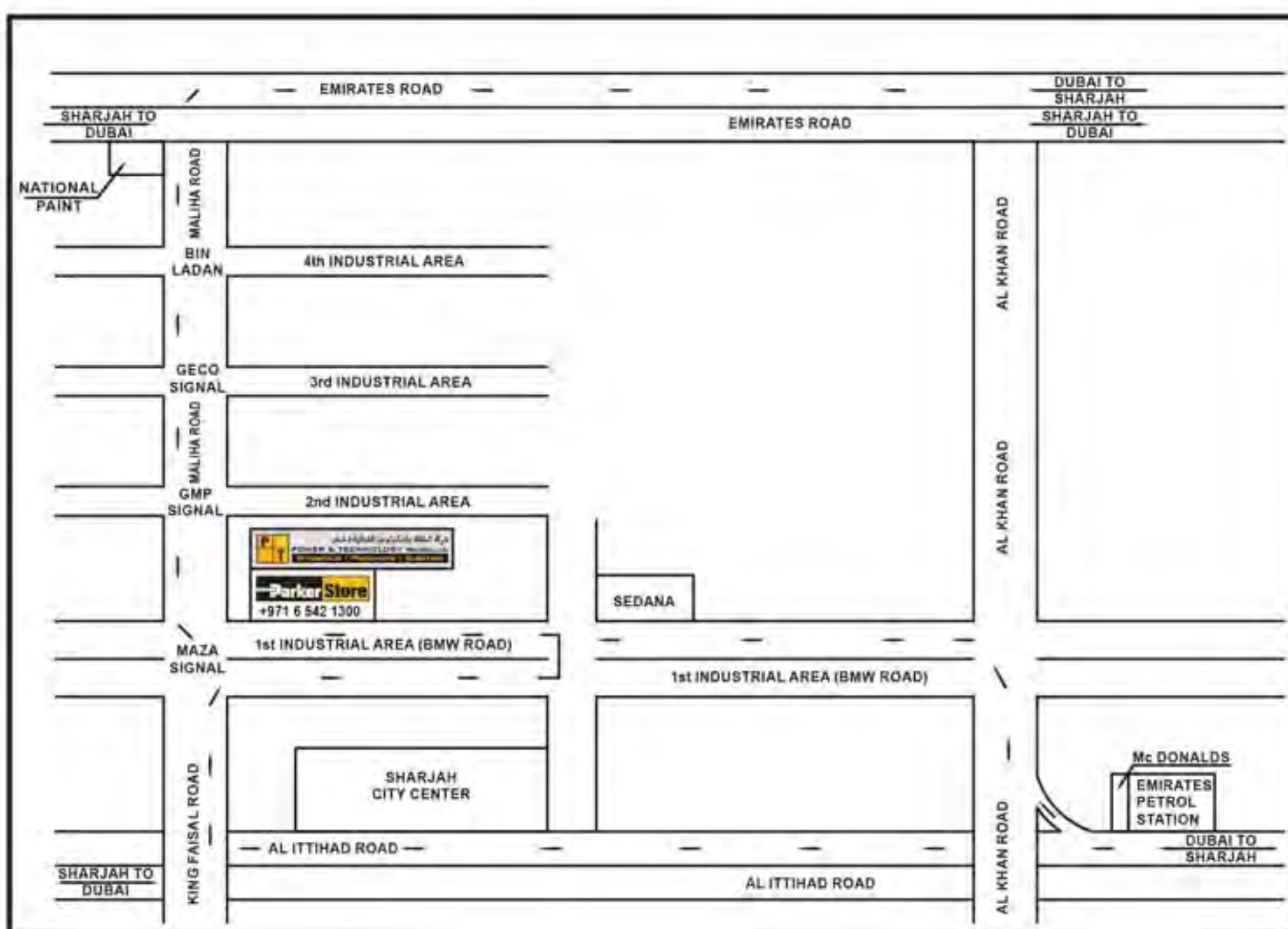

SHARJAH OFFICE

Power & Technology Tr. Co. LLC.
 Tel.: + 971 6 542 1300
 Fax: + 971 6 542 3700
 Email: sales@powertech.ae

Location :

Shop No.1, Salehi Building,
 1st Industrial Street,
 Industrial Area 2,
 Sharjah, United Arab Emirates

Mailing Address :

P. O. Box: 33372
 Sharjah, United Arab Emirates

www.powertech.ae

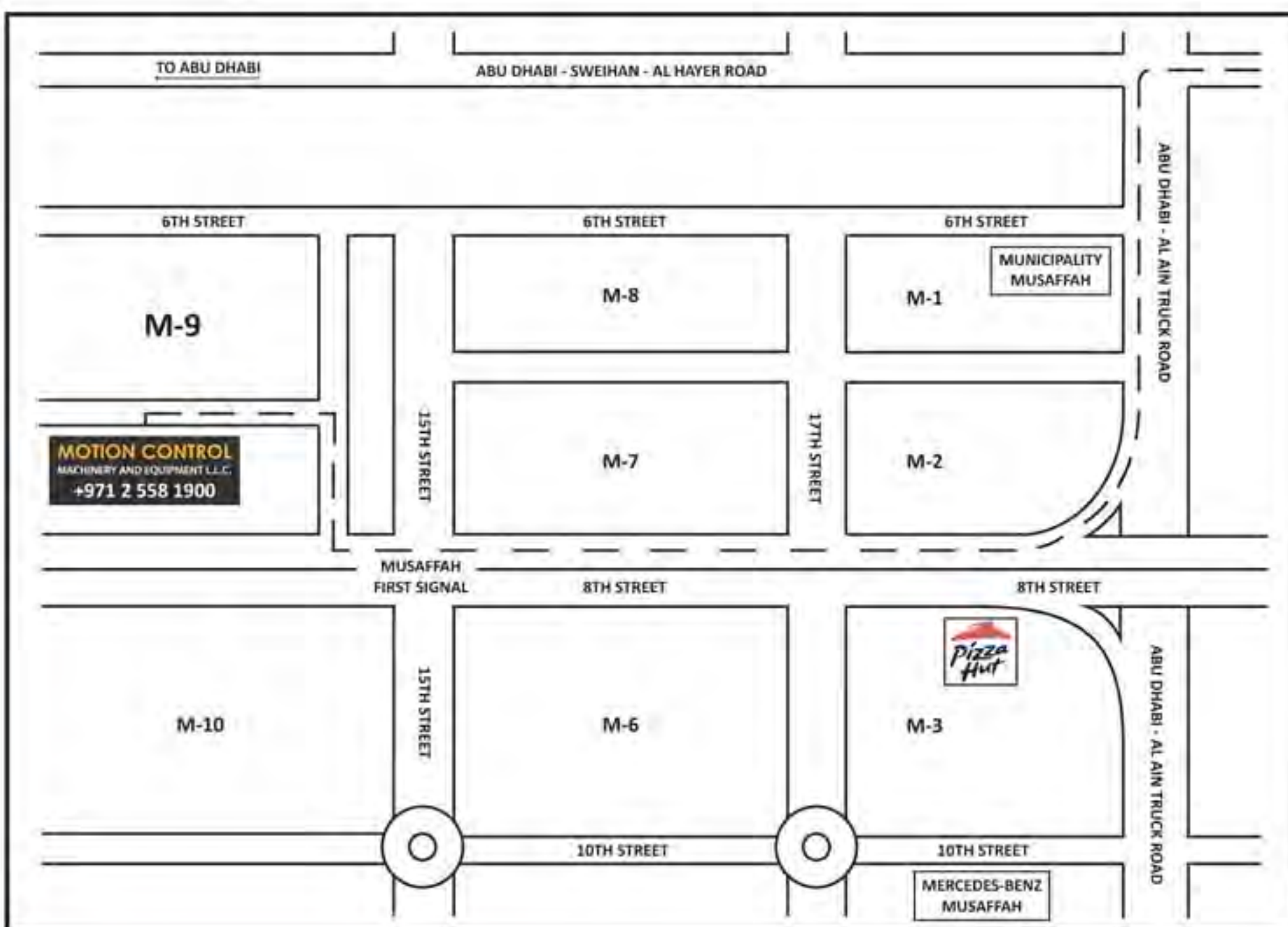

ABU DHABI OFFICE

Motion Control Machinery &
 Equipment LLC
 Tel.: + 971 2 558 1900
 Email: sales@motioncontrol.ae

Location :

Shop No.16, Plot No.23,
 Mussafah Industrial Area M9,
 Abu Dhabi, United Arab Emirates

Mailing Address :

P. O. Box: 18128
 Abu Dhabi, United Arab Emirates

www.motioncontrol.ae