



الشايح للمشاريع
ALSHAYA ENTERPRISES

Interiors. Designed. Delivered.

Agenda

1. Our Family

The Alshaya Group

2. Our Business

Alshaya Enterprises

3. Our Team

Warehouse Sector

Our Family – AlShaya Group

Introducing Alshaya Group

First established in 1890 in Kuwait, Alshaya Group is a dynamic multinational business and family owned enterprise.

Alshaya brings a rich choice of world-leading brands, services and experiences to millions of customers across the Middle east & North Africa, Russia, Turkey, Europe and beyond.

Alshaya Portfolio extends across retail, food, leisure and hospitality, through to property investment, interior solutions, joint ventures and mall developments – delivered by combined team of 60,000 people.



Our Family – AlShaya Group History

Our History

1890

The Alshaya family establish their business in Kuwait and grow steadily over the years. Their name becomes a byword for trading and commerce in the region.

1950

As the company successfully expands, the 1950's sees the creation of Alshaya Enterprises.

1970-1990

Alshaya Enterprises expands into shelving and refrigeration equipment and services.

Delivering stable growth

Founded on our heritage

From humble beginnings

With a clear vision

The Enterprises business continues to expand its portfolio, adding commercial kitchen, laundry, and bakery solutions.

1990

Alshaya Enterprises completes its interior offering by expanding into lighting and furniture, and establishes its residential businesses catering to home owners.

2000- 2010

Alshaya Enterprises stands out as one of the Gulf's premier commercial establishments. Employing more than 1,000 professionals in 6 countries.

Today

About Alshaya Enterprises



Our Values

- "Integrity" Heritage, Ethical, Authentic. Be Alshaya.
- "Commitment" Passion & perseverance, be accountable.
- "Creativity" Leadership, Trendsetter, Create Solutions
- "Customer Focus" Add value to our customers through our actions.



Mission

To Deliver an Excellent Customer Experience by Providing Innovative Solutions From our Professional Team.



Vision

To be the Leading Brand, Providing Customer-Driven Solutions for Residences and Projects.

Our Family – AlShaya Group

+60,000

Employees in Alshaya

+120

Brands across the group

+4,000

Retail stores in the Middle East

+1.2MM2

Size of retail space

Alshaya Enterprises



Alshaya Investments & Others



Alshaya Retail



(90+ Industry leading Brands)

Alshaya Properties



Currently: Kuwait, Bahrain
Upcoming: Jeddah, Dammam, Riyadh, Egypt



50 planned Hampton developments



A fully integrated design & build consultancy specializing in interiors.

Alshaya Investments & ventures in Automotive, Construction, and Others.

Global leader & innovator in retail franchising, operating over 90 brands.

Owner and operator of leading Mall and Hotel chains across the Middle East.

ALSHAYA ENTERPRISES

Warehouse Sector

Racking & Shelving

Automated & Non Automated

Doors

All types of Industrial doors

Loading Bays

Dock Levelers, Shelters & Bumpers

WAREHOUSE

SECTOR

Racking

Our Racking division specializes in warehouse systems, turn-key and rack-clad warehousing, and cold-rooms.

Our consultants are **experts in storage solutions** with solutions ranging from North America, Europe, MENA, and Asia.

With prestigious references across the GCC, our Racking team can provide **tailored solutions** for any project requirement.

Specialized In:

- Manual Storage Systems
- Semi Automated Storage Systems
- Automated Storage Systems
- Industrial & Commercial Doors
- Dock Levelers & Loading Equipment
- Material Handling Equipment



Alshaya Enterprise – Warehouse Sector

Bolt Free Shelving

An excellent storage solution for medium and light loads, if they are manually handled.



Advantages

- They are highly versatile and robust.
- Easily and quickly assembled.
- Excellent loading capacity and perfect stability.
- Totally adaptable to available space.



Long-span & Heavy Shelving

Valid to store large or heavy items. An optimum solution for different and fractioned rotation items. Possibility to install walkways accessed with ladders.



Advantages

- Possibility of storing medium to heavy loads.
- Ideal option for different article types and split turnover.
- Adjustable load levels.
- Racks up to 20 m high can be built.
- A wide range of components adaptable to your needs.



Mobile Shelving System

Doubling the storage capacity saving space.
Total safety for filed material. Adequate to
file books and documents.

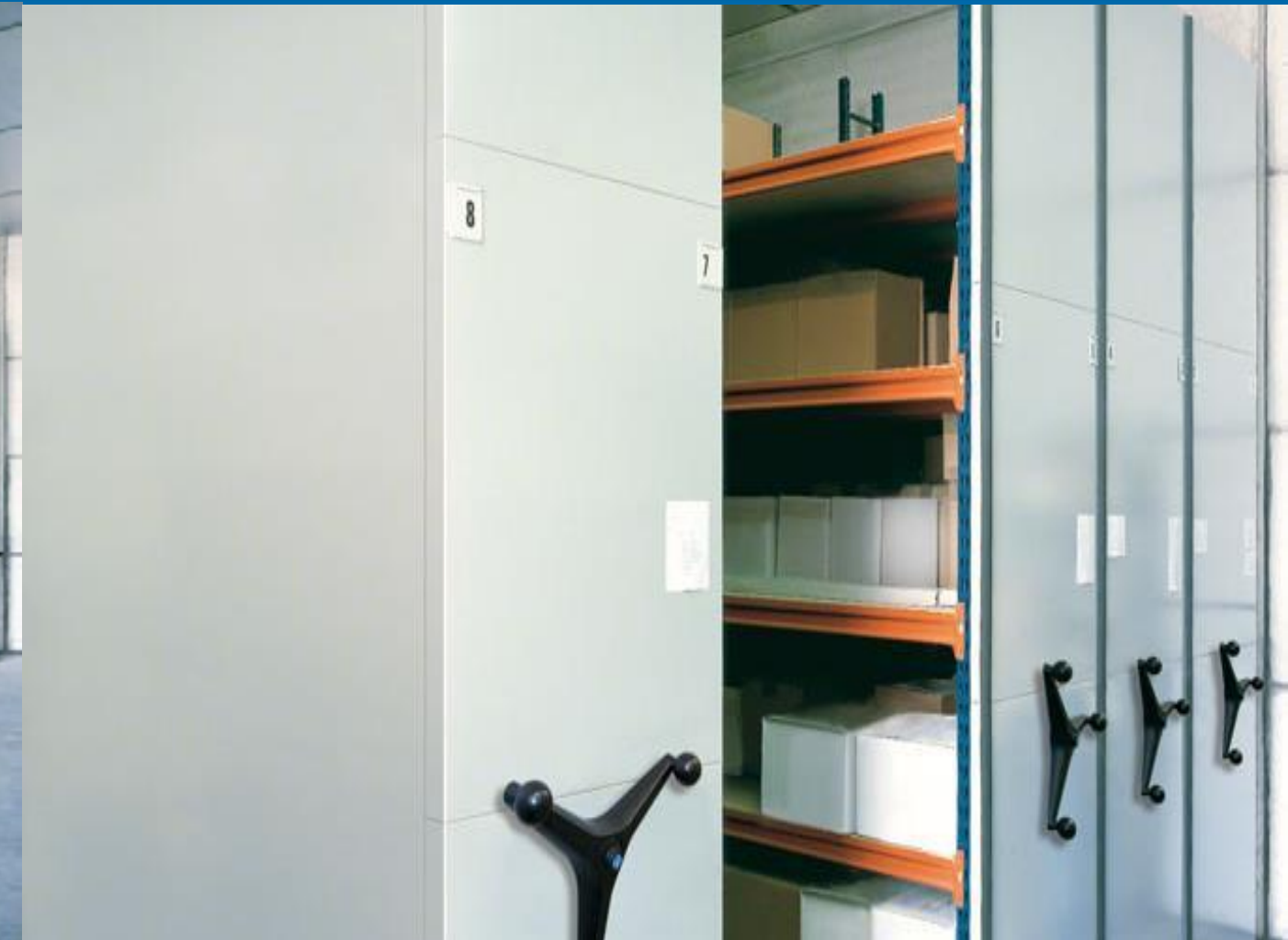

Advantages

- Great use of space as it is a compact storage system.
- Can be adapted to any available space.
- Total safety of filed materials.
- Ideal for the storage of all types of books and document.
- When the shelves reach a high height, ways fitted half-way up enabling the upper levels to be accessed can be installed.

Lockers

Lockers embrace a new concept in compact, aesthetic design that can suit any type of environment: dressing rooms, offices, schools, etc. Frames integrated into the side panels, exclusive connection systems, two options (with or without feet)... each of these elements has been carefully designed to provide high rigidity, moreover, the lockers are built using high-quality cold-rolled steel, specially treated to ensure durability and resistance.



Advantages

- New compact and attractive design.
- Extremely easy to assemble - no need for nuts and bolts.
- A modular system that allows for multiple combinations.

Conventional Pallet Racking

Excellent stock control. Adaptable to any space, weight or size. Can combine with manual picking shelves.

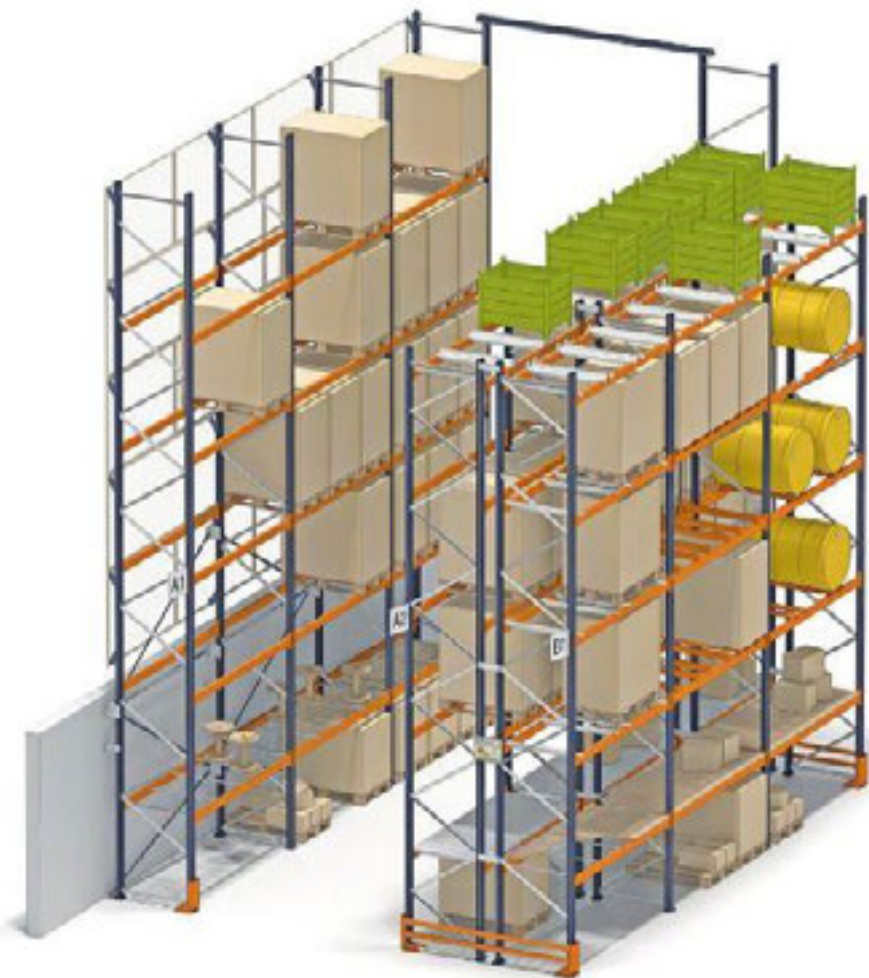

Advantages

- Total stock control: each storage space is taken up by a single pallet.
- Maximum adaptability to any load type both in terms of weight and volume.
- It can be combined with Long span beams for manual selection of goods.

Drive-in Pallet Racking

Optimizing available space.
Elimination of aisles between shelves.
Admits as many references as load lanes.



Advantages

- Maximum profitability of the available space (up to 85%).
- Removal of aisles between the ranking.
- Rigorous control of entries and exits.
- It allows as many SKU as loading lanes.

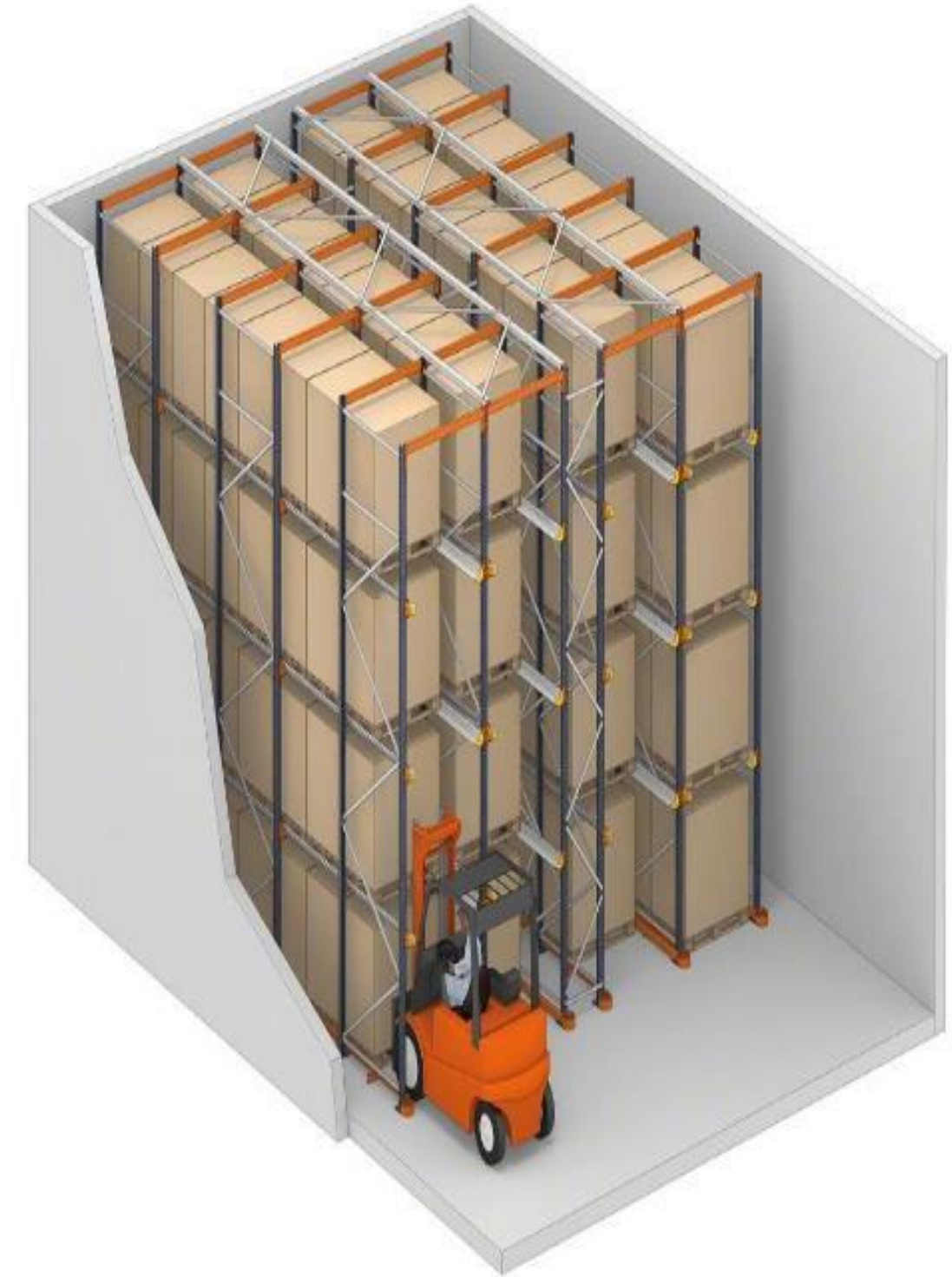

Pallet Shuttle

Compact and high capacity warehousing. Higher number of stored items. Reduction in loading and unloading times of pallets.



Advantages

- It permits the storage of different reference numbers per module.
- Efficient load and unload system, which ensures high accuracy.
- Less damage to the racking units as the forklift does not enter the racking unit.
- Higher production since the flow of incoming and outgoing good increases.

Pallet Live Storage

These racks incorporate roller track sections placed on a sloped lane to allow the pallets to slide over them. The pallets are put in at the highest part of the rolling section and move by the force of gravity and at a controlled speed towards the other end..

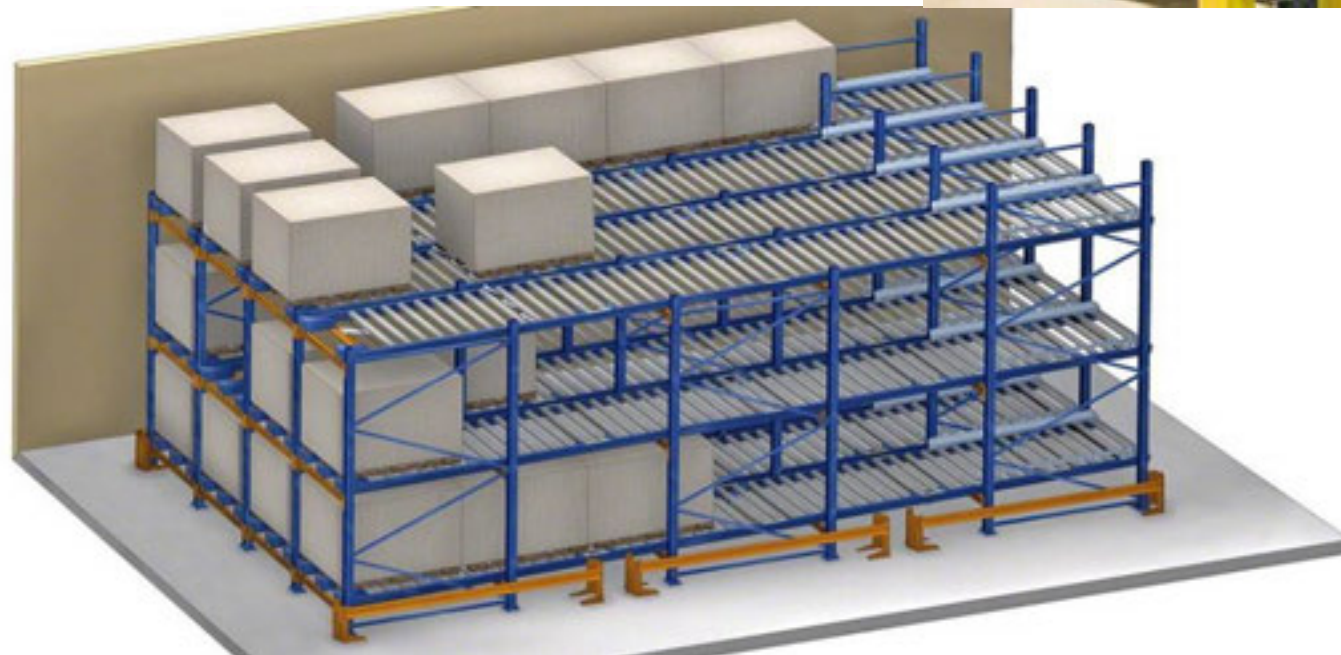

Advantages

- Enables perfect pallet turnover (FIFO SYSTEM).
- Maximum capacity as storage system is compact.
- Time and space saved in pallet handling.
- Excellent stock control.

Push Back Racking

An accumulative storage system that allows up to four pallets deep to be stored per level. All of the pallets of each level, except the top one, are placed on a set of trolleys that are pushed along rolling rails.

Push-back is ideal for storing medium-turnover products, with two or more pallets per SKU (using the Last In First Out (or LIFO) system).



Advantages

- The best possible use is made of the space available.
- Very little height space is wasted.
- Each level can be used to store a different SKU.



Cantilever Racking System

The system consists of columns with a vertical beam and one or two horizontal beams at the base to provide stability. A series of arms are attached on which the load is placed. These columns are made of hot-rolled metal beams at variable heights enabling to be fitted. Moreover, its design allows the loads to be fitted on one side of the structure only, or on both sides.

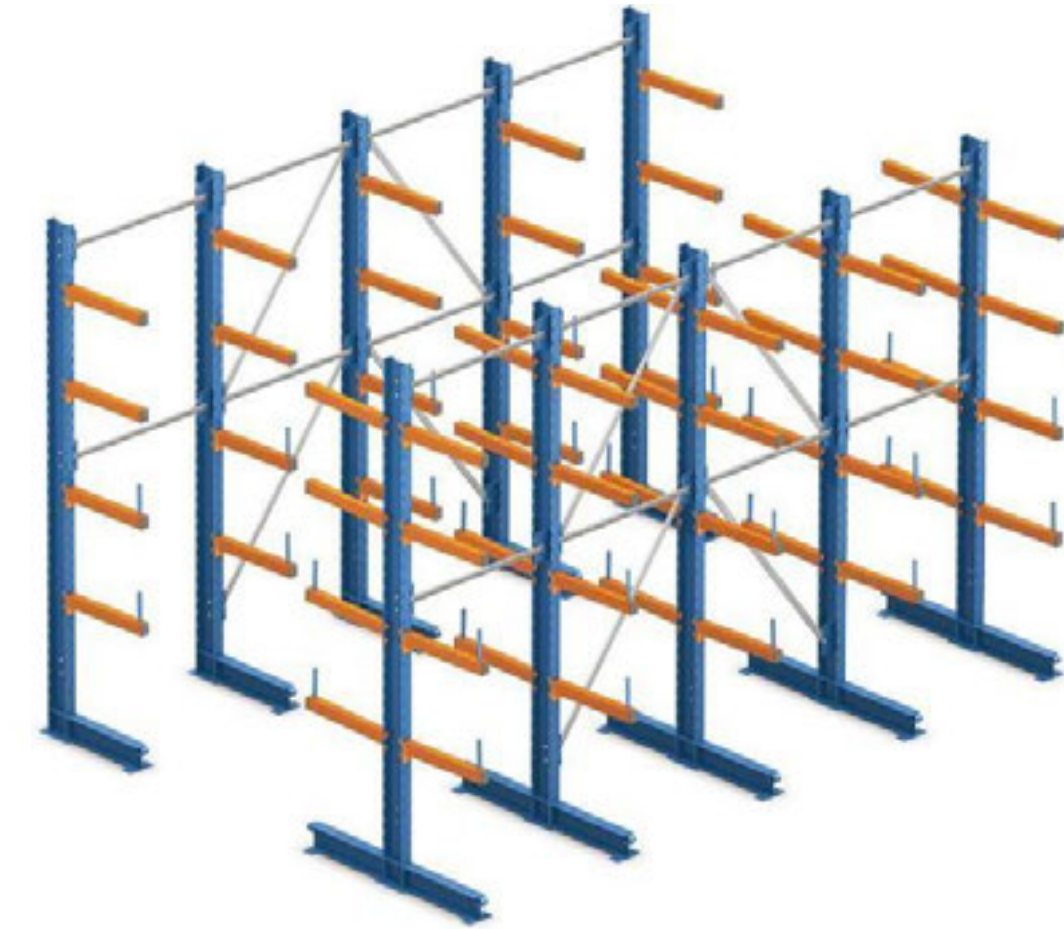

Advantages

- Easy-to-assemble. The parts are designed to allow the shelves to be assembled quickly and easily.
- Structure of great simplicity and strength.
- All the elements involved fit together easily and allow excellent mobility.

Rack Clad Warehouses

Major works of engineering in which the racking itself forms part of the construction of the building together with side and roof cladding. The ranking structure supports not only the actual goods and the different building elements but also the thrust of the handling devices and external elements: winds, heavy snowfalls, seismic movements, etc. The maximum height of clad-rack buildings is limited by local standards and by the reach height of stacker cranes or fork-lift trucks. This said, warehouses of more than 40 m high can be built.

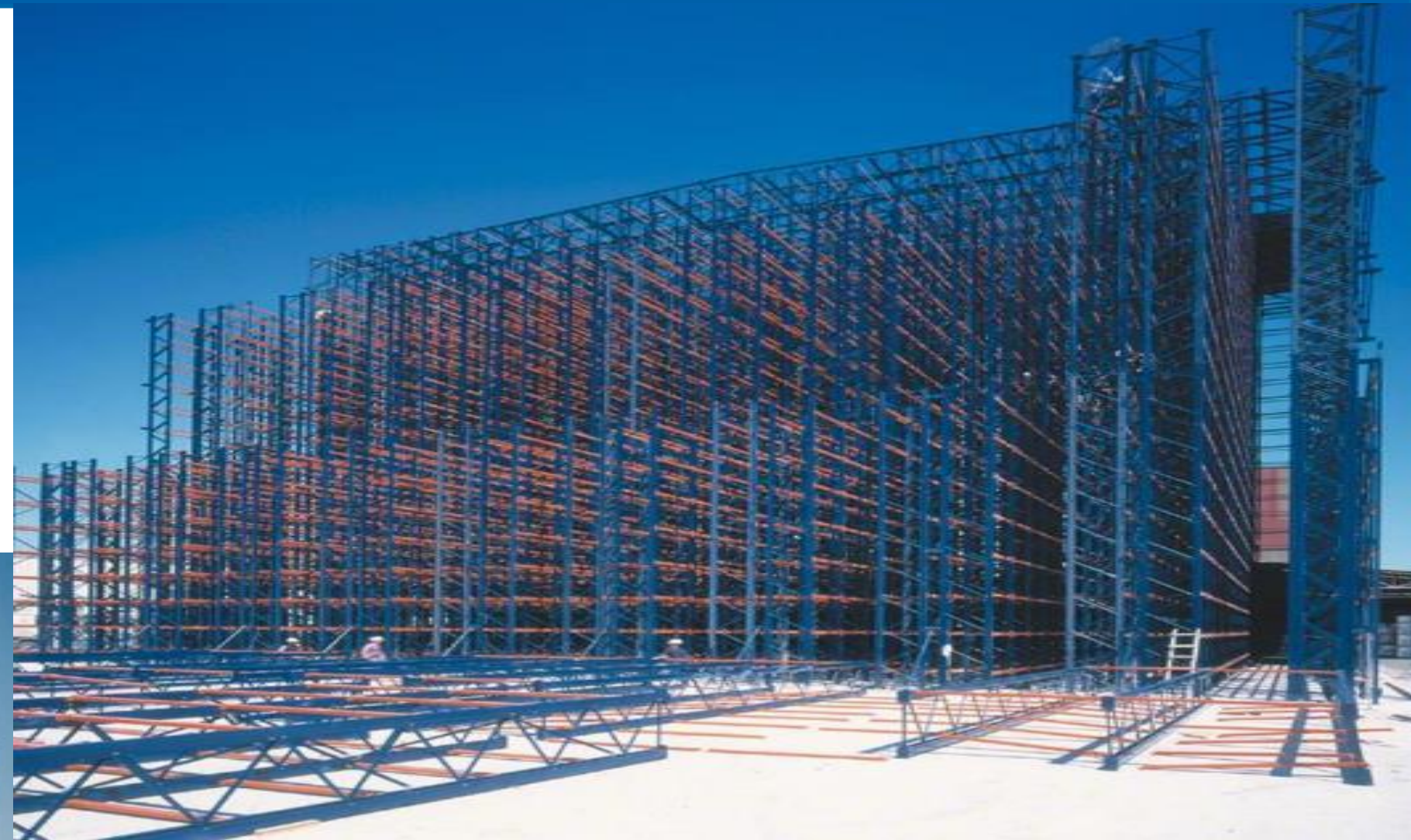
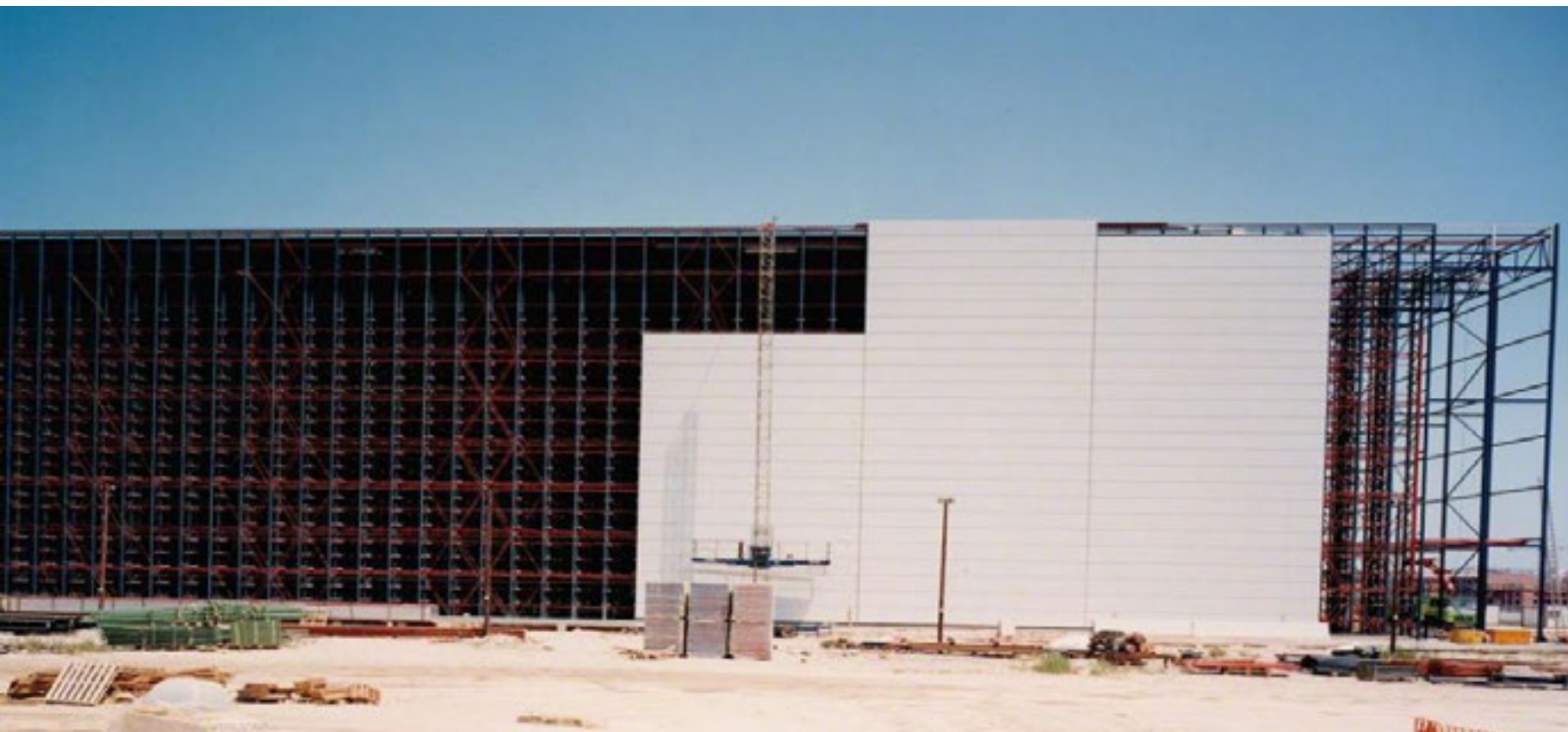

Advantages

- Storage at high height, enables maximum use of available surface area without wastage of space.
- Allows a wide range of goods to be stored.
- Conventional or automated systems can be used.

AS/RS

More than 300 automatic storage systems installed across the globe by our principals.

Our range of stacker cranes easily adapts to the needs of each warehouse

- Optimum use of the available space
- Permanent Inventory
- Productivity and excellent availability
- Employee safety
- Load Safety
- Reliability
- Reduced maintenance costs
- Reduced labor costs



AlShaya Enterprise – Warehouse Sector

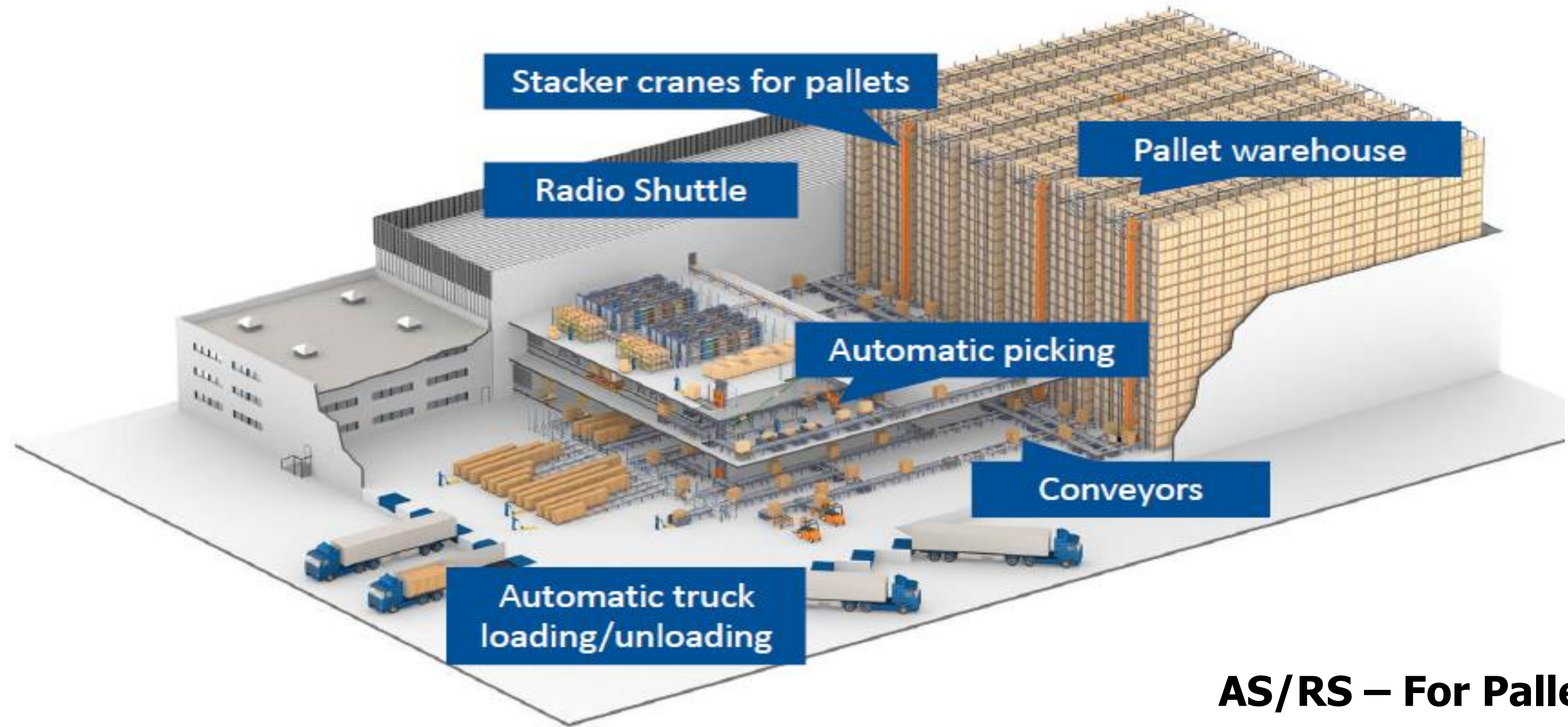

AS/RS – For Pallets

AlShaya Enterprise – Warehouse Sector

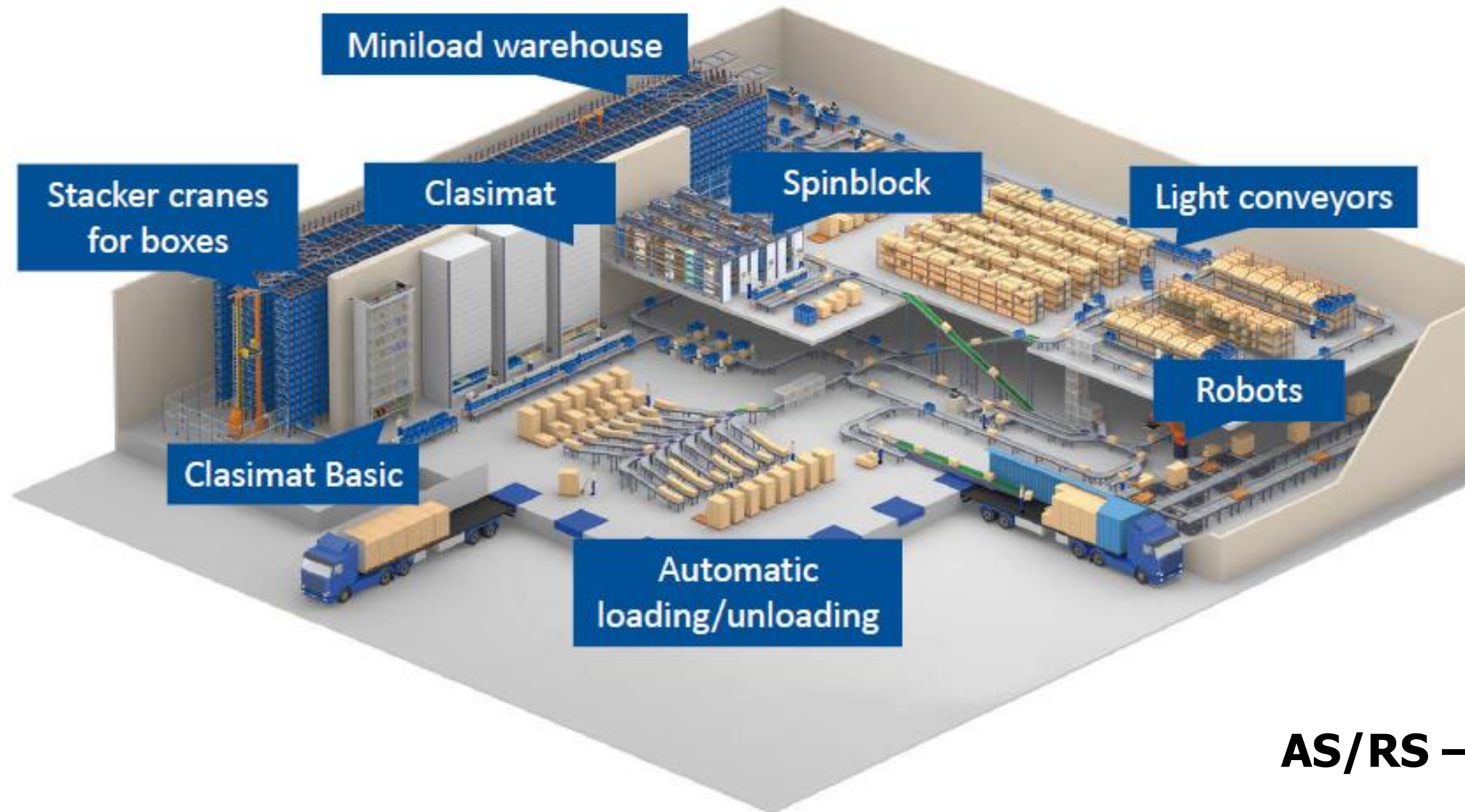

AS/RS – For Boxes

Doors & Loading Equipment

- Doors, Docks and dock shelters
- High Speed doors
- Dock shelters
- Sectional doors
- Docks
- Lifting tables and portable ramps
- Accessories

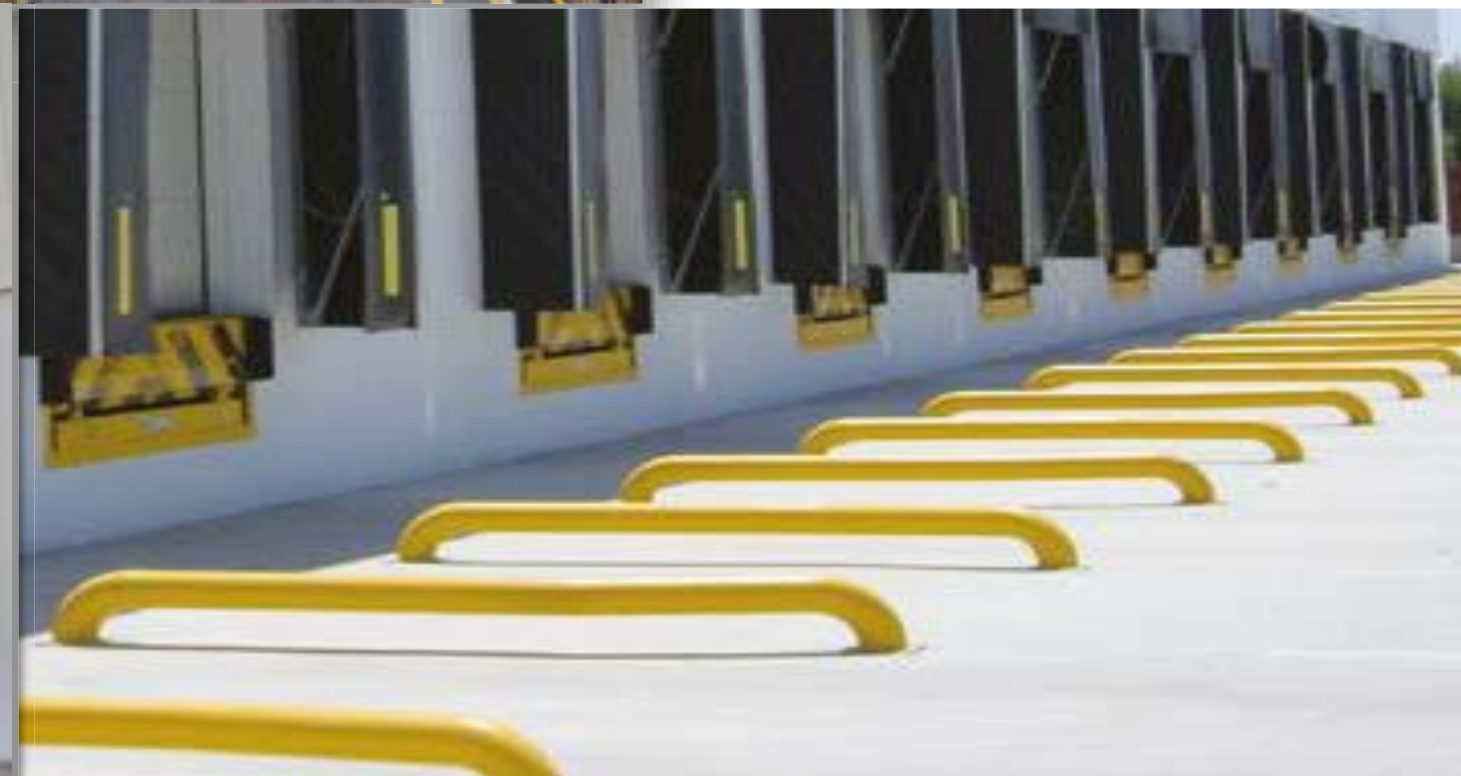

Representing Leading global brands



MECALUX
Racking & Automation Solution



ANGEL MIR
Industrial Doors & Dock Levelers



Gokcelik
Racking Solutions

And many more exclusive tie-ups ...

AlShaya Enterprise – PAN EMIRATES HOME FURNISHING (UAE & QATAR)

PAN EMIRATES, one of the fastest growing furniture brands in Middle East and a 'Superbrand' awardee for 3 years selected us for supply and installation of its Multi-tier and Selective Pallet Racking. Upon successful completion, Pan Emirates awarded multiple projects across the region.

Total built up area Al Sajaa Project: 25,000 square meters

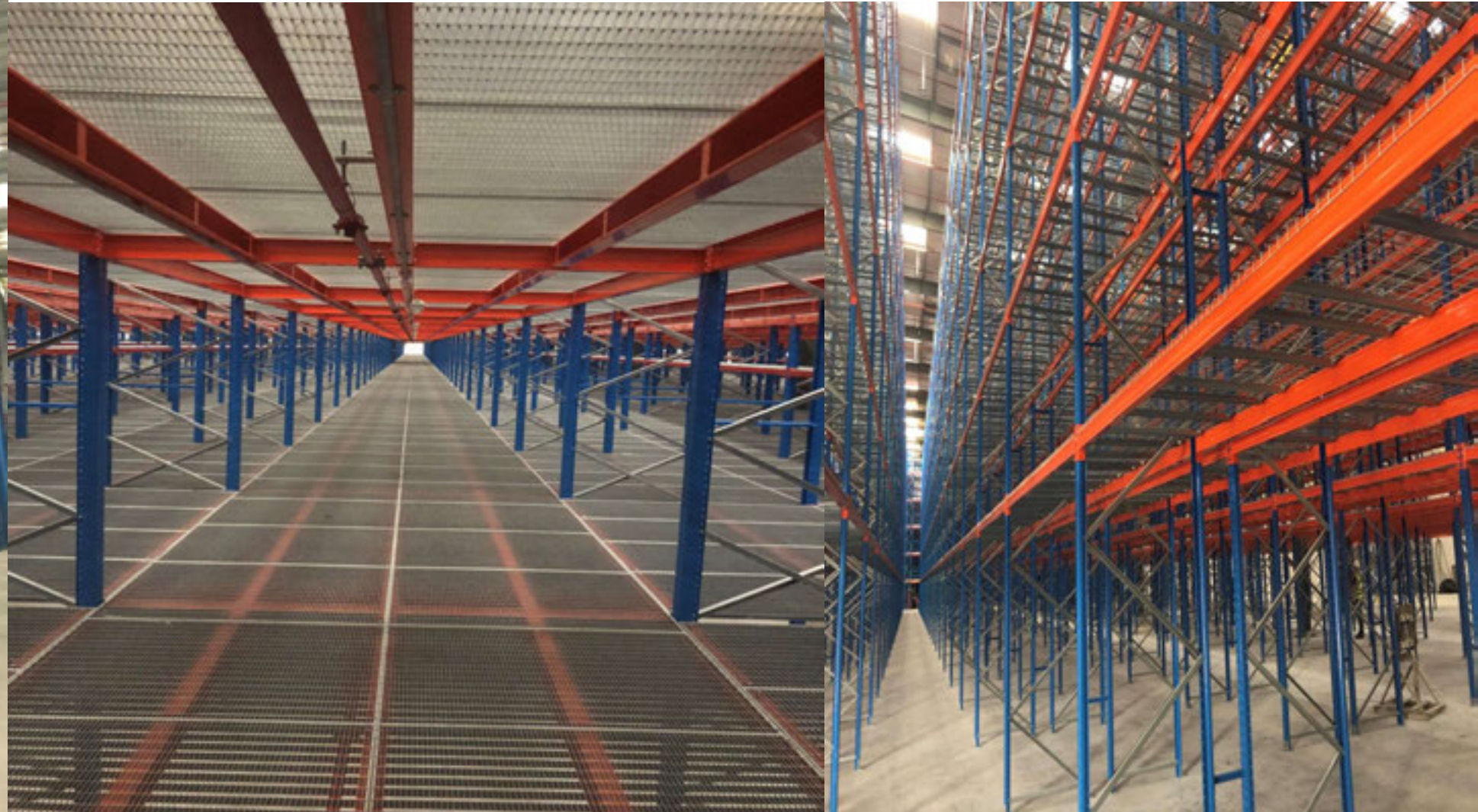

AlShaya Enterprise – AL AIN COOPERATIVE SOCIETY (UAE)

Al Ain Coop is a leading retailer in UAE with over 30,000 products ranging from electronics to fresh fruits operating from 28 retail avenues all across the country. They selected Alshaya to execute its storage, doors and dock equipment requirement for its central distribution hub in Kizad Abu Dhabi.

Total built up area Abu Dhabi project: 7,500 square meters

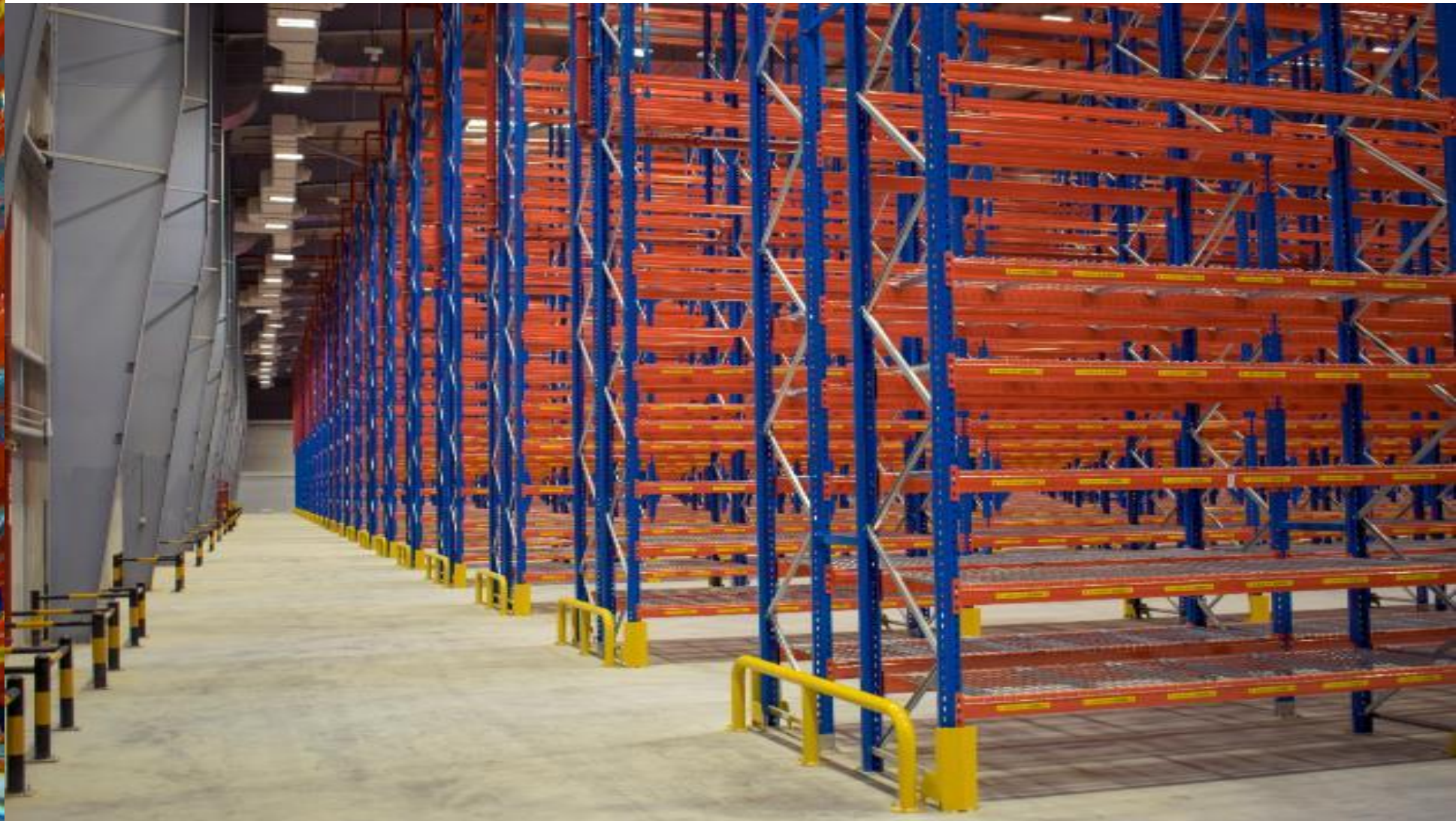

AlShaya Enterprise – NEW EAST GENERAL (3PL & AUTOMOTIVE PARTS) UAE

New East has been serving the UAE Auto parts market since 1992 and represents over 60 auto manufacturers in the region. They selected the Mecalux Auto Shuttle to meet their growing storage needs.

Storage capacity: 25,000 pallet positions.



Alshaya Enterprise – Al BASHAYER MEAT CO. (OMAN)

Al Bashayer Meat Company is Oman's first and the region's largest integrated red meat project. They have state of the art facilities and disease free hygienic farms for raising livestock. Alshaya Enterprises was awarded the prestigious mobile pallet racking system project to maximize space utilization for bulk storage.

Storage capacity: 750 pallet positions.

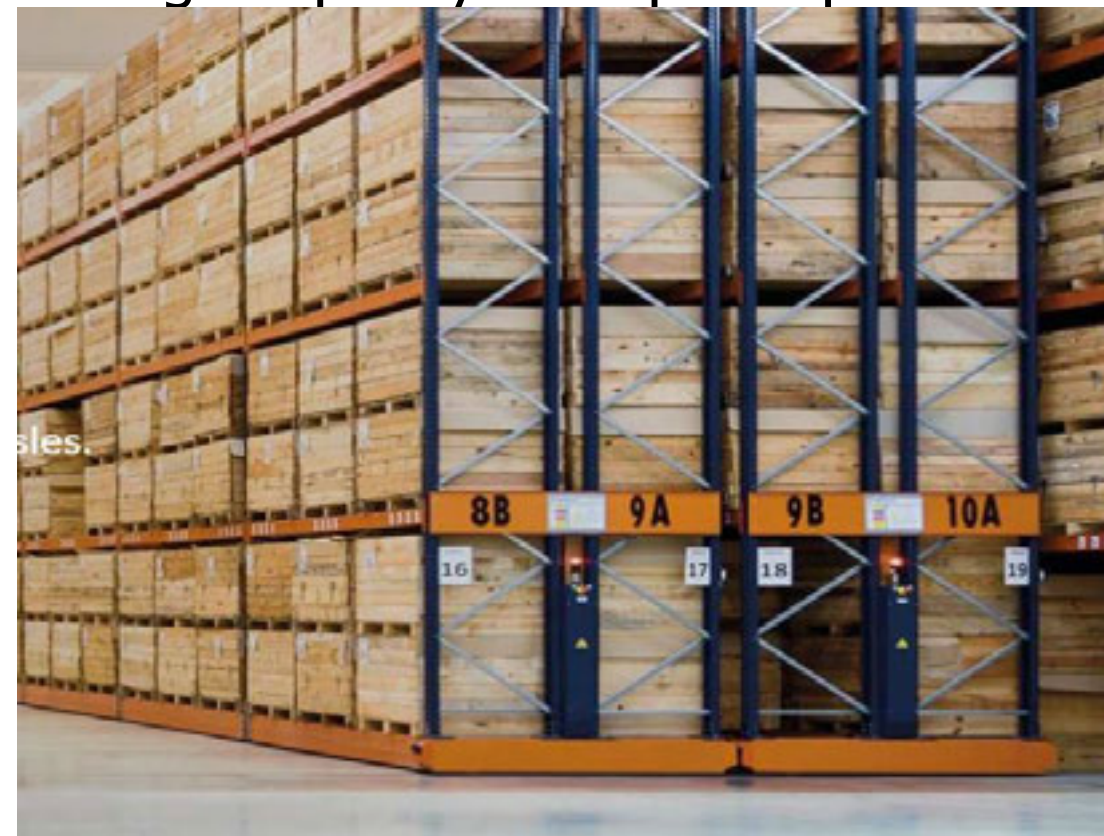
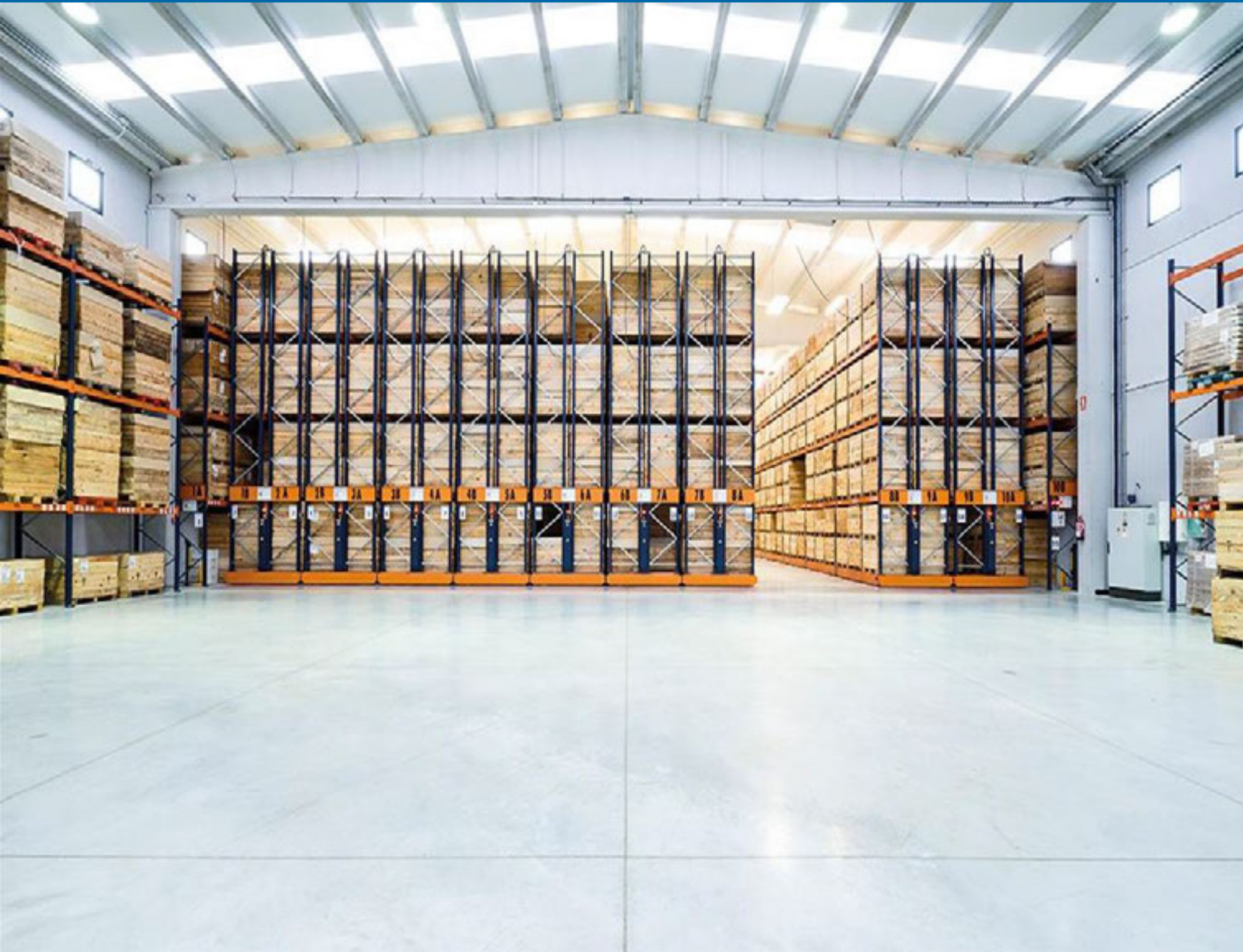

Alshaya Enterprise – KAMAL OSMAN JAMJOOM EST. (UAE)

One of the leading retailers in GCC with over 300 retail outlets, Kamal Osman is a key account of Alshaya with numerous projects executed including Pillar based mezzanine, VNA Pallet Racking and heavy-duty shelving.

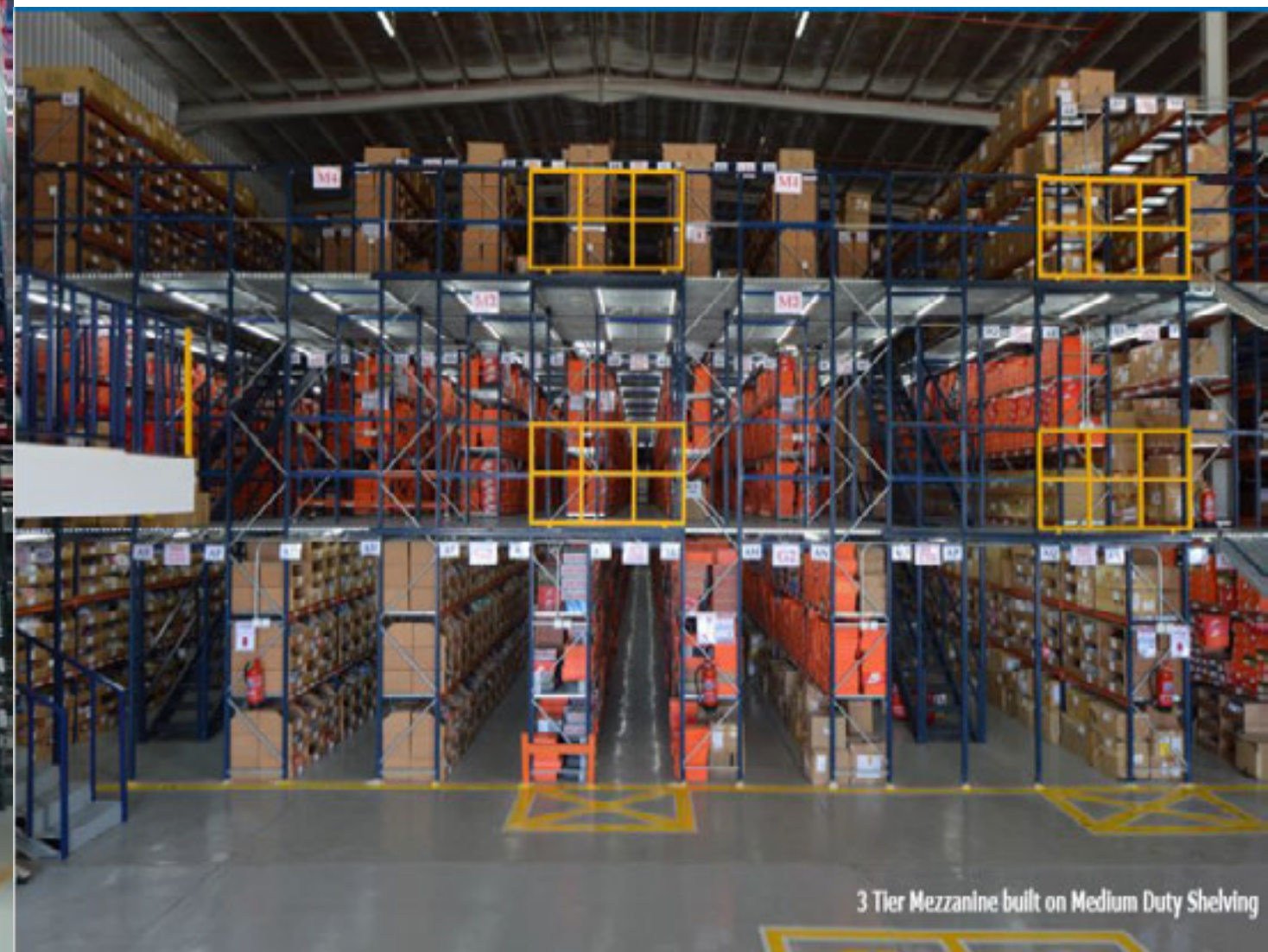

3 Tier Mezzanine built on Medium Duty Shelving

AlShaya Enterprise – RR – Soraiya Carpet Factory – Jeddah

It is one of top 10 biggest carpet manufacturing company in the world having won the project to provide carpets for Olympic games in Beijing in the year 2008 & to cater this requirement RR had been awarded to provide storage system for storing 300,000 carpet rolls.



AlShaya Enterprise – RR – PepsiCo Distribution Center - Riyadh

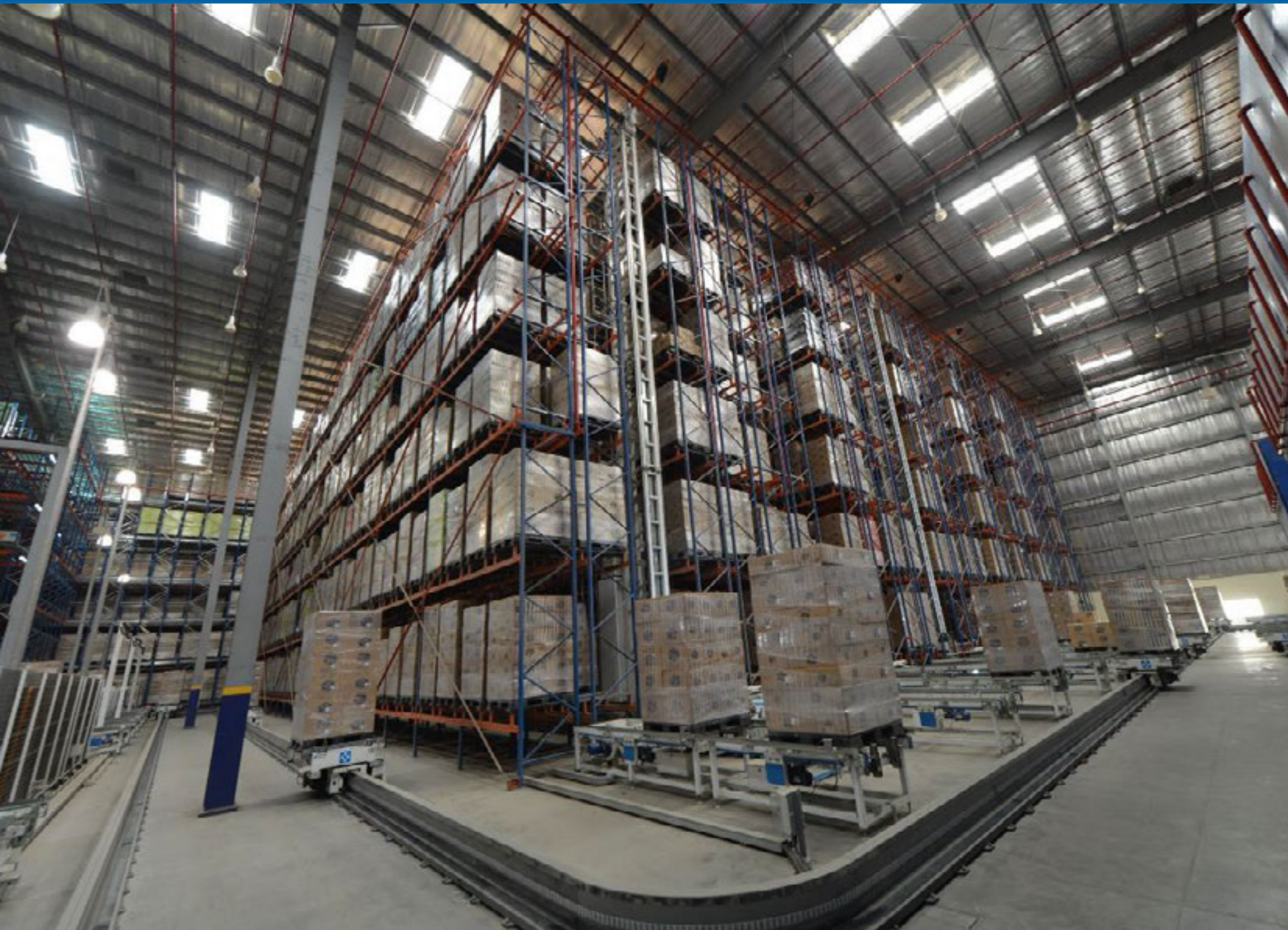

Fully Automated Storage & Retrieval System

Stacker Crane with frame height of 16mtr and Double Deep Orientation

5,000 Pallet Location



AlShaya Enterprise – RR – Dareen International (UAE)

Dareen International (Span Steel Construction)
Located in National Industrial Park

- a. 38 No's Sectional Doors
- b. 30 No's Telescopic Dock Levelers
- c. 30 No's Dock Shelters
- d. 30 NO's Traffic Lights
- e. 30 No's Dock Lights



Alshaya Enterprise – RR – Logix (UAE)

Logix (Amana Contracting & Steel Building)
Located in JAFZA South

- a. 75 No's Sectional Doors
- b. 37 No's Telescopic Dock Levelers
- c. 37 No's Dock Shelters
- d. 37 NO's Traffic Lights



AlShaya Enterprise – RR – Nesma Binzagr – KAEC



REFERENCES

Alshaya Enterprise – RR – Industrial References



AlShaya Enterprise – RR – Automotive References



AlShaya Enterprise – RR – FMCG References



AlShaya Enterprise – RR – 3PL References



مساندة
للخدمات اللوجستية
MOSANADA LOGISTICS SERVICES



MOTION
supply chain



TAMER



SCHENKER



United
Warehouse
Company
Limited



شركة
المخازن
المتحدة
المحدودة

AlShaya Enterprise – RR – Pharmaceutical References



THANK YOU

Follow us:      @AlshayaEnterprises

KUWAIT | KSA | UAE | QATAR | OMAN | BAHRAIN

www.alshayaenterprises.com