

PRODUCT PROFILE

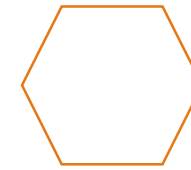

CEMENT



Cement Type:

Ordinary Portland Cement (OPC)

Portland Limestone Cement (PLC)

Sulphate Resistant Cement (SRC)

White Cement



Brands:

Ultratech, RAK, Pioneer, Lafarge, Sharjah, Gulf, National, Union, JK, Emirates Al-Ain, Falcon



Our cement portfolio includes all the major brands dealt in the UAE. We have direct sales distributorship with the local factory. Cement is available in bulk and bags, as per requirement. We also export cement to other regions.



DEFORMED STEEL

Deformed Steel or hot rolled reinforcing bars (rebar). Rebar is a long steel product used exclusively in civil engineering and building projects to provide tensile strength to concrete. It is typically produced as a deformed round, either in straight lengths or in coil. Deformed rounds have ridges or notches to provide greater adherence to the concrete.



**Deformed steel rebar as per BS 4449
grade 500B and ASTM**

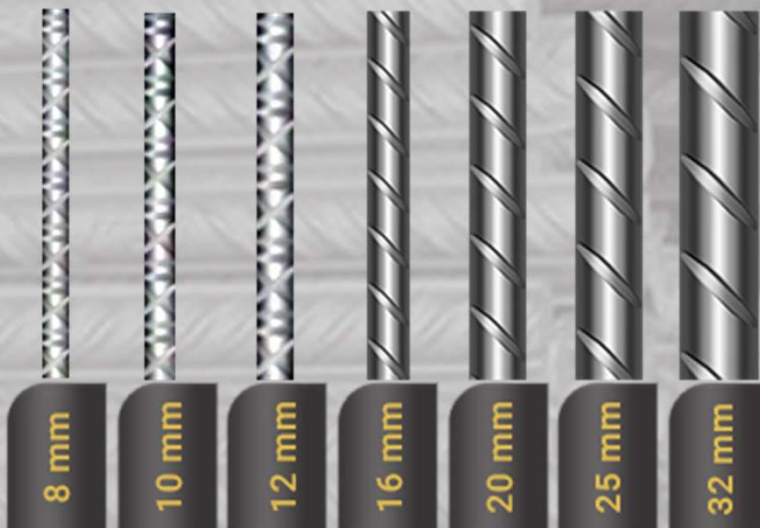

UAE Origin Mills

Emirates Steel Industry
Conares Metal Supply
Hamriyah Steel
Jindal Shadeed Oman
Qatar Steel – Jebel Ali



BRC MESH

BRC Mesh pre-fabricated steel reinforcement material. It is a rectangular or square mesh reinforcement in flat sheet.

Beside the widely and traditionally used ground slab reinforcement, BRC Wire Mesh became an important reinforcement in modern construction.

It is now widely used in all different types of construction and in most structural members such as:

- Retaining Walls
- Precast Elements
- Mat Foundations
- Silos, Pipes
- Suspended Slab
- Canal Lining and Culverts

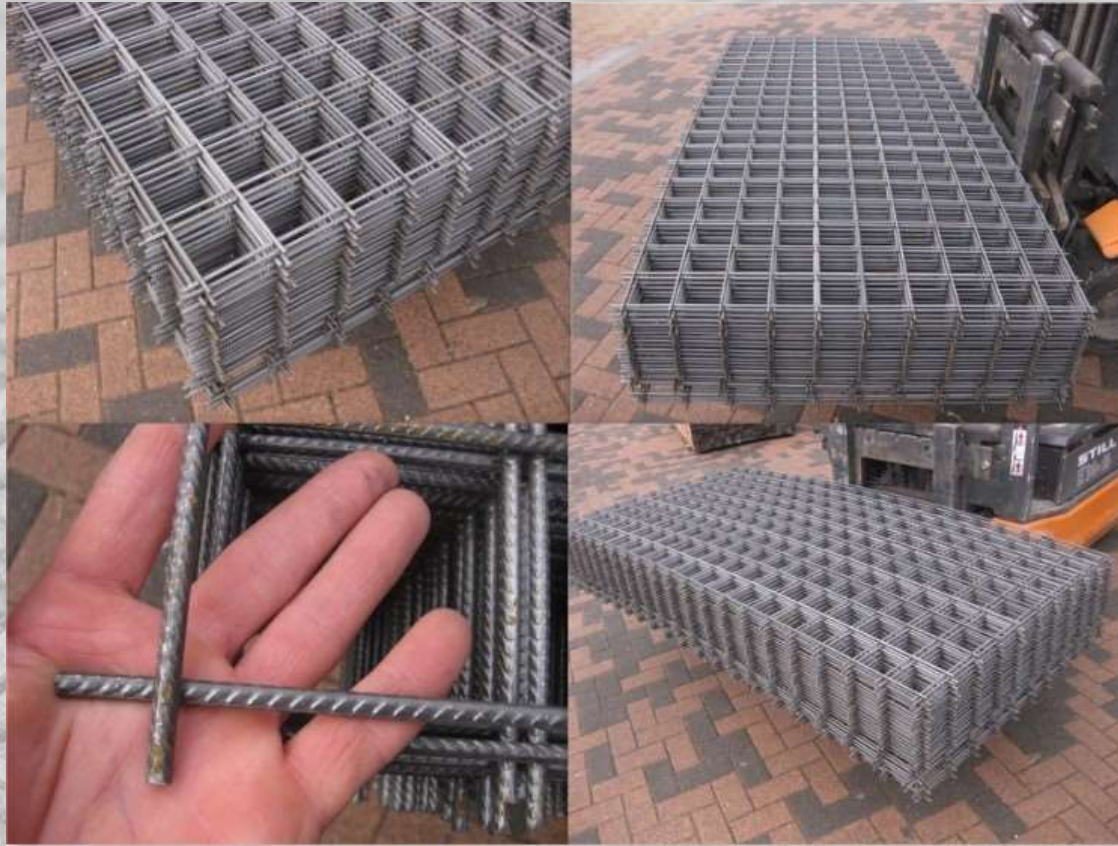

Wire Mesh – Code	Size
A – 093	2.4 x 4.8 x 5mm
A – 142	2.4 x 4.8 x 6mm
A – 193	2.4 x 4.8 x 7mm
A – 252	2.4 x 4.8 x 8mm
A – 393	2.4 x 4.8 x 10mm
A – 565	2.4 x 4.8 x 12mm



WOOD



We are engaged in supplying comprehensive range of Wood like Marine Plywood, Commercial Plywood, MDF Boards which is available in various kinds to meet the distinguished requirements of clients..

MARINE PLYWOOD

Superior quality Combi core Film faced plywood

Premium quality Hard wood core film faced plywood

High End PP Plastic faced plywood

Glue: WBP/MR **Film:** Brown, Black

Size: 1220 x 2440 x 12/18 Mm

Origin: Malaysia, Vietnam, China, India

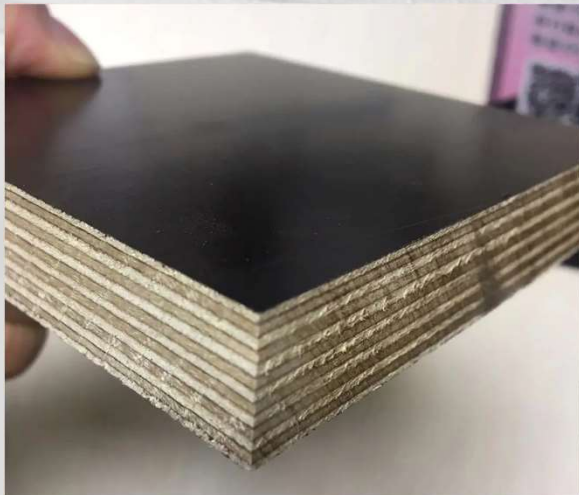

MDF Boards

Size: 4' x 8' & 6' x 12' **Density:** 700 to 750

Thickness: 3mm, 6mm, 9mm, 12mm, 15mm, 18mm, 25mm.

Origin: Malaysia, Thailand, China, Spain



Commercial Plywood

Standard sizes: 4 x 8

Thickness: 4mm, 6mm, 9mm, 12mm, 18mm, 22mm

Origin: Malaysia, Indonesia, Brazil, India, China



FIBRE BOARDS

Cement board is a combination of cement and reinforcing fibers. Cement boards are fire-proof, water-resistant and anti-termite. These characteristics enable the boards to be the prime panels for portable cabin industry. In our part of the world, this is used for wall paneling and flooring in the prefabricated houses and similar structures. Cement boards can also be used for kitchen cabinets since due to resistance characteristics. Easy to cut, grind, screw and paint.

Magnesium Oxide Board or MgO Board is a technologically advanced building material that offers superior performance in every category when compared to traditional wood, gypsum and cement based products. This board is virtually impervious to fire, water, insects; does not feed mold or mildew; is non-toxic, non-flammable and non-combustible; is durable, maintains its dimensional stability – even when wet; and, has exceptional bonding surface. MgO Board is a mineral based green builder product. It is homogeneous and non-delaminating.

Calcium Silicate Board is made from siliceous and calcareous materials reinforced with fibers. These boards are made in a laminar process and then autoclaved to give a stable crystalline structure. This is lightweight and non-combustible with high performance, durability and architectural flexibility, providing customers with exceptional value for money. Calcium silicate boards are widely used in the manufacture of portable cabins, wall paneling, plain ceilings, decorative ceiling systems and in many more similar applications. These boards are water proof and anti-termite as well.

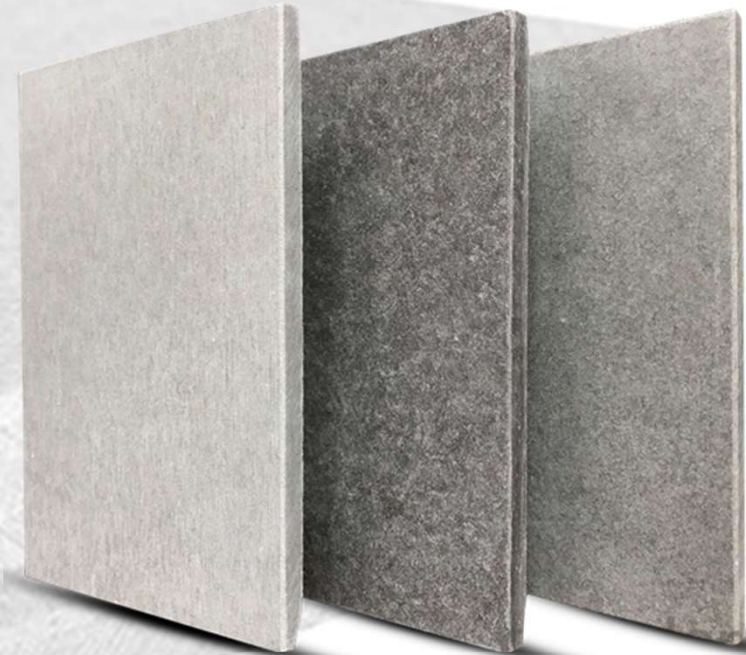

Non-Asbestos Fiber Cement Board

Water resistance and Non-decay
High impact strength Terminate Resistance
Flex Flexibility for various designs
Better heat resistance
Light weight, fast and easy to install



GYPSUM

Gypsum Powder is a very soft material and has excellent flexibility. Gypsum powder is used for final layer of plastering with high mesh. In addition, it is used in medicine, sculpture, decoration, GYPSUM BOARD factories and gypsum prefabricated walls. At construction sited it is also used to cover tiles and marbles to avoid damage.

Gypsum Boards (also known as plasterboard, wallboard, dry-wall partition) is a panel made of gypsum plaster pressed between two thick sheets of paper. It is used to make interior walls and ceilings. Drywall construction became prevalent as a speedier alternative to traditional materials and systems. These boards are easy to cut, shape and drill. This is paintable. Tiles could be stuck on these boards easily. Gypsum boards are manufactured in fire-proof and water-proof categories as well. This is widely used in partitions, ceilings and many other similar jobs.



Gypsum Powder

Gypsum Joint Compound



Gypsum Board

Standard Size : 4 X 8"

Thickness : 9mm, 12.5mm, 15mm

Gypsum Accessories

Fibre Tape, Metal Corner Tape

Gypsum Tiles



WIRES & MESH

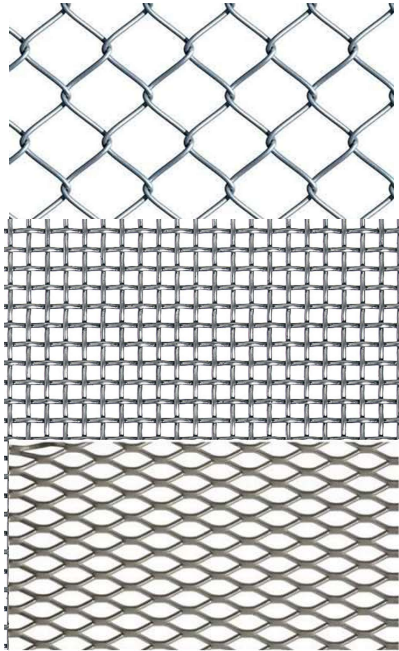

There are multiple uses of wires and mesh in construction, farming, manufacturing etc. We have a supply chain of wide variety of wires and mesh as per our client requirements. There is a wide product range available.

We also supply various types of nails.

WELDED MESH

- PVC Coated Chain Link
- Hot Dipped Welded Mesh
- Electro Galvanized Welded Mesh
- Mild Steel Welded Mesh
- Powder coated Welded Mesh
- PVC Coated Welded Mesh
- Chicken Wire Mesh

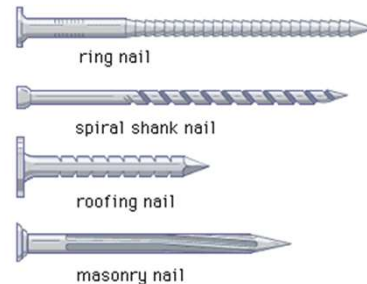
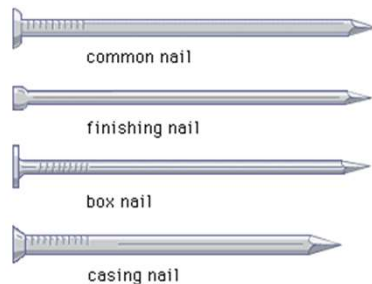

NAILS



WIRES

- Hot Dipped Wire
- Galvanized Wire
- Mild Steel Wire
- PVC Coated Wire
- Barbed Wire
- Binding Wire



BINDING WIRES



CONSTRUCTION CHEMICALS

TERRACO

Henkel

Polybit

BASF

The Chemical Company

Pidilite

CORROTECH
Construction Chemicals

Construction chemicals are chemical compounds that are added to materials such as mortar and concrete to improve compatibility with the building structure, performance and protect structures.

We offer a wide variety of construction chemicals and services to our customers which in turn will enhance the life of their structures industry

- Bitumen Drum/Sheets
- Water Stopper
- Crack Filler
- Quick Cement
- Waterproof seizer
- M. Seal
- Silicon Tube
- Concrete Repair
- Mortars
- Putty
- ...And Many more

MES

OTHER PRODUCTS



ACRYLIC SHEET



TARPAULIN
POLYTHENE ROLL



TILE GLUE



ELECTRICAL CABLE & WIRES



FLEXEL SHEET



HARDWARE & SAFETY EQUIPMENT



PAINTS & ACCESORIES



TILE PROTECTION - PVC SHEET





MES Building Material

WE SUPPLY ALL TYPES OF CONSTRUCTION MATERIALS



P. O Box 72015
Sharjah, UAE



+971 6 559 6354



+971 50 677 4841



vjain@eim.ae

