

Creation of Imagination...



Al Majd

FIBER GLASS INDUSTRY L.L.C.



MFG

المجد

المجد لصناعة الفايبر جلاس ذ.م.م.

Introduction

Al Majd fiber Glass Industry LLC. have great pleasure to introduce ourselves, as pioneers in the field of GRP,GRC,GRG Designers & Manufacturers in wide range of Products. Located in Al Sajaa Ind. Area, Sharjah, U.A.E.

We, a group of enthusiastic visionaries and full-fledged technocrats with a Strong Designing, Manufacturing and Marketing infrastructure throughout Middle East.



Our well reputed and prestigious clients will speak itself the Quality and Promptness. In **GRP (Glass Reinforced Plastic / Fiber glass)**, have a division of well equipped with all facilities to manufacture a wide range of products like;

- Water Tanks, Septic Tanks, Fuel Tanks, Chemical Tanks, Hot and Cold Pressed Panel Tanks, Plastic Tanks- in various sizes.
- Car parking shades, Sheets (Plain, corrugated & profile) Sun shades, canopies.
- Column mould, Shutter moulds, Planter Boxes, Shower Trays, Bath Tubs, and Ladders.
- Ablution Blocks, Security Cabins, Domes, Globes, Swimming pool.
- GRP Lining Works for Manholes, Underground RCC Tanks.
- Execute special custom made products.

GRC (Glass Reinforced Concrete) we Offer an Alternative to the conventional method of decorative applications in Interior & Exteriors. Our wide ranges of products are;

- Decorative & Plain Screen Panels
- Domes, Columns, Cornice, Fascia Panels
- Balustrades, Decorative Planters
- Cluster Panels, Wall & column Claddings
- Capitals, Copings, Brackets
- And different type of decorative items & offers wide range of products.

GRG (Glass Reinforced Gypsum) is a popular medium in Interior decoration, such as Cornice, Ceiling & Dome Panels works will transforms the interiors in to Royal.

And our sister concern M/s. **MAJESTIC ELECTRO MECHANICAL CONT.** conducts all types of Mechanical & Electrical works, have already been made versatility in the Marine field.

We ensures our promptness with our experienced technicians and supervisors will provide better quality and fulfill the needs and taste of every Clients.

We look forward for a fruitful long term relationship with your esteemed organization.



SPECIFICATION

- Gel-coat of 0.5MM thickness to provides chemical resistance.
- Resin content 60-70% by weight to assist reinforcement for chopped strand mat.
- Resin content 45-55% provides strength and rigidity for woven roving.
- E-glass surface mat (450gm/m²) or synthetic layers are used consisting of approximately 90% resin by weight. Thickness of the reinforced layers is generally 0.5mm. This provides a protective barrier against corrosion.
- An Isophthalic type resin complying with BS 3532:1962 class B standard or equal quality resin.
- Gel-coat finishing on outside the tank.
- For joints provide GRP putty and chopped strand mat covered with gel-coat.
- Structure of the tank includes 1mm thick gel-coat interior finishing, a surface mat is provided to protect inner coating. Adequate layers of fiber-mat and woven roving layers will be applied according to the thickness using required resin and chemicals to suit the usage of tanks. The cover coat will be given with waxed coating to get clear look.
- The external surface of the tank is top coated with wax added topcoat polyester resin, Tanks body (laminate) thickness is manufactured by using UV resistance polyester laminating resin. These provide UV resistance to the tanks.
- Tanks have special layer inside the tank wall, which provides protection against algae. Its specification are as follows: After building up the tank wall with layers of fiber glass chopped strand mat impregnated with polyester resin, a special layer of mat saturated with black pigmented polyester resin is applied. Further laminations are build up on this special layer to complete the tank wall thickness.
- Tanks include inlet, outlet, drains, over flow, vent and manholes.
- Tanks are manufactured conforming to BS 4994.

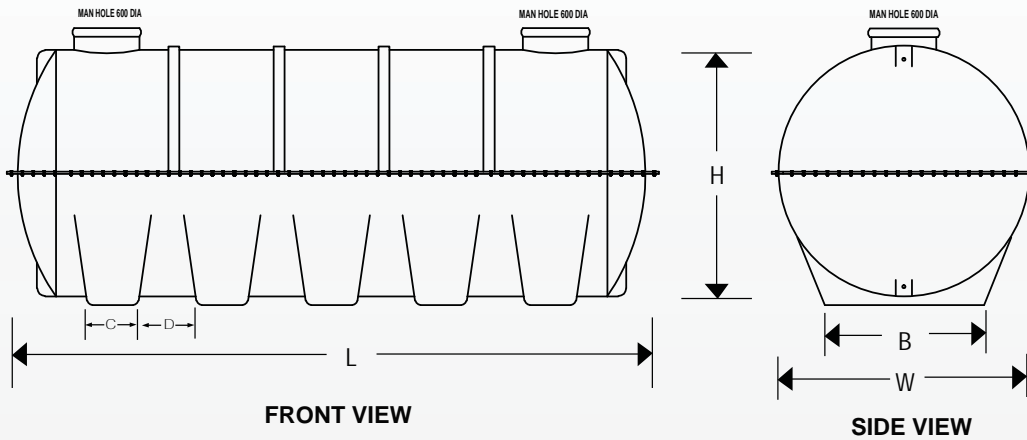

S.No.	U.S.Gallon	Length in C.M (L)	Width in C.M (W)	Height in C.M (H)	Length of leg (B)	Width of leg (C)	Distance between legs (D)	No. of legs
1	200	120	90	95	65	16	32	2
2	250	126	102	102	75	18	31	2
3	300	138	102	105	63	16	49	2
4	400	138	120	128	88	18	32	2
5	500	180	122	130	92	24	54	2
6	600	195	125	135	92	24	54	2
7	800	190	140	150	98	27	65	2
8	900	201	148	156	92	30	50	2
9	1000	236	148	156	92	30	70	2
10	1200	230	170	170	98	30	65	2
11	1500	280	170	170	98	30	50	3
12	2000	270	205	225	135	46	54	2
13	3000	370	205	225	135	46	54	3
14	4000	470	205	225	135	46	54	4
15	5000	570	205	225	135	46	54	5
16	6000	670	205	225	135	46	54	6
17	8000	622	282	260	190	46	54	5
18	10000	722	282	260	190	43	53	6
19	12000	822	282	260	190	43	53	7
20	15000	1022	282	260	190	43	53	9
21	20000	1222	282	260	190	43	53	11

S.No.	U.S. Gallon	Dia (mm)	Height (mm)	Min. Wall Thickness (mm)	Man Hole Size (mm)
1	500	1360	1450	4	600
2	1000	1800	1600	6	600
3	1500	1800	2200	6	600
4	2000	2200	1900	6	600
5	3000	2200	2900	8	600
6	4000	2500	3064	8	600
7	5000	2500	3830	10	600



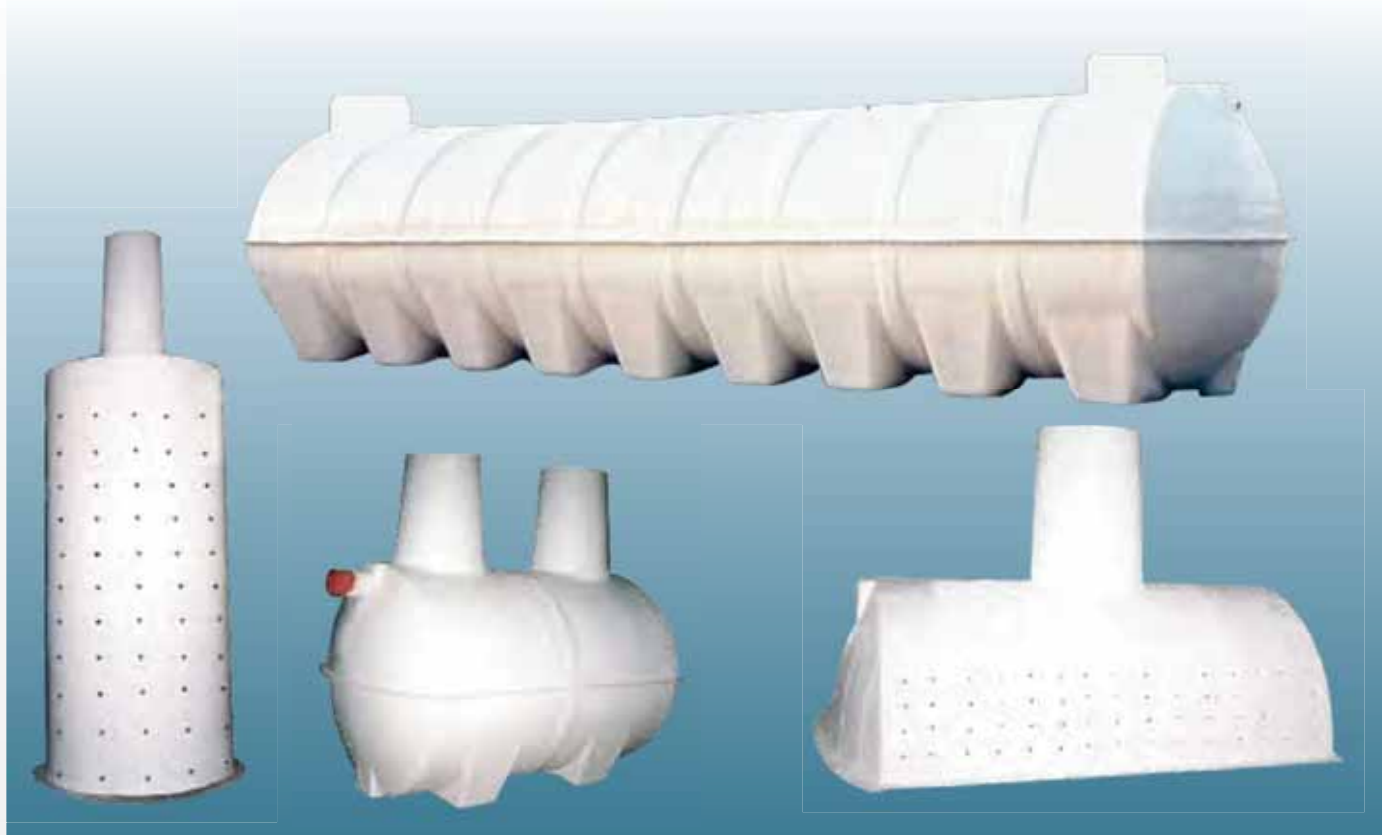

Specification

- Septic Tanks & Soak Away tanks are available in capacities ranging from 200 U.S.Gallon to 20,000 U.S.Gallon. They are available in diameters ranging from 1 to 2.80m to suit the extract requirements of various locations.
- Septic Tanks are specially designed and manufactured for underground use to withstand the extreme corrosive soil conditions and environments. They can be installed even in extreme conditions such as areas where sub-soil water is very high. They are designed and moulded to suit most of the corrosive chemicals present in the sewage and withstand high degree bacteriological action.
- Septic tanks are provided with digesting chambers, manholes and piping system to enable the sewage to get digested efficiently and lighter effluent passes into the soak away where it undergoes utmost absorption within the soak away materials itself and the area surrounding it.
- Septic tanks & soak away conform to relevant municipality specifications and practices. They are manufactured, designed and installed as per approval from municipalities of the Gulf.
- Septic tanks and soak away are economical, available quickly and installed with minimum cost. They are self-pigmented, corrosion proof and stabilized offering excellent resistance to corrosive soils. They are free from maintenance.

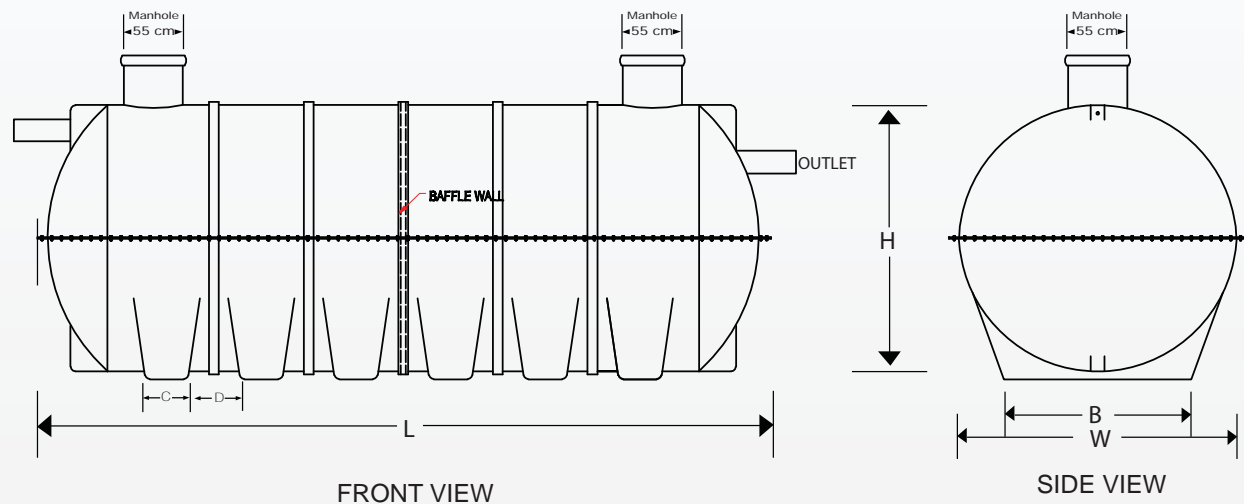

S.No.	U.S.Gallon	Length in C.M (L)	Width in C.M (W)	Height in C.M (H)	Length of leg (B)	Width of leg (C)	Distance between legs (D)	No. of legs	No.of Person
1	200	120	90	95	65	16	32	2	-
2	250	126	102	102	75	18	31	2	-
3	300	138	102	105	63	16	49	2	-
4	400	138	120	128	88	18	32	2	-
5	500	180	122	130	92	24	54	2	4
6	600	195	125	135	92	24	54	2	5
7	800	190	140	150	98	27	65	2	6
8	900	201	148	156	92	30	50	2	7
9	1000	236	148	156	92	30	70	2	8
10	1200	230	170	170	98	30	65	2	10
11	1500	280	170	170	98	30	50	3	12
12	2000	270	205	225	135	46	54	2	15
13	3000	370	205	225	135	46	54	3	25
14	4000	470	205	225	135	46	54	4	35
15	5000	570	205	225	135	46	54	5	45
16	6000	670	205	225	135	46	54	6	55
17	8000	622	282	260	190	46	54	5	70
18	10000	722	282	260	190	43	53	6	90
19	12000	822	282	260	190	43	53	7	130
20	15000	1022	282	260	190	43	53	9	180
21	20000	1222	282	260	190	43	53	11	



Set Up And Foundation



3D Model of GRP Tank with Inner Partition



Inside Sanitation of GRP Water Tank

Technology & quality are recognized worldwide with MFG GRP PANEL TANK

Al Majed GRP PANEL TANK gives clients the best satisfaction from world-class quality level certifications
Building lifelong satisfaction- We will supply the best product as seen by our customer's prospective

Precious Water For Human Life-MFG Will Manage It Effectively.

SMC (Sheet Molding Compound) has excellent water resistance and satisfies customers excellent durability and sanitary properties

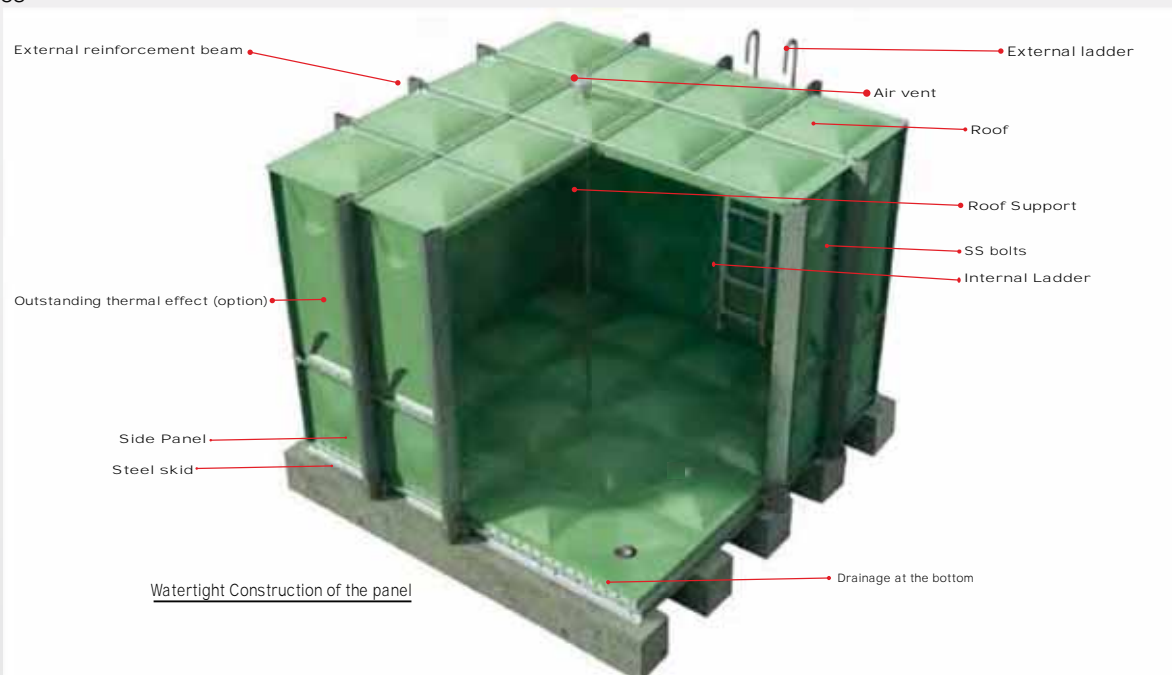

We guarantee for High Quality, Clean and Hygienic bacteria free, fungus free, no temperature fluctuation, ultra violet protection, no rust, no corrosion, no leakage, strong pressure and heat resistance, Recommended by builders, architects and consultants for portability and purity of water and its strength, conveniences and durability.

Each product is made to the highest quality using linear low density.

Polyethylene – an environmentally compatible hydrocarbon. MFG products are designed using the latest and fine analytical methods.

High Quality

Polyethylene used is approved by food and drugs administration (FDA).

Clean and Hygienic

Smooth inner layer resists the existence and prevalence of bacteria, algae, fungus etc. and enhance the portability of water. It also ensures no smell, no Colour and no taste.

No Temperature Fluctuation

The black middle layer resists the Heat and the water in the tank remains cool. The specially designed outer layer (UV – stabilizer) off-sets the ultra violet rays.

No rust, No Corrosion

Raw material used in the manufacturing ensures corrosion free and rust free storage.

Leak Proof

Single piece moulded body ensures, no joints, no leakage and 100% maintenance free water storage.

Strong and Secure

Special circular and vertical ribs ensure the resistance against the environmental stress and high liquid pressure, i.e. there will not be any cracks in the body and ensuring long life.

Threaded caps ensure tight closure and take guard against dust and other contaminations.

Easy to install and highly adaptable

Light weight tanks are designed for easy handling and installation it is not only convenient to handle but also adaptable to different applications. Such as in house holds, irrigation, institutions and factories etc. and suitable for over head and underground applications.

Available in many sizes

MFG tanks are available in the range of 100 gallons to 5000 gallons. So that it will satisfy every ones needs.

Supply with Valves

Outlet, Inlet, Overflow and Drainage valve. (According to users requirements)

MFG - Plastic Horizontal Tanks

S. No.	U.S Gallon	Dia (mm)	Length (mm)	Height (mm)	Min. Wall Thickness (mm)	Insulated Tank Thick (mm)	Man Hole Size (mm)
1	200	900	1300	950	5.5	7	400
2	300	950	1600	1000	6	8	400
3	400	1050	1800	1100	6.5	9.5	400
4	500	1200	1900	1250	7.5	10.5	400
5	600	1300	2000	1350	8	11	400
6	800	1400	2100	1450	9	12	475
7	1000	1450	2350	1500	9.5	13	475
8	1200	1600	2350	1650	10	13	475

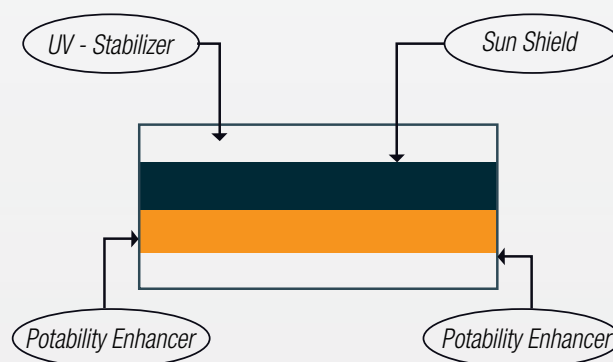
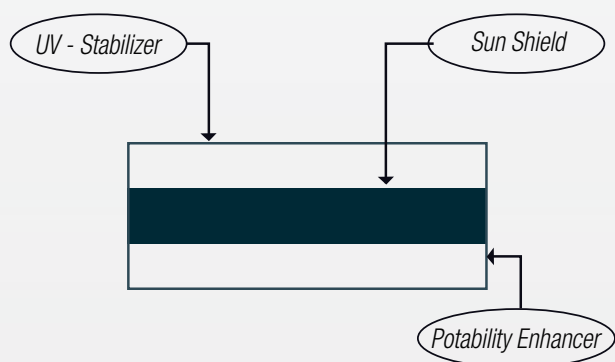

MFG- Plastic Vertical Tanks



S. No.	U.S Gallon	Dia (mm)	Height (mm)	Min. Wall Thickness (mm)	Insulated Tank Thick (mm)	Manhole Size (mm)
1	100	780	995	4	5.5	400
2	200	1000	1155	4	6	400
3	300	1200	1200	4.5	6.5	400
4	400	1350	1280	5.5	7	400
5	500	1350	1560	6	8	400
6	600	1350	1800	6	8.5	400
7	800	1500	1900	7.5	9	400
8	800	2130	1000	8	9	400
9	1000	1650	2050	8	10	475
10	1000	1800	1600	8	10	475
11	1500	1950	2000	8.5	11	475
12	2000	2132	2327	9.5	12	475
13	2000	2340	1905	9.5	12	475
14	3000	2340	2820	10	13	475
15	5000	2820	3325	12.5	14	475



Specification

GRP panels are lightweight, easy to transport and quick to install, Panel size provides flexibility to suit design and site requirements.

Panels are smooth and impervious on both sides.

Panel surface don't permit growth of algae, bacteria or fungus. Thus providing excellent protection to store water. Water remains always hygienic in our panel tanks.

Panels are non-toxic, non-staining, corrosion proof and UV stabilized.

Panel tanks are non-corrosive. Assembly nuts, bolts and tie rods are in stainless steel 304 & 316 grades

Panel available in different sizes are 1x0.5m, 1x1m, 1x1.5m.

GRP Raw materials are selected from the sources, confirming to BRITISH STANDARDS 3496, 3479 and 3532. Manufacturing is strictly according to the principles laid down in BS 4994.

For insulated panels, 25MM thick polyurethane foam insulation is provided.

Panel tanks include external GI ladder and internal GRP ladder. These tanks have 60cm diameter manhole, inlet, outlet, drain, overflow and air vent.

Thickness of each panel is 10mm.colour of panel is grey & beige

All panel joints are bolted together with neoprene gasket sealant.

Panel tanks are guaranteed against manufacturing defects ad structural performance.

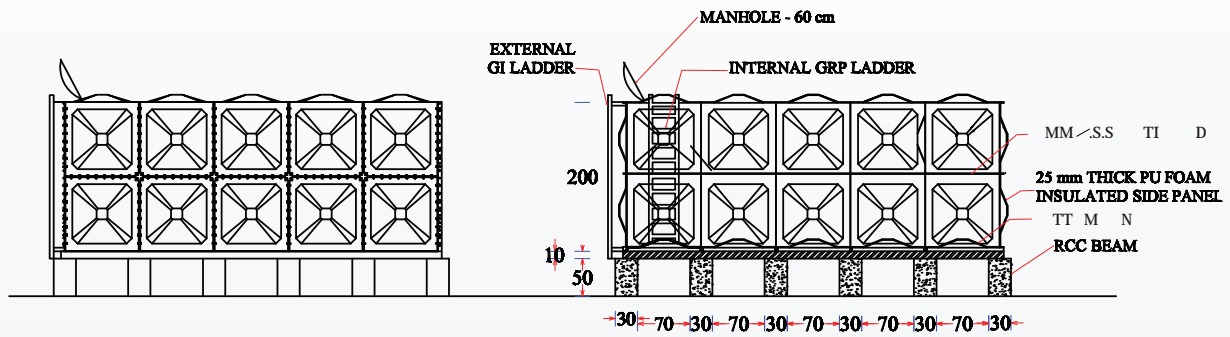

FRONT ELEVATION

SECTION ON-AA

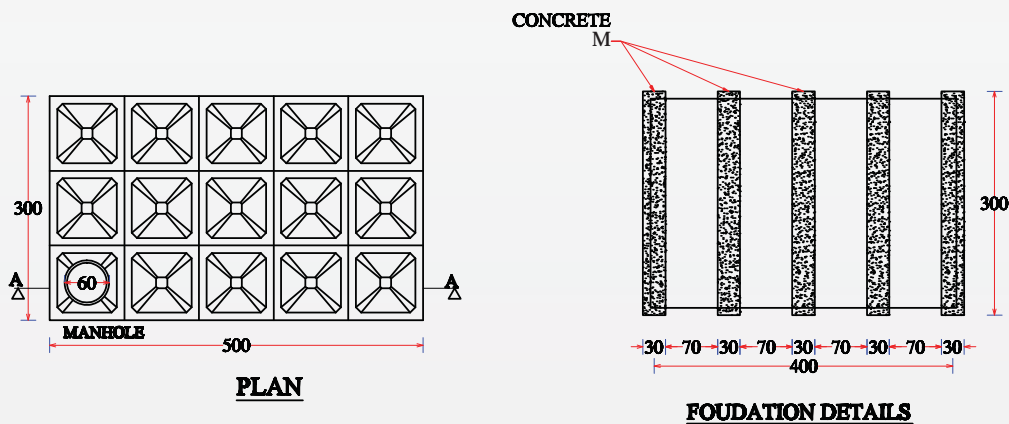

PLAN

FOUNDATION DETAILS

PHYSICAL PROPERTIES

1.8		
30		
1020		
1.40	105	
1650		
52.5		
3010		
960		9.41
2.16	10 5	
0.15		
0.02		
5.0		
1.0		
		0.2
		2
0.00		

Dimension

S.No.	Dimension W H (M)	a cit in U.S.Gallon
1	1 1 1	264
2	1.5 1 1	396
3	2 1 1	528
4	1.5 1.5 1	594
5	2 1.5 1	792
6	1.5 1.5 1.5	891
7	2 2 1	1056
8	2.5 1.5 1.5	1485
9	2 2 1.5	1584
10	2.5 2 1.5	1980
11	2 2 2	2112
12	2.5 2 2	2640
13	3 2 2	3168
14	5 2 1.5	3960
15	4 2.5 2	5280

- GRP Lining is being recommended by consultants for RCC tanks, Mild steel containers, pipe liners etc. for the following reasons:
- Weather proofing: Protection from humidity, moisture, fungi insects and bacterial growth and biological degradation in the container. It does not rust, rot, corrode or swell.
- Extra thermal and electrical insulation and Fire resistance can be incorporated, if required. Resins are also available to suit lining for storage of food items, oils, Petroleum products and Storage of chemicals.
- Fullest Utilization of space and no chance of spillage, leakage or any sort of wastage of stored material. Longer life of lining and storage items is guaranteed by virtue of resin quality.
- Ease of maintenance, Cleaning and repairs.
- Normally the lining consists of 2 – 3 layers of chopped strand mat hardened with resin followed by thick layer of Top coat / Gel coat giving a thickness of approx. 2- 3 mm. Thickness can be varied as per specification subject to the quality and life of protection required

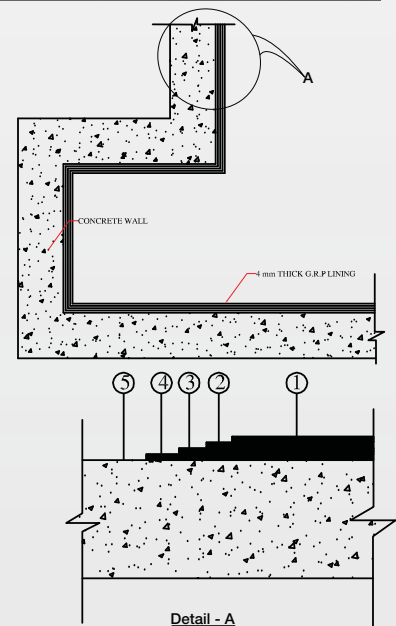
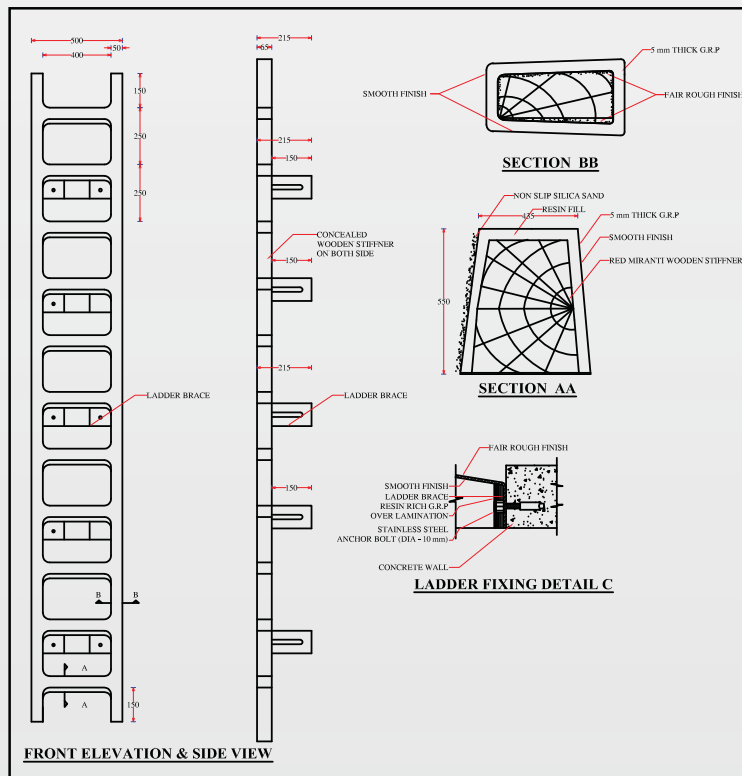
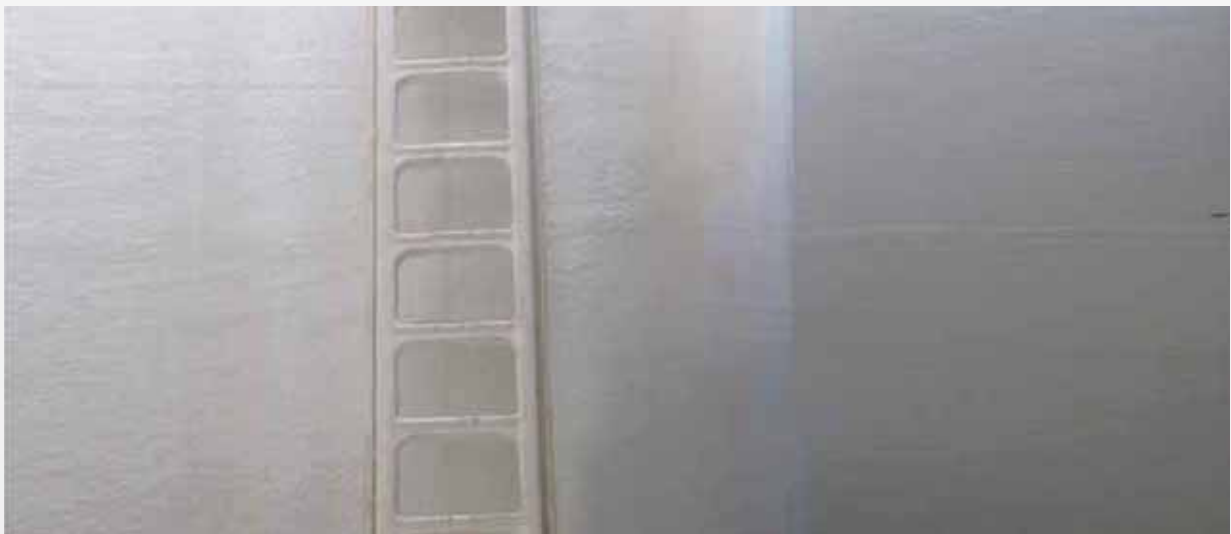

METHOD OF STATEMENT OF GRP LAMINATION	
1	First layer applying resin coating above RCC wall
2	Second layer apply CS Mat with resin
3	Third layer apply CS Mat with resin
4	Fourth layer apply CS Mat with resin
5	Fifth layer apply wax added white Gelcoat



DESIGN : Star/ Arch/ Islamic/Wave (as per our Drawings)

THICKNESS : 5mm thick GRP.

FINISH : Smooth glass finishing inside & smooth gel coat finish on outside.

COLOUR : White Pigmented colour or any other colour as per your requirement.

MATERIALS OF CONSTRUCTION : Isophthalic Polyester gel-coat two coats reinforced with fiberglass surface tissue "C" glass would from the surface of GRP roofs. This would provide good looks and smooth decorative finish. All raw materials used in purchased from leading companies of the world and they confirm to the irrelevant specification. Polyester resin BS 3532, fiberglass - BS 3496

ROOF : GRP roof thickness would be build up using layers of fiberglass chopped strand mat.300 gm /m2 and 450 gm/m2 E-glass impregnated with orthophthalic polyester laminating resins.

PILLARS : 75mm diameter GI pipes are used as our standrand pillars. But 100MM diameters pillars are available upon request. The height of the pillar depends upon the site condition & location. All pillars would be primed and painted with alkyd based enamel paint. Epoxy paint is available upon request. GI nuts, bolts & washer used for fixing shall be of M-10 x 40 mm.

FOUNDATION : Cement concrete footing of size 40x40x50 mm provided for foundation.

BASE PLATE : 200 x 200 mm size mild steel plate of 8 mm thick used as base plate.

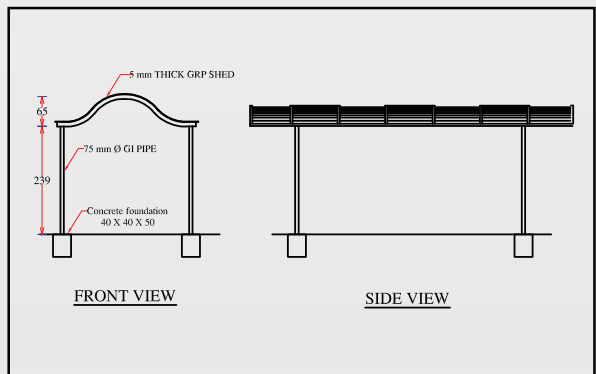
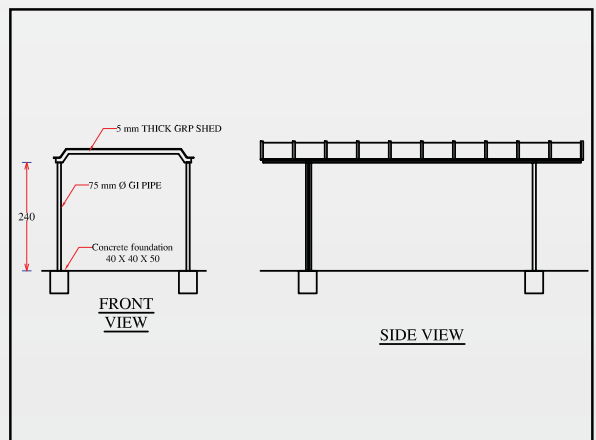
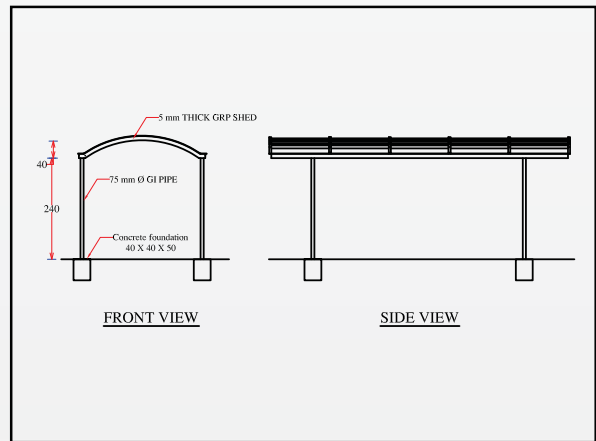
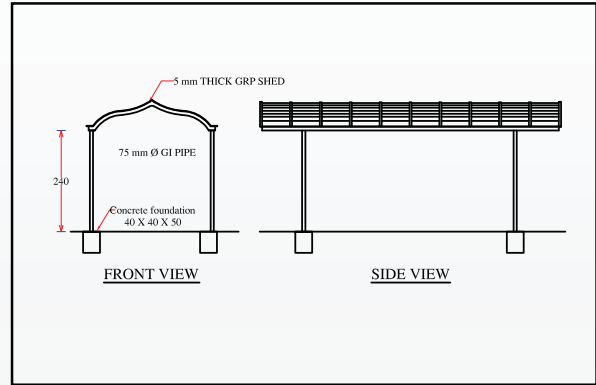



Pot



Pile Cap



Meter Box



Telephone Hood

MFG - GRP CUPOLA



Dome



Tile Roofing



Cap



Waste Collection Box



Waste Bin



Canopy



Fountain



Security Cabin



Toblerone



GRP Pattern



GRP Mold Civil Defence



Corniche



GRP Flower Pot



Pallet



GRP Fascia Mould



GRP Toilet



Counter

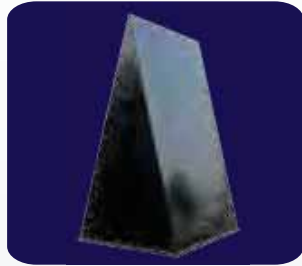

Toblerone



Door



AC Tray with Cover

MFG - GRP DOME & CRESCENTS

MFG - GRP CUPOLA



Wudhu Seat



Shower Tray



Bath Tub



Access Cover

MFG - GRP CORRUGATED, PLAIN & PROFILE SHEETS



Cupola



Waste Bin



Canopy



TV Frame



GRC Arch Panel



GRP Mode



Corner Tile



Compound Wall



Flower Pot



Security Cabin



Access Door



GRC Pattern

Location Map

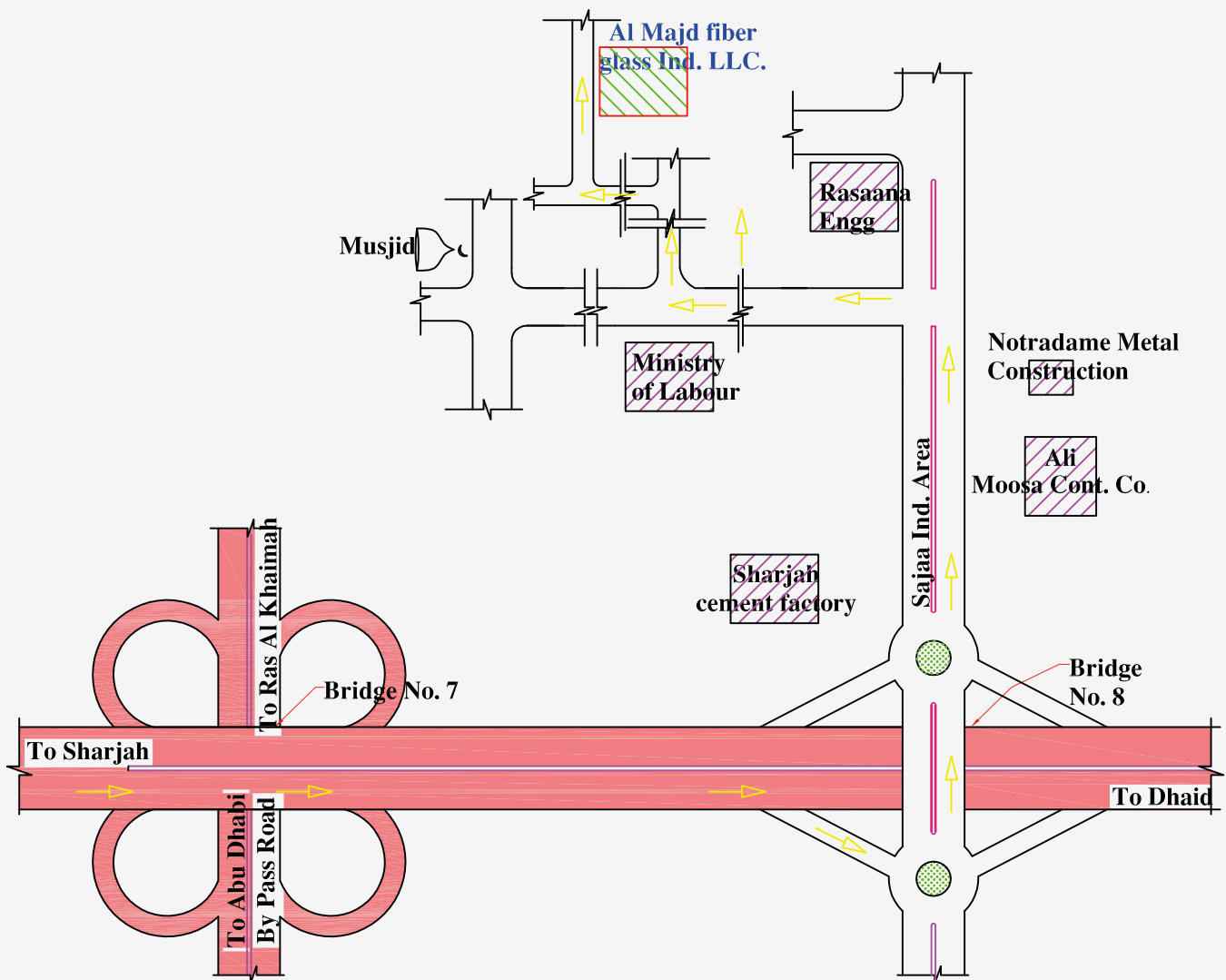

Al Majd
GROUP

Al Majd Fiber Glass Industry LLC
Majestic Electromech. cont.
Aejaz Foodstuff trading

Tel : +971 6 7496116, Fax : +971 6 7496117, PO Box: 43887 Sharjah-UAE
Email: almajdshj@gmail.com, almajdllc@gmail.com, majelectro@gmail.com
www.almajdfiberglass.com



Al Majd

GROUP

Al Majd Fiber Glass Industry LLC
Majestic Electromech.cont.
Aejaz Foodstuff Treading

Tel : +971 6 7496116, Fax : +971 6 7496117, PO Box: 43887 Sharjah-UAE
Email: almajdshj@gmail.com, majelectro@gmail.com
www.almajdfiberglass.com